

Electrical Equipment - Motor Systems for Secop Compressors

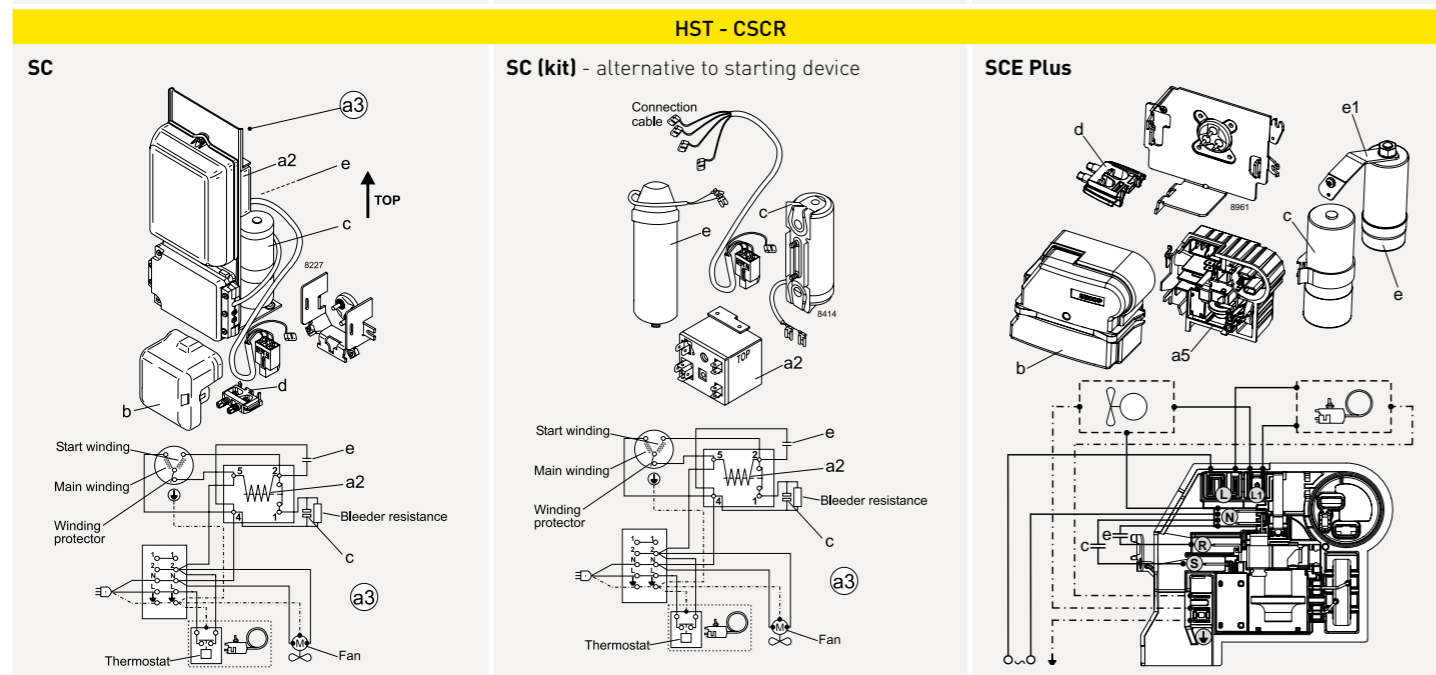
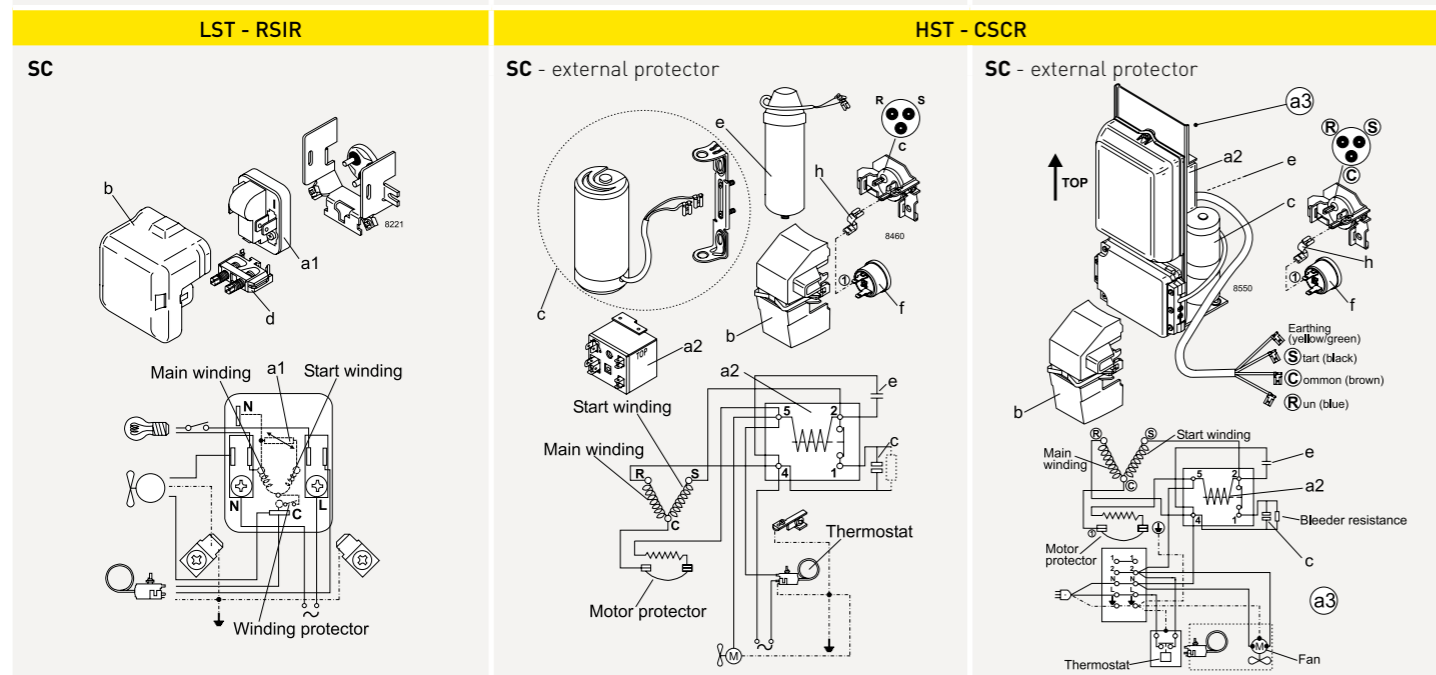
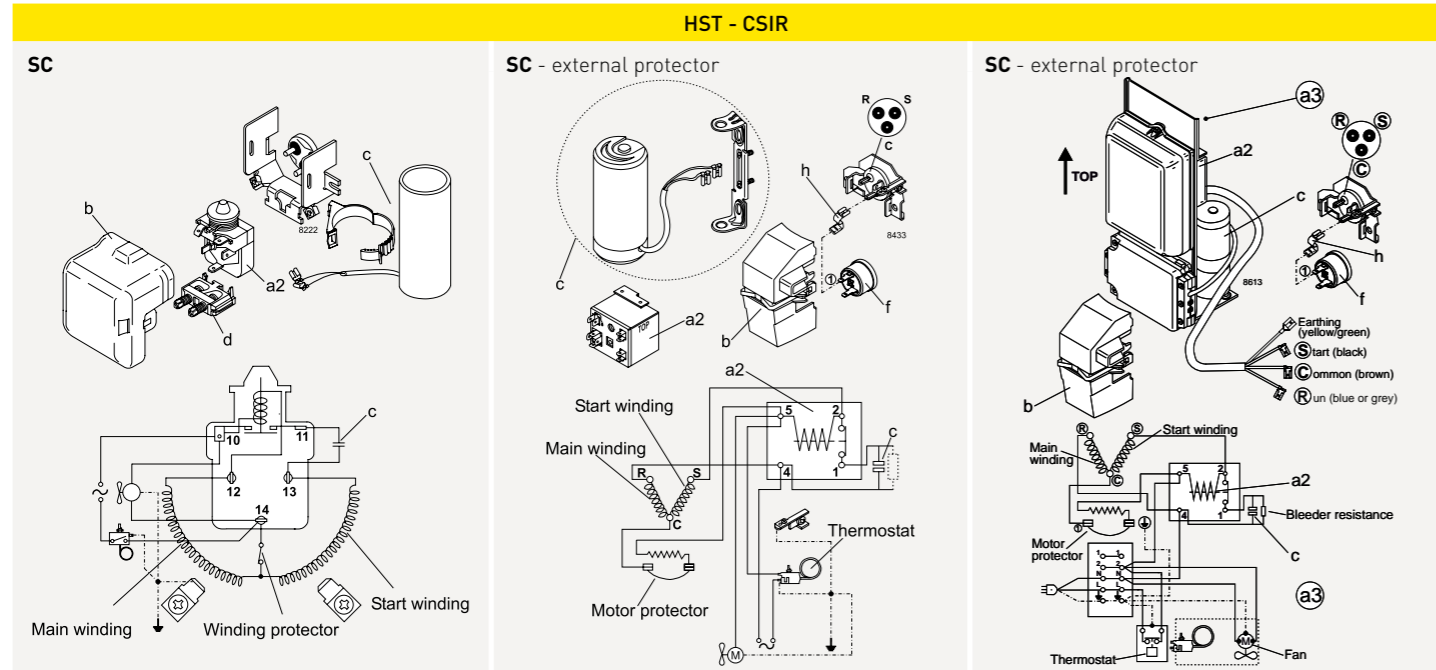

Mounting Accessories

Mounting	Code number	Bolt / pin dimension	Comp. base hole	Type of packaging	Compressor series	Parts list
Bolt joint	118-1917	M6 metric	16 mm	Single pack for one compressor	P- / T- / K- / KL- / N- / S-Series	I
Bolt joint	118-1918	M6 metric	16 mm	Industrial pack in any quantity	P- / T- / K- / KL- / N- / S-Series	I
Bolt joint	107B9150	M8 metric	19 mm	Single pack for one compressor	G-Series	II
Bolt joint	118-1946	1/4 inch	16 mm	Single pack for one compressor	P- / T- / KL- / N- / S-Series	III
Bolt joint	118-1949	1/4 inch	19 mm	Single pack for one compressor	all with 19 mm base holes (except G-Series)	IV
Snap-on	118-1947	Ø 7.3 mm	16 mm	Single pack for one compressor	P- / T- / KL- / N- / S-Series	V
Snap-on	118-1919	Ø 7.3 mm	16 mm	Industrial pack in any quantity	P- / T- / KL- / N- / S-Series	V

Parts list (4 pcs. per compressor needed)

Symbol drawings	Parts list
I	Sleeve Ø 8 mm x 6.4 mm x 0.8 mm
	Washer Ø 20 mm x Ø 6.7 mm x 1 mm
	Bolt M6 x 25 mm
	Nut M6
	Rubber grommet 16 mm
II	Sleeve Ø 11 mm x 8.6 mm x 1.2 mm
	Washer Ø 20 mm x Ø 8.8 mm x 1.2 mm
	Bolt M8 x 40 mm
	Nut M8
	Rubber grommet 19 mm
III	Sleeve Ø 8.3 mm x 6.7 mm x 0.8 mm
	Washer Ø 20 mm x Ø 6.7 mm x 1 mm
	Bolt 1/4 x 1 inch, 20 UNC
	Nut 1/4 inch, 20 UNC
	Rubber grommet 16 mm
IV	Sleeve Ø 9.5 mm x 7.9 mm x 0.8 mm
	Washer Ø 20 mm x Ø 6.7 mm x 1 mm
	Bolt 1/4 x 1 1/4 inch, 20 UNC
	Nut 1/4 inch, 20 UNC
	Rubber grommet 19 mm
V	Steel pin
	Washer Ø 21 x Ø 8.1 mm x 0.9 mm
	Clip

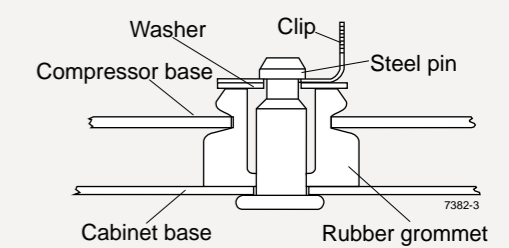
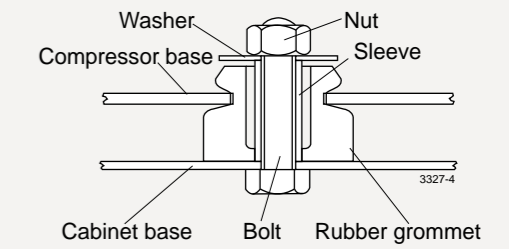

K-Series - evaporation tray

PTC protection screen

Flammable refrigerants R600a and R290

R600a (isobutane) and R290 (propane) are hydrocarbons. Hydrocarbon refrigerants are flammable and are only allowed for use in appliances that meet the requirements set out in the latest revision of EN/IEC 60335-2-34.

Do not use the refrigerants R600a or R290 near an open fire. The refrigeration systems must be opened with a tube cutter.

To properly perform maintenance and repair work on R600a or R290 systems, service staff must be properly trained in handling flammable refrigerants.

This includes knowledge of tools, transportation of the compressor and refrigerant, and the relevant regulations and safety precautions when carrying out service and repair work.

Secop compressors that use flammable refrigerants R600a and R290 are equipped with a yellow warning label as shown.

Note (HKK, HMK, HTK, HXK, HZK, and KLF compressors excluded):
To fulfil the requirements of EN 60335-2-34 the protection screen 103N0476 must be applied to the PTC starting device.

HERMETIC COMPRESSORS HFC REFRIGERANTS



International System of Units

R134a · R513A
R404A · R452A

208–230 V · 60 Hz

220–240 V · 50/60 Hz

220–240 V · 50 Hz

200–240 V · 50 Hz

Compressor [*with oil cooler connector]	Code number	Application	ASHRAE Capacity [W] Tc=54.4°C, Tliq=32.2°C, Tsuc=32.2°C Evaporating temperature [°C]						ASHRAE						Displacement [cm³]	Voltage and frequencies [*dual frequency type with 50/60 Hz]	Compressor cooling cooling (refer to data sheet)
			LBP rating point -23.3°C / 54.4°C		MBP rating point -6.7°C / 54.4°C		HBP rating point 7.2°C / 54.4°C		Cooling capacity [W]	COP [W/W]	Cooling capacity [W]	COP [W/W]	Cooling capacity [W]	COP [W/W]			
			-35	-15	-5	0	10	15									
PL20F	101G0100	MBP	-	45	81	103	-	24	0.55	66	1.08	-	-	1.41	198-254 V, 50 Hz	S	
PL35F	101G0202	MBP	-	75	125	156	-	45	0.86	103	1.34	-	-	2.00	198-254 V, 50 Hz	S	
PL50F	101G0220	LBP	18	92	-	-	-	56	0.89	-	-	-	-	2.50	198-254 V, 50 Hz	S	
PL50F	101G0222	MBP	-	92	149	184	-	56	0.92	123	1.37	-	-	2.50	198-254 V, 50 Hz	F1	
PL50F	101G0223	MBP	-	92	149	184	-	56	0.92	123	1.37	-	-	2.50	198-254 V, 50 Hz	F1	
TL2.5F	102G4200	L/MBP	-	81	136	170	-	46	0.80	112	1.31	-	-	2.61	198-254 V, 50 Hz	S	
TL3F	102G4300	L/MBP	-	101	171	214	-	59	0.85	141	1.32	-	-	3.13	198-254 V, 50 Hz	S	
TL4F	102G4400	LBP	38	133	-	-	-	84	0.98	-	-	-	-	3.86	198-254 V, 50 Hz	S	
TL5F	102G4501	LBP	53	178	-	-	-	113	1.06	-	-	-	-	5.08	198-254 V, 50 Hz	S	
TLS5F	102G4520	LBP	59	210	-	-	-	134	1.15	-	-	-	-	5.08	198-254 V, 50 Hz	S	
TLS6F	102G4620	LBP	72	227	-	-	-	143	1.14	-	-	-	-	5.70	198-254 V, 50 Hz	S	
TLS7F	102G4720	LBP	82	257	-	-	-	164	1.15	-	-	-	-	6.49	198-254 V, 50 Hz	S	
TLES3F	102G4310	L/MBP	-	115	192	240	-	70	1.07	158	1.57	-	-	3.13	198-254 V, 50 Hz	S	
TLES4F	102G4410	LBP	41	154	-	-	-	97	1.16	-	-	-	-	3.86	198-254 V, 50 Hz	S	
TLES5F	102G4510	LBP	62	210	-	-	-	134	1.22	-	-	-	-	5.08	198-254 V, 50 Hz	S	
TLES6F	102G4610	LBP	72	227	-	-	-	143	1.20	-	-	-	-	5.70	198-254 V, 50 Hz	S	
TLES5.7FT.3	102G4573	LBP	82	248	-	-	-	163	1.30	-	-	-	-	5.70	187-254 V, 50 Hz	S	
TLES6FT.3	102G4609	LBP	82	248	-	-	-	163	1.30	-	-	-	-	5.70	187-254 V, 50 Hz	S	
TFS4.5FT	102G4433	LBP	56	193	309	-	-	123	1.12	256	1.65	-	-	4.63	176-242 V, 50 Hz	S	
TLS3FT	102G4325	LBP	26	115	-	-	-	69	1.07	-	-	-	-	3.13	187-254 V, 50 Hz	S	
TLS4FT	102G4424	LBP	34	145	-	-	-	88	0.97	-	-	-	-	3.86	187-254 V, 50 Hz	S	
TLS5FT	102G4524	LBP	59	210	-	-	-	134	1.12	-	-	-	-	5.08	187-254 V, 50 Hz	S	
NL6F	105G6606	LBP	64	247	-	-	-	152	1.22	-	-	-	-	6.13	198-254 V, 50 Hz	S	
NL7F	105G6706	LBP	87	294	-	-	-	187	1.21	-	-	-	-	7.27	198-254 V, 50 Hz	S	
NL8F	105G6822	LBP	100	307	-	-	-	201	1.24	-	-	-	-	7.95	198-254 V, 50 Hz	S	
NL9F	105G6802	LBP	92	332	-	-	-	213	1.21	-	-	-	-	8.35	198-254 V, 50 Hz	S	
NLE9F	105G6805	LBP	101	335	-	-	-	211	1.33	-	-	-	-	8.35	198-254 V, 50 Hz	S	
NL11F	105G6900	LBP	126	435	-	-	-	274	1.22	-	-	-	-	11.15	198-254 V, 50 Hz	F2	
NF9FX	105G6841	L/MBP	113	356	575	715	-	229	1.09	475	1.59	856	2.28	8.34	198-242 V, 50 Hz	F1	
NF11FX	105G6944	L/MBP	141	454	725	898	-	294	0.97	600	1.41	1070	2.02	11.15	198-242 V, 50 Hz	F2	
NL6.1FT	105G6621	LBP	74	245	-	-	-	157	1.21	-	-	-	-	6.13	187-254 V, 50 Hz	S	
NL7FT	105G6718	LBP	88	290	-	-	-	186	1.22	-	-	-	-	7.27	187-254 V, 50 Hz	S	
NL7.3FT	105G6726	LBP	88	290	-	-	-	186	1.22	-	-	-	-	7.27	187-254 V, 50 Hz	S	
NL8.4FT	105G6055	LBP	107	340	-	-	-	220	1.23	-	-	-	-	8.35	187-254 V, 50 Hz	F1	
NL9FT	105G6828	LBP	107	340	-	-	-	220	1.23	-	-	-	-	8.35	187-254 V, 50 Hz	S	
NL10FT	105G6188	LBP	141	434	-	-	-	284	1.25	-	-	-	-	10.09	187-254 V, 50 Hz	S	
NL11MF	105G6156	M/HBP	-	471	756	938	1400	1687	-	626	1.61	1121	2.19	11.15	187-254 V, 50 Hz	F2	
NLE10MF	105G6888	MBP	110	425	687	854	-	268	1.28	568	1.71	1023	2.32	10.09	198-254 V, 50 Hz	F1	
NLE10MF.2	105G6187	L/MBP	116	457	735	914	1372	-	290	1.45	608	1.94	1097	2.61	10.09	198-254 V, 50 Hz	F2
NLE11MF.2	105G6197	MBP	-	513	821	1018	1509	-	331	1.41	680	1.88	1211	2.50	11.15	198-242 V, 50 Hz	F2
SC15F	104G8500	LBP	126	545	901	-	-	324	1.11	745	1.59	-	-	15.28	198-254 V, 50 Hz	F1	
SC15MFX	104G8501	MBP	-	569	951	1185	1749	-	326	1.10	785	1.66	1408	2.31	15.28	198-254 V, 50 Hz	F2
SC18F	104G8800	LBP	159	640	1041	-	-	389	1.17	863	1.62	-	-	17.69	198-254 V, 50 Hz	F1	
SC10GHH*	104G8071	HBP	-	321	580	750	1173	1426	-	472	1.69	931	2.62	10.29	198-254 V, 50 Hz	F1	
SC15GHH*	104G8571	HBP	-	533	897	1128	1746	2154	-	739	1.84	1382	2.66	15.28	198-254 V, 50 Hz	F1	
SC18GH	104G8860	HBP	-	666	1061	1338	2048	2482	-	875	1.62	1632	2.27	17.69	198-254 V, 50 Hz	F2	
SC21F	104G8100	LBP	228	742	1218	-	-	458	1.14	1007	1.54	-	-	20.95	198-254 V, 50 Hz	F1	
SC21FTX	104G8105	LBP	241	884	1391	-	-	569	1.27	1156	1.76	-	-	20.95	187-254 V, 50 Hz	F2	
SC21MFX	104G8120	MBP	-	819	1304	1616	2408	-	532	1.21	1081	1.65	1929	2.30	20.95	187-254 V, 50 Hz	F2
SCE21MFX	104G8150	MBP	-	817	1371	1714	-	480	1.29	1130	1.82	2043	2.37	20.95	198-244 V, 50 Hz	F2	
SC12/12G	104G8280	L/M/HBP	162	865	1498	1907	2942	3582	497	1.03	1228	1.60	2340	2.29	25.74	187-254 V, 50 Hz	F2
SC15/15G	104G8580	L/M/HBP	-	1054	1808	2255	3338	3996	521	1.01	1491	1.56	2682	2.20	30.56	187-254 V, 50 Hz	F2
SC18/18G	104G8880	L/M/HBP	-	1298	2150	2688	4026	4843	782	1.12	1774	1.63	3225	2.24	35.38	187-254 V, 50 Hz	F2
SC21/21G	104G8180	L/M/HBP	-	1508	2520	3156	4704	5621	921	1.13	2076	1.67	3777	2.29	41.90	187-254 V, 50 Hz	F2
GS26GHX	107B0702	HBP	-	1087	1746	2172	3268	3960	-	-	1445	1.79	2611	2.50	26.30	198-254 V, 50 Hz	F2
GS26MFX	107B0700	MBP	-	1078	1747	2170	-	-	-	-	1446	1.82	-	-	26.30	198-254 V, 50 Hz	F2
GS34MFX	107B0701	MBP	-	1400	2284	2848	-	-	-	-	1888	1.80	3424	2.44	33.80	198-254 V, 50 Hz	F2

Note: T-Series compressors will be phased out in 2025

Alternative refrigerant R513A, please refer to our data sheets



Dimensions						LST (RSIR & RSCR) refer to data sheet for more info					Run capacitor (RC)		HST (CSIR & CSCR) *alt. cable lengths avail.			LST/HST			
Height [mm]		Connectors location/I.D. [mm]				alt. connectors available	PTC starting device		PTC starting device with RC connector		ePTC	→ optional → compulsory*		Starting relay	Starting capacitor	Starting device*	Cord relief	Cover	
A	B	Suction C (I.D.)	Process D (I.D.)	Dis-charge E (I.D.)	Spades		Spades		Spades	Spades		Spades		Spades					
		6.3 mm	4.8 mm	6.3 mm	4.8 mm		4.8 mm	6.3 mm	4.8 mm	6.3 mm	6.3 mm	6.3 mm							
130	128	6.2	6.2	5	-	103N0011	103N0018	-	-	-	-	-	-	-	-	103N1010	103N0491		
134	132	6.2	6.2	5	-	103N0011	103N0018	-	-	-	-	-	-	-	-	103N1010	103N0491		
137	135	6.2	6.2	5	-	103N0011	103N0018	-	-	-	-	-	-	-	-	103N1010	103N0491		
137	135	6.2	6.2	5	-	-	-	-	-	-	-	-	117U6021	117U5014	-	103N1010	103N0491		
137	135	6.5	6.5	5	-	-	-	-	-	-	-	-	117U6021	117U5014	-	103N1010	103N0491		
163	159	6.2	6.2	5	X	103N0011	103N0018	-	-	-	-	-	-	-	-	103N1010	103N2010		
163	159	6.2	6.2	5	-	103N0011	103N0018	-	-	-	-	-	-	-	-	103N1010	103N2010		
163	159	6.2	6.2	5	-	103N0011	103N0018	-	-	-	-	-	-	-	-	103N1010	103N2010		
173	169	6.2	6.2	5	-	103N0011	103N0018	-	-	-	-	-	-	-	-	103N1010	103N2010		
173	169	6.2	6.2	5	-	103N0011	103N0018	-	-	-	-	-	-	-	-	103N1010	103N2010		
173	169	6.2	6.2	5	-	103N0011	103N0018	-	-	-	-	-	-	-	-	103N1010	103N2010		
173	169	6.2	6.2	5	-	103N0011	103N0018	103N0016	103N0021	-	-	117-7117	117-7119	117U6000	117U5014	-	103N1010	103N2010	
173	169	6.2	6.2	5	-	103N0011	103N0018	103N0016	103N0021	-	-	117-7117	117-7119	-	-	-	103N1010	103N2010	
173	169	6.2	6.2	5	-	103N0011	103N0018	103N0016	103N0021	-	-	117-7117	117-7119	-	-	-	103N1010	103N2010	
173	169	6.2	6.2	5	X	103N0011	103N0018	103N0016	103N0021	-	-	117-7117	117-7119	-	-	-	103N1010	103N2010	
173	169	6.2	6.2	5	X	103N0011	103N0018	103N0016	103N0021	103N0050	-	-	117-7117	117-7119	117U6004	117U5014	-	103N1010	103N2010
173	169	6.2	6.2	5	-	103N0011	103N0018	103N0016	103N0021	103N0050	-	-	117-7117	117-7119	117U6004	117U5014	-	103N1010	103N2010
173	169	6.5	6.5	5	X	-	-	-	-	-	-	-	-	-	-	-	117U0349	117U1023	
173	169	6.2	6.2	5	X	103N0011	103N0018	-	-	-									

R134a · 220-240 V · 50/60 Hz | 208-230 V · 60 Hz

Compressor	Code number	Application	ASHRAE Capacity [W] Tc=54.4°C, Tliq=32.2°C, Tsuc=32.2°C Evaporating temperature [°C]							ASHRAE						Displacement [cm ³]	Voltage and frequencies [*dual frequency type with 50/60 Hz]	Compressor cooling cooling (refer to data sheet)
			LBP rating point -23.3°C / 54.4°C		MBP rating point -6.7°C / 54.4°C		HBP rating point 7.2°C / 54.4°C			Cooling capacity [W]	COP [W/W]	Cooling capacity [W]	COP [W/W]	Cooling capacity [W]	COP [W/W]			
			-35	-15	-5	0	10	15										
			Evaporating temperature [°C]															
PL35G	101G0250	L/M/HBP	-	66	111	140	214	261	39	0.79	91	1.27	170	1.83	2.00	198-254 V, 50 Hz *	F1	
TL2.5G	102G4251	L/M/HBP	14	86	144	181	273	331	51	0.82	119	1.32	218	1.86	2.61	187-254 V, 50 Hz *	S	
TL3G	102G4350	L/M/HBP	-	100	169	212	322	390	58	0.85	139	1.34	257	1.86	3.13	187-254 V, 50 Hz *	S	
TL4G	102G4452	L/M/HBP	-	133	223	280	425	515	81	0.94	184	1.46	340	2.15	3.86	187-254 V, 50 Hz *	S	
TL4GH	102G4455	HBP	-	130	226	286	440	535	-	-	185	1.44	350	2.14	3.86	198-254 V, 50 Hz *	F2	
TL5G	102G4550	L/M/HBP	-	173	278	345	515	619	109	1.03	230	1.43	412	1.94	5.08	187-254 V, 50 Hz *	S	
TLES6.5FT.3	102G4724	LBP	89	283	-	-	-	-	183	1.33	-	-	-	-	6.49	187-254 V, 50 Hz *	S	
TLES7FT.4	102G4708	LBP	89	283	-	-	-	-	183	1.33	-	-	-	-	6.49	187-254 V, 50 Hz *	S	
KLE4.0GFTX	106G5403	L/M/HBP	44	164	268	333	496	595	102	1.14	221	1.77	398	2.58	4.00	187-254 V, 50 Hz *	S	
KLE4.8GFTX	106G5503	L/M/HBP	61	207	338	421	625	749	130	1.26	279	1.88	502	2.71	4.80	187-254 V, 50 Hz *	F2	
KLE5.6GFTX	106G5603	L/M/HBP	78	249	405	504	748	896	157	1.32	335	1.92	601	2.74	5.60	187-254 V, 50 Hz *	F2	
KLE6.6GFTX	106G5703	L/M/HBP	94	299	484	602	891	1066	189	1.29	401	1.85	716	2.59	6.60	187-254 V, 50 Hz *	F2	
KLE7.7GFTX	106G5803	L/M/HBP	108	344	545	671	982	1170	222	1.33	452	1.81	791	2.41	7.70	187-254 V, 50 Hz *	F2	
KLE8.6GFTX	106G5903	L/M/HBP	120	390	623	767	1116	1323	249	1.33	517	1.78	901	2.31	8.60	187-254 V, 50 Hz *	F2	
KLF6.6MFT	106G2701	MBP	-	298	485	603	-	-	187	1.35	401	1.92	-	-	6.60	170-254 V, 50 Hz *	F2	
KLF7.7MFT	106G2802	MBP	-	348	556	686	-	-	221	1.38	461	1.89	-	-	7.70	170-254 V, 50 Hz *	F2	
NL6FT	105G6628	LBP	74	245	-	-	-	-	157	1.21	-	-	-	-	6.13	187-254 V, 50 Hz *	S	
NF7FX	105G6743	L/MBP	97	324	522	646	-	-	205	1.12	432	1.66	766	2.35	7.27	198-242 V, 50 Hz *	S	
NF10FX	105G6846	L/MBP	127	418	671	832	-	-	267	0.94	556	1.42	991	2.06	10.09	198-242 V, 50 Hz *	F1	
NL6.1MF	105G6660	MBP	-	234	388	485	732	885	-	-	320	1.61	585	2.33	6.13	187-254 V, 50 Hz *	S	
NL7.3MF	105G6772	MBP	-	293	477	596	895	1081	-	-	394	1.64	716	2.32	7.27	187-254 V, 50 Hz *	F1	
NL8.4MF	105G7802	MBP	-	343	551	686	1028	1240	-	-	456	1.64	822	2.27	8.35	187-254 V, 50 Hz *	F1	
NL10MF	105G6885	MBP	-	428	687	853	1273	1534	-	-	569	1.64	1019	2.27	10.09	187-254 V, 50 Hz *	F1	
NLE12.6MF.2	105G6387	L/MBP	241	545	895	1120	1671	-	355	1.48	738	1.98	1341	2.66	12.55	198-254 V, 50 Hz *	F2	
NLE12.6MFT	105G6388	L/MBP	241	545	895	1120	1671	-	355	1.48	738	1.98	1341	2.66	12.55	187-254 V, 50 Hz *	F2	
FRK5G	106G5453	L/M/HBP	43	162	265	330	491	589	101	1.12	219	1.73	394	2.53	4.00	187-254 V, 50 Hz *	S	
FRK6G	106G5553	L/M/HBP	60	205	335	417	619	742	129	1.24	277	1.84	497	2.66	4.80	187-254 V, 50 Hz *	F2	
FRK7.5G	106G5653	L/M/HBP	77	246	401	499	741	887	155	1.30	332	1.88	595	2.68	5.60	187-254 V, 50 Hz *	F2	
FRK8.5G	106G5753	L/M/HBP	93	296	480	596	882	1055	187	1.27	397	1.81	709	2.53	6.60	187-254 V, 50 Hz *	F2	
FRK10G	106G5853	L/M/HBP	107	340	539	664	972	1158	220	1.30	448	1.78	783	2.36	7.70	187-254 V, 50 Hz *	F2	
FRK11G	106G5953	L/M/HBP	119	386	616	759	1105	1310	246	1.30	511	1.75	892	2.27	8.60	187-254 V, 50 Hz *	F2	
SC10G	104G8000	L/M/HBP	30	333	603	766	1149	1368	168	0.87	493	1.59	923	2.35	10.29	187-254 V, 50 Hz *	F2	
SC10GH	104G8041	HBP	-	289	592	761	1156	1392	-	-	481	1.56	925	2.28	10.29	198-254 V, 50 Hz *	F2	
SC12FT	104G8205	LBP	129	506	802	-	-	-	321	1.15	666	1.64	-	-	12.87	187-254 V, 50 Hz *	F1	
SC15FT	104G8508	LBP	157	606	958	-	-	-	386	1.18	796	1.65	-	-	15.28	187-254 V, 50 Hz *	F2	
SC12G	104G8240	L/M/HBP	81	433	749	954	1471	1791	248	1.03	614	1.60	1170	2.29	12.87	187-254 V, 50 Hz *	F2	
SC12G	104G8245	MBP	-	461	865	1128	1805	-	-	-	702	1.65	1422	2.45	12.87	187-254 V, 60 Hz	F2	
SC12GH	104G8261	HBP	-	377	718	936	1489	1835	-	-	583	1.51	1175	2.34	12.87	198-254 V, 50 Hz *	F2	
SC15G	104G8520	L/M/HBP	-	527	904	1127	1669	1998	260	1.01	745	1.56	1341	2.20	15.28	187-254 V, 50 Hz *	F2	
SC15G	104G8526	MBP	-	583	1035	1303	1953	-	-	-	850	1.67	1565	2.38	15.28	187-254 V, 60 Hz	F2	
SC15GH	104G8561	HBP	-	377	718	936	1489	1835	-	-	583	1.51	1175	2.34	12.87	198-254 V, 50 Hz *	F2	
SC18FTX	104G8805	LBP	181	703	1113	-	-	-	448	1.17	924	1.68	-	-	17.69	187-254 V, 50 Hz *	F2	
SC18G	104G8820	L/M/HBP	-	658	1081	1348	2011	2417	397	1.13	893	1.58	1612	2.21	17.69	187-254 V, 50 Hz *	F2	
SC18G	104G8823	MBP	-	711	1186	1500	2315	-	-	-	976	1.76	1838	2.51	17.69	187-254 V, 60 Hz	F2	
SC18GH	104G8861	HBP	-	602	1025	1302	2015	2465	-	-	841	1.74	1599	2.57	17.69	198-254 V, 50 Hz *	F2	
SC18MFX	104G8804	MBP	-	685	1107	1380	2076	-	434	1.15	916	1.63	1660	2.28	17.69	187-254 V, 50 Hz *	F2	
SC21FTX	104G8106	LBP	298	990	1563	-	-	-	641	1.29	1298	1.69	-	-	20.95	187-254 V, 60 Hz	F2	
SC21G	104G8140	L/M/HBP	-	755	1261	1579	2352	2810	461	1.23	1039	1.68	1889	2.40	20.95	187-254 V, 50 Hz *	F2	

Note: T-Series compressors will be phased out in 2025

Electrical Equipment

Dimensions							LST (RSIR & RSCR) refer to data sheet for more info					Run capacitor (RC)		HST (CSIR & CSCR) *alt. cable lengths avail.			LST/HST				
Height [mm]		Connectors location/I.D. [mm]					alt. connectors available	PTC starting device		PTC starting device with RC connector		ePTC	→ optional → compulsory*		Starting relay		Starting capacitor		Starting device*	Cord relief	Cover
A	B	Suction		Process		Dis-charge		Spades		Spades		Spades	Spades		Spades		Spades				
		C (I.D.)	D (I.D.)	E (I.D.)		6.3 mm		4.8 mm	6.3 mm	4.8 mm	4.8 mm	6.3 mm	4.8 mm	6.3 mm	6.3 mm	6.3 mm					
137	135	6.2	6.2	5	X	103N0011	103N0018	-	-	-	-	-	-	117U6021	117U5014	-	103N1010	103N0491			
163	159	6.2	6.2	5	X	103N0011	103N0018	-	-	-	-	-	-	117U6007	117U5014	-	103N1010	103N2011			
163	159	6.2	6.2	5	X	103N0011	103N0018	-	-	-	-	-	-	117U6009	117U5014	-	103N1010	103N2010			
173	169	6.2	6.2	5	X	103N0011	103N0018	-	-	-	-	-	-	117U6004	117U5014	-	103N1010	103N2010			
173	169	6.2	6.2	5	-	-	-	-	-	-	-	-	-	117U6000	117U5014	-	103N1010	103N2011			
173	169	6.2	6.2	5	X	103N0011	103N0018	-	-	-	-	-	-	117U6000	117U5014	-	103N1010	103N2010			
173	169	6.2	6.2	5	X	103N0011	103N0018	103N0016	103N0021	-	-	-	-	117-7117	117-7119	117U6016	117U5014	-	103N1010	103N2010	
173	169	6.5	6.5	5	-	103N0011	103N0018	103N0016	103N0021	-	-	-	-	117-7117	117-7119	117U6016	117U5014	-	103N1010	103N2010	
182	175	6.2	6.2	5.2	-	-	-	-	-	-	-	-	-	117U7073	117U5001	-	16058100	10636401			
182	175	8.2	6.2	6.2	-	-	-	-	-	-	-	-	-	117U7073	117U5001	-	16058100	10636401			
182	175	8.2	6.2	6.2	-	-	-	-	-	-	-	-	-	117U7070	117U5001	-	16058100	10636401			
182	175	8.2	6.2	6.2	-	-	-	-	-	-	-	-	-	117U7071	117U5001	-	16058100	10636401			
182	175	8.2	6.2	6.2	-	-	-	-	-	-	-	-	-	117U7071	117U5001	-	16058100	10636401			
182	175	8.2	6.2	6.2	-	-	-	-	-	-	-	-	-	117U7079	117U5001	-	16058100	10636401			
182	175	8.2	6.2	6.2	X	-	-	103N0250	103N0252	-	-	-	-	117-7191	117-7190	117U7071	117U5001	-	16058100	10636401	
182	175	8.2	6.2	6.2	X	-	-	103N0250	103N0252	-	-	-	-	117-7191	117-7190	117U7071	117U5001	-	16058100	10636401	
197	191	6.2	6.2	5	-	103N0011	103N0018	-	-	-	-	-	-	117U6000	117U5015	-	103N1010	103N2010			
203	197	8.2	6.5	6.5	X	-	-	-	-	-	-	-	-	117U4140	117U5018	-	117U0349	117U1023			
203	197	8.2	6.5	6.5	X	-	-	-	-	-	-	-	-	117U4139	117U5018	-	117U0349	117U1021			
190	184	8.2	6.2	6.2	X	103N0011	103N0018	-	-	-	-	-	-	117U6015	117U5015	-	103N1010	103N2011			
197	191	8.2	6.2	6.2	X	103N0011	103N0018	-	-	-	-	-	-	117U6016	117U5015	-	103N1010	103N2011			
197	191	8.2	6.2	6																	

K-Series AT · R134a · 200-240 V · 50 Hz

Compressor	Code number	Application	ASHRAE Capacity [W] Tc=54.4°C, Tliq=32.2°C, Tsuc=32.2°C Evaporating temperature [°C]						ASHRAE						Displacement [cm³]	Voltage and frequencies [*dual frequency type with 50/60 Hz]	Compressor cooling [refer to data sheet]		
			LBP rating point -23.3°C / 54.4°C		MBP rating point -6.7°C / 54.4°C		HBP rating point 7.2°C / 54.4°C		Cooling capacity		COP		Cooling capacity					COP	
			-35	-15	-5	0	10	15	[W]	[W/W]	[W]	[W/W]	[W]	[W/W]				[W]	[W/W]
			Cooling capacity [W]		COP [W/W]		Cooling capacity [W]		COP [W/W]		Cooling capacity [W]		COP [W/W]						
GTK55AT	CDO00153	LBP	69	261					170	1.55	-	-	-	-	5.60	170-264 V, 50 Hz	S		
GTK70AT	CDO00154	LBP	97	311					205	1.60	-	-	-	-	6.64	170-264 V, 50 Hz	S		
GTK80AT	CDO00155	LBP	107	352					232	1.60	-	-	-	-	7.70	170-264 V, 50 Hz	S		

Electrical Equipment · Spare Parts · Accessories

Dimensions						Run capacitor	Terminal board	Terminal board	Cable clamp	Cover	Evaporation tray	All-in-one equipment	
Height [mm]		Connectors location [mm]			alt. connectors available	→ optional → compulsory*	→ PTC → external protector	→ ePTC → external protector	screws not included	V0 material optional	plastic	→ cover → cable clamp + screws → earthing screw	
A	B	Suction C (I.D.)	Process D (O.D.)	Dis-charge E (I.D.)									
167	-	6.15	6.00	5.15	X	4 µF	ZCFC	DCFC	-	113410_	196364_	162991_	161680_
167	-	6.15	6.00	5.15	X	4 µF	ZCFP	DCFP	-	113410_	196364_	162991_	161680_
170	-	6.15	6.00	5.15	X	4 µF	ZCFP	DCFP	-	113410_	196364_	162991_	161680_



● Alternative refrigerant R513A, please refer to our data sheets

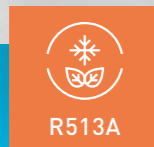

R404A/R507 · 220-240 V · 50 Hz

Compressor	Code number	Application	ASHRAE Capacity [W] Tc=54.4°C, Tliq=32.2°C, Tsuc=32.2°C Evaporating temperature [°C]						ASHRAE						Displacement [cm³]	Voltage and frequencies [*dual frequency type with 50/60 Hz]	Compressor cooling cooling (refer to data sheet)		
			LBP rating point -23.3°C / 54.4°C		MBP rating point -6.7°C / 54.4°C		HBP rating point 7.2°C / 54.4°C		Cooling capacity		COP		Cooling capacity					COP	
			-35	-15	-5	0	10	15	[W]	[W/W]	[W]	[W/W]	[W]	[W/W]				[W]	[W/W]
TL4CL	● 102U2071	LBP	75	240	390	-	-	-	152	1.03	310	1.39	-	-	3.86	198-254 V, 50 Hz	F2		
NL7CLX	● 105F3710	LBP	200	576	876	-	-	-	388	1.31	704	1.60	-	-	7.27	198-254 V, 50 Hz	F2		
NL8.4CLX	● 105F3800	LBP	218	627	953	-	-	-	422	1.28	765	1.54	-	-	8.35	198-254 V, 50 Hz	F2		
NL9CLX	105F3802	LBP	236	674	-	-	-	-	457	1.34	-	-	-	-	8.35	198-254 V, 50 Hz	F2		
SC10CL	● 104L2523	LBP	116	615	1014	-	-	-	366	1.10	811	1.43	-	-	10.29	198-254 V, 50 Hz	F2		
SC10DL	104L2525	M/HBP	-	644	1051	1300	1916	2295	-	-	837	1.51	1478	2.15	10.29	198-254 V, 50 Hz	F2		
SC12CL	● 104L2623	LBP	165	857	1397	-	-	-	516	1.10	1112	1.50	-	-	12.87	198-254 V, 50 Hz	F2		
SC12DL	104L2625	M/HBP	-	865	1407	1728	2508	2984	-	-	1122	1.57	1942	2.26	12.87	198-254 V, 50 Hz	F2		
SC15CL	● 104L2853	LBP	180	1101	1678	-	-	-	697	1.20	1349	1.50	-	-	15.28	198-254 V, 50 Hz	F2		
SC15CLX.2	104L2896	LBP	339	1097	-	-	-	-	724	1.18	-	-	-	-	15.28	198-254 V, 50 Hz	F2		
SC15DL	104L2856	M/HBP	-	1034	1641	2012	2928	3492	-	-	1311	1.56	2265	2.25	15.28	198-254 V, 50 Hz	F2		
SC15MLX	● 104L2869	MBP	-	1117	1718	2102	-	-	762	1.20	1375	1.56	2371	2.16	15.28	198-254 V, 50 Hz	F2		
SC18CL	● 104L2123	LBP	374	1220	1882	-	-	-	803	1.22	1508	1.50	-	-	17.69	198-254 V, 50 Hz	F2		
SC18CLX.2	104L2197	LBP	415	1343	-	-	-	-	886	1.20	-	-	-	-	17.69	198-254 V, 50 Hz	F2		
SC18MLX	104L2139	MBP	-	1306	2001	2446	-	-	894	1.27	1603	1.64	2757	2.27	17.69	198-254 V, 50 Hz	F2		
SC18MLX.3	● 104L2146	MBP	-	1384	2097	2552	-	-	959	1.34	1683	1.67	2862	2.28	17.68	198-254 V, 50 Hz	F2		
SC21CL	● 104L2322	LBP	442	1386	-	-	-	-	905	1.18	-	-	-	-	20.95	198-254 V, 50 Hz	F2		
SC10/10CL	104L4087	LBP	264	1327	2157	-	-	-	803	1.13	1717	1.45	-	-	20.58	198-254 V, 50 Hz	F2		
SC10/10DL	104L4091	M/HBP	-	1288	2103	2601	3832	4590	-	-	1674	1.51	2955	2.15	20.58	198-254 V, 50 Hz	F2		
SC12/12CL	104L4088	LBP	330	1715	2794	-	-	-	1032	1.10	2224	1.50	-	-	25.74	198-254 V, 50 Hz	F2		
SC12/12DL	104L4092	M/HBP	-	1730	2814	3456	5016	5967	-	-	2244	1.57	3885	2.26	25.74	198-254 V, 50 Hz	F2		
SC15/15CL	104L4089	LBP	360	2202	3356	-	-	-	1395	1.20	2699	1.50	-	-	30.56	198-254 V, 50 Hz	F2		
SC15/15DL	104L4093	M/HBP	-	2068	3282	4024	5856	6983	-	-	2622	1.56	4529	2.25	30.56	198-254 V, 50 Hz	F2		
SC18/18CL	104L4090	LBP	748	2440	3762	-	-	-	1606	1.22	3016	1.50	-	-	35.38	198-254 V, 50 Hz	F2		
SC18/18CLX.2	104L4035	LBP	823	2670	-	-	-	-	1761	1.20	-	-	-	-	35.36	198-254 V, 50 Hz	F2		
SC18/18MLX	104L4100	MBP	748	2440	3762	-	-	-	1606	1.22	3016	1.50	-	-	35.38	198-254 V, 50 Hz	F2		
SC21/21CL	● 104L4094	LBP	884	2773	-	-	-	-	1810	1.18	-	-	-	-	41.90	198-254 V, 50 Hz	F2		
GS21MLX	● 107B0502	MBP	-	1578	2486	3070	-	-	-	-	1984	1.79	3514	2.53	21.20	198-254 V, 50 Hz	F2		
GS26CLX	107B0500	LBP	614	2017	-	-	-	-	1323	1.35	-	-	-	-	26.30	198-254 V, 50 Hz	F2		
GS26MLX	● 107B0503	MBP	-	1925	2987	3643	-	-	1239	1.33	2392	1.72	4085	2.34	26.30	198-254 V, 50 Hz	F2		
GS34CLX	● 107B0501	LBP	943	2874	4412	-	-	-	1917	1.45	3537	1.74	-	-	33.80	198-254 V, 50 Hz	F2		
GS34MLX	● 107B0504	MBP	-	2766	4178	5053	-	-	-	-	3359	1.71	5626	2.25	33.80	198-254 V, 50 Hz	F2		

Note: T-Series compressors will be phased out in 2025

Electrical Equipment

Dimensions							LST (RSIR & RSCR) refer to data sheet for more info					Run capacitor (RC)		HST (CSIR & CSCR) *alt. cable lengths avail.			LST/HST		
Height (mm)		Connectors location/I.D. (mm)					alt. connectors available	PTC starting device		PTC starting device with RC connector		ePTC	→ optional → compulsory*		Starting relay	Starting capacitor	Starting device*	Cord relief	Cover
A	B	Suction		Process		Dis-charge		Spades		Spades		Spades	Spades		Spades	Spades	Spades	Cord relief	Cover
		C (I.D.)	D (I.D.)	E (I.D.)	6.3 mm	4.8 mm		6.3 mm	4.8 mm	4.8 mm	6.3 mm	4.8 mm	6.3 mm	6.3 mm	6.3 mm				
173	169	6.2	6.2	5	-	-	-	-	-	-	-	-	-	117U6000	117U5014	-	103N1010	103N2010	
203	197	8.2	6.2	6.2	X	-	-	-	-	-	-	-	-	117U6002	117U5015	-	103N1010	103N2010	
203	197	8.2	6.2	6.2	X	103N0011	103N0018	-	-	-	-	-	-	117U6003	117U5015	-	103N1010	103N2010	
203	197	8.2	6.2	6.2	-	-	-	-	-	-	-	-	-	117U6003	117U5015	-	103N1010	103N2010	
209	203	8.2	6.2	6.2	X	-	-	-	-	-	-	-	-	117U6003	117U5017	-	103N1004	103N2009	
209	203	8.2	6.2	6.2	X	-	-	-	-	-	-	-	-	117U6005	117U5017	-	103N1004	103N2009	
209	203	8.2	6.2	6.2	X	-	-	-	-	-	-	-	-	117U6005	117U5017	-	103N1004	103N2009	
219	213	10.2	6.2	6.2	X	-	-	-	-	-	-	-	-	117U6019	117U5017	-	103N1004	103N2009	
219	213	10.2	6.2	6.2	X	-	-	-	-	-	-	-	-	117U6019	117U5017	-	103N1004	103N2009	
219	213	10.2	6.2	6.2	X	-	-	-	-	-	-	-	-	117U6019	117U5017	-	103N1004	103N2009	
219	213	10.2	6.2	6.2	X	-	-	-	-	-	-	-	-	117U6019	117U5017	-	103N1004	103N2009	
219	213	10.2	6.2	6.2	X	-	-	-	-	-	-	-	-	117U6013	117U5012	-	103N1004	103N2009	
219	213	10.2	6.2	6.2	X	-	-	-	-	-	-	-	-	117U5373	117-7029	103N1004	103N2009		
219	213	10.2	6.2	6.2	X	-	-	-	-	-	-	-	-	117U5373	117-7027	103N1004	103N2009		
219	213	10.2	6.2	6.2	X	-	-	-	-	-	-	-	-	117U5373	117-7027	103N1004	103N2009		
219	213	10.2	6.2	6.2	X	-	-	-	-	-	-	-	-	117U5373	117-7027	103N1004	103N2009		
219	213	10.2	6.2	6.2	X	-	-	-	-	-	-	-	-	117U5373	117-7027	103N1004	103N2009		
249	244	12	6.2	6.2	-	-	-	-	-	-	-	-	-	117U6003	117U5017	-	103N1004	103N2009	
249	244	12	6.2	6.2	-	-	-	-	-	-	-	-	-	117U6005	117U5017	-	103N1004	103N2009	
249	244	12	6.2	6.2	-	-	-	-	-	-	-	-	-	117U6005	117U5017	-	103N1004	103N2009	
259	254	12	6.2	6.2	-	-	-	-	-	-	-	-	-	117U6019	117U5017	-	103N1004	103N2009	
259	254	12	6.2	6.2	X	-	-	-	-	-	-	-	-	117U6019	117U5017	-	103N1004	103N2009	
259	254	16	6.2	6.2	-	-	-	-	-	-	-	-	-	117U5373	117-7029	103N1004	103N2009		
259	254	16	6.2	6.2	-	-	-	-	-	-	-	-	-	117U5373	117-7027	103N1004	103N2009		
259	254	12	6.2	6.2	-	-	-	-	-	-	-	-	-	117U6013	117U5012	-	103N1004	103N2009	
259	254	10.2	6.2	6.2	-	-	-	-	-	-	-	-	-	117U5373	117-7027	103N1004	103N2009		
259	254	16	6.2	6.2	-	-	-	-	-	-	-	-	-	117U5373	117-7027	103N1004	103N2009		
259	247	16.1	6.5	9.7	-	-	-	-	-	-	-	-	-	117-7070	-	107B9101			
259	247	12.9	6.5	8.2	-	-	-	-	-	-	-	-	-	117-7056	-	107B9101			
279	267	16.1	6.5	9.7	-	-	-	-	-	-	-	-	-	117-7072	-	107B9101			
279	267	12.9	6.5	8.2	X	-	-	-	-	-	-	-	-	117-7074	-	107B9101			
279	267	16.1	6.5	9.7	-	-	-	-	-	-	-	-	-	117-7056	-	107B9101			

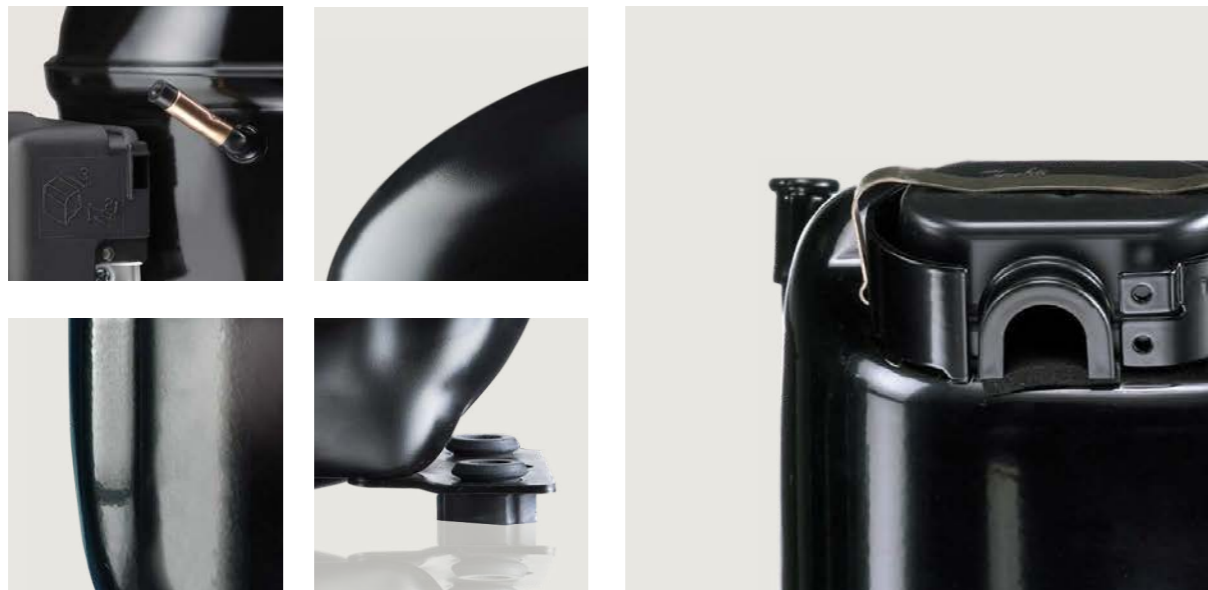

● Alternative refrigerant R452A, please refer to our data sheets

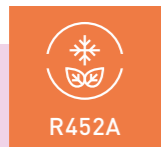

R404A/R507 · 220-240 V · 50/60 Hz | 208-230 V · 60 Hz

Compressor	Code number	Application	ASHRAE Capacity [W] Tc=54.4°C, Tliq=32.2°C, Tsuc=32.2°C Evaporating temperature [°C]						ASHRAE						Displacement [cm³]	Voltage and frequencies [*dual frequency type with 50/60 Hz]	Compressor cooling cooling (refer to data sheet)				
			LBP rating point -23.3°C / 54.4°C		MBP rating point -6.7°C / 54.4°C		HBP rating point 7.2°C / 54.4°C		Cooling capacity		COP		Cooling capacity					COP			
			-35	-15	-5	0	10	15	[W]	[W/W]	[W]	[W/W]	[W]	[W/W]				[W]	[W/W]	[W]	[W/W]
									[W]	[W/W]	[W]	[W/W]	[W]	[W/W]				[W]	[W/W]	[W]	[W/W]
NF7MLX	105F3720	MBP	-	547	851	1039	1503	-	-	682	1.49	1164	2.12	7.27	187-254 V, 50 Hz *	F2					
NL6.1MLX	105F3611	MBP	-	455	711	869	-	-	291	1.14	569	1.61	975	2.31	6.13	187-254 V, 50 Hz *	F2				
SC10CLX	104L2533	L/MBP	130	655	1064	-	-	-	396	1.11	847	1.51	-	-	10.29	198-254 V, 50 Hz *	F2				
SC10MLX	104L2506	MBP	-	722	1127	1380	-	-	-	-	902	1.54	1553	2.18	10.29	187-254 V, 50 Hz *	F2				
SC12CLX	104L2695	LBP	226	1097	-	-	-	-	698	1.23	-	-	-	-	12.87	198-254 V, 60 Hz	F2				
SC12CLX.2	104L2699	LBP	317	1085	-	-	-	-	707	1.27	-	-	-	-	12.87	187-254 V, 60 Hz	F2				
SC12CLX.2	104L2697	LBP	278	899	-	-	-	-	593	1.15	-	-	-	-	12.87	198-254 V, 50 Hz *	F2				
SC12MLX	104L2606	MBP	-	886	1369	1670	-	-	584	1.15	1096	1.56	1873	2.18	12.87	187-254 V, 50 Hz *	F2				
SC15CLX	104L2854	LBP	235	1213	-	-	-	-	774	1.23	-	-	-	-	15.28	198-254 V, 60 Hz	F2				
SC15CLX.2	104L2897	LBP	413	1337	-	-	-	-	882	1.33	-	-	-	-	15.28	187-254 V, 60 Hz	F2				
SC15MLX.2	104L2803	MBP	-	1233	1896	2320	-	-	841	1.20	1518	1.56	2617	2.16	15.28	187-254 V, 60 Hz	F2				
SC18CLX.2	104L2195	LBP	520	1554	-	-	-	-	1114	1.39	-	-	-	-	17.69	187-254 V, 60 Hz	F2				
SC18MLX	104L2138	MBP	-	1521	2328	2839	-	-	1033	1.18	1866	1.47	3186	1.99	17.69	187-254 V, 60 Hz	F2				
SC12/12CLX	104L4034	LBP	450	2182	-	-	-	-	1389	1.23	-	-	-	-	25.74	198-254 V, 60 Hz	F2				
GS21CLX	107B0506	LBP	584	1918	-	-	-	-	1258	1.35	-	-	-	-	21.20	187-254 V, 60 Hz	F2				
GS21MLX	107B0509	MBP	-	2043	3134	3819	-	-	1345	1.46	2513	1.86	4293	2.55	21.20	187-254 V, 60 Hz	F2				
GS26CLX	107B0505	LBP	719	2114	-	-	-	-	1425	1.21	-	-	-	-	26.30	187-254 V, 60 Hz	F2				

Electrical Equipment

Dimensions						LST (RSIR & RSCR) refer to data sheet for more info					Run capacitor (RC)		HST (CSIR & CSCR) *alt. cable lengths avail.			LST/HST		
Height [mm]		Connectors location/I.D. [mm]				alt. connectors available	PTC starting device		PTC starting device with RC connector		ePTC	→ optional → compulsory*		Starting relay	Starting capacitor	Starting device*	Cord relief	Cover
A	B	Suction C (I.D.)	Process D (I.D.)	Dis-charge E (I.D.)	Spades		Spades		Spades	Spades		Spades						
		6.3 mm	4.8 mm	6.3 mm	4.8 mm	4.8 mm	6.3 mm	4.8 mm	6.3 mm	6.3 mm	6.3 mm							
203	197	9.7	6.5	6.5	X	-	-	-	-	-	-	-	117U4139	117U5018	-	117U0349	117U1021	
203	197	8.2	6.5	6.5	X	-	-	-	-	-	-	-	117U6022	117U5015	-	103N1010	103N2011	
209	203	8.2	6.2	6.2	X	-	-	-	-	-	-	-	117U6005	117U5017	-	103N1004	103N2008	
209	203	8.2	6.5	6.5	-	-	-	-	-	-	-	-	117U6011	117U5017	-	103N1004	103N2008	
219	213	8.2	6.2	6.2	X	-	-	-	-	-	-	-	117U6019	117U5017	-	103N1004	103N2008	
219	213	9.63	6.5	6.5	X	-	-	-	-	-	-	-	-	-	117-7027	103N1004	103N2008	
219	213	8.2	6.2	6.2	X	-	-	-	-	-	-	-	117U6019	117U5017	-	103N1004	103N2008	
219	213	8.2	6.5	6.5	-	-	-	-	-	-	-	-	117U6011	117U5017	-	103N1004	103N2008	
219	213	10.2	6.2	6.2	-	-	-	-	-	-	-	-	-	117U5373	117-7039	103N1004	103N2008	
219	213	9.63	6.5	6.5	X	-	-	-	-	-	-	-	-	117U5373	117-7039	103N1004	103N2008	
219	213	9.63	6.5	6.5	-	-	-	-	-	-	-	-	-	-	117-7058	103N1004	103N2008	
219	213	9.63	6.5	6.5	X	-	-	-	-	-	-	-	-	117U5373	117-7066	103N1004	103N2008	
219	213	9.63	6.5	6.5	-	-	-	-	-	-	-	-	-	-	117-7066	103N1004	103N2008	
259	254	12	6.2	6.2	-	-	-	-	-	-	-	-	-	-	-	-	-	
259	247	12.9	6.5	8.2	-	-	-	-	-	-	-	-	-	-	117-7073	-	107B9101	
279	267	12.9	6.5	9.7	-	-	-	-	-	-	-	-	-	-	117-7073	-	107B9106	
279	267	12.9	6.5	8.2	-	-	-	-	-	-	-	-	-	-	117-7073	-	107B9101	

R407C · 220-240 V · 50 Hz

Compressor	Code number	Application	ASHRAE Capacity [W] Tc=54.4°C, Tliq=32.2°C, Tsuc=32.2°C Evaporating temperature [°C]						ASHRAE						Displacement [cm³]	Voltage and frequencies [*dual frequency type with 50/60 Hz]	Compressor cooling cooling (refer to data sheet)				
			LBP rating point -23.3°C / 54.4°C		MBP rating point -6.7°C / 54.4°C		HBP rating point 7.2°C / 54.4°C		Cooling capacity		COP		Cooling capacity					COP			
			-35	-15	-5	0	10	15	[W]	[W/W]	[W]	[W/W]	[W]	[W/W]				[W]	[W/W]	[W]	[W/W]
									[W]	[W/W]	[W]	[W/W]	[W]	[W/W]				[W]	[W/W]	[W]	[W/W]
SC10DL	104L2525	M/HBP	-	469	842	1074	1653	2013	-	-	685	1.57	1308	2.32	10.29	198-254 V, 50 Hz	F2				
SC12DL	104L2625	M/HBP	-	621	1087	1385	2144	2620	-	-	886	1.58	1692	2.38	12.87	198-254 V, 50 Hz	F2				
SC15DL	104L2856	M/HBP	-	782	1351	1709	2612	3174	-	-	1104	1.70	2069	2.59	15.28	198-254 V, 50 Hz	F2				
SC10/10DL	104L4091	M/HBP	-	937	1685	2148	3307	4026	-	-	1371	1.57	2615	2.32	20.58	198-254 V, 50 Hz	F2				
SC12/12DL	104L4092	M/HBP	-	1241	2174	2769	4287	5239	-	-	1772	1.58	3384	2.38	25.74	198-254 V, 50 Hz	F2				
SC15/15DL	104L4093	M/HBP	-	1563	2703	3419	5224	6348	-	-	2208	1.70	4137	2.59	30.56	198-254 V, 50 Hz	F2				

Electrical Equipment

Dimensions						LST (RSIR & RSCR) refer to data sheet for more info					Run capacitor (RC)		HST (CSIR & CSCR) *alt. cable lengths avail.			LST/HST		
Height [mm]		Connectors location/I.D. [mm]				alt. connectors available	PTC starting device		PTC starting device with RC connector		ePTC	→ optional → compulsory*		Starting relay	Starting capacitor	Starting device*	Cord relief	Cover
A	B	Suction C (I.D.)	Process D (I.D.)	Dis-charge E (I.D.)	Spades		Spades		Spades	Spades		Spades						
		6.3 mm	4.8 mm	6.3 mm	4.8 mm	4.8 mm	6.3 mm	4.8 mm	6.3 mm	6.3 mm	6.3 mm							
209	203	8.2	6.2	6.2	X	-	-	-	-	-	-	-	117U6005	117U5017	-	103N1004	103N2009	
219	213	10.2	6.2	6.2	X	-	-	-	-	-	-	-	117U6019	117U5017	-	103N1004	103N2009	
219	213	10.2	6.2	6.2	X	-	-	-	-	-	-	-	-	117U5373	117-7029	103N1004	103N2009	
249	244	12	6.2	6.2	-	-	-	-	-	-	-	-	117U6005	117U5017	-	103N1004	103N2009	
259	254	12	6.2	6.2	-	-	-	-	-	-	-	-	117U6019	117U5017	-	103N1004	103N2009	
259	254	16	6.2	6.2	-	-	-	-	-	-	-	-	-	117U5373	117-7029	103N1004	103N2009	



Alternative refrigerant R452A, please refer to our data sheets



PL

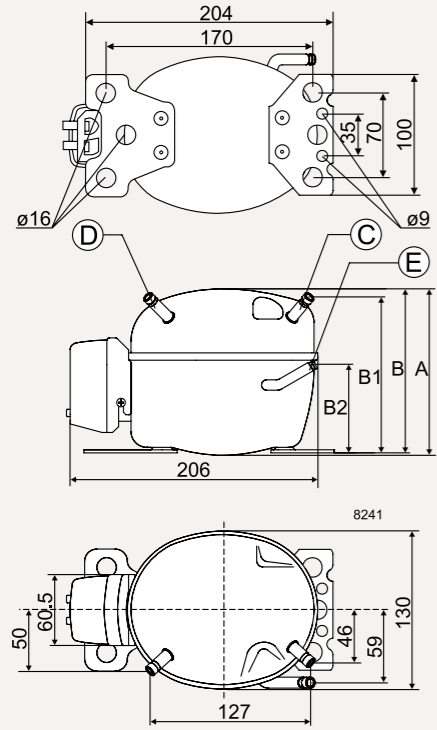

Note:
Please refer to data sheets for heights B1 and B2

TL/TLS/TLES (TFS similar)

Note:
On TL compressors suction and process connectors are interchangeable.

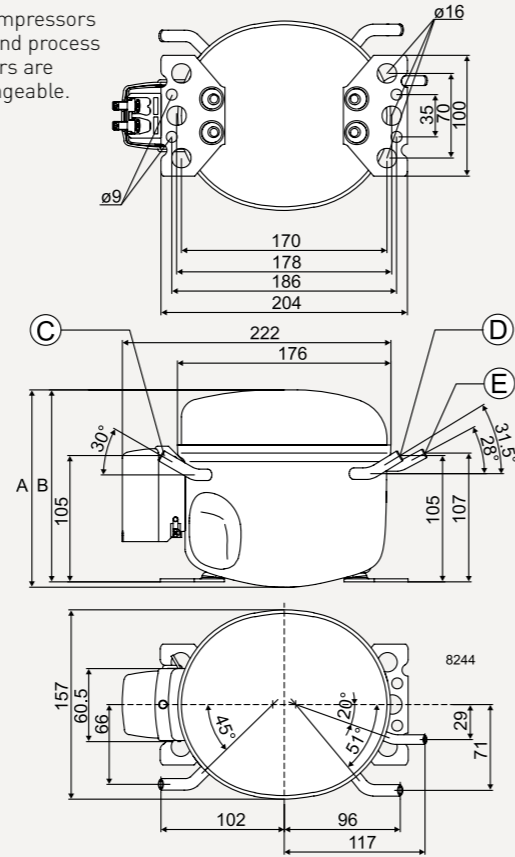

GTK (K-Series)

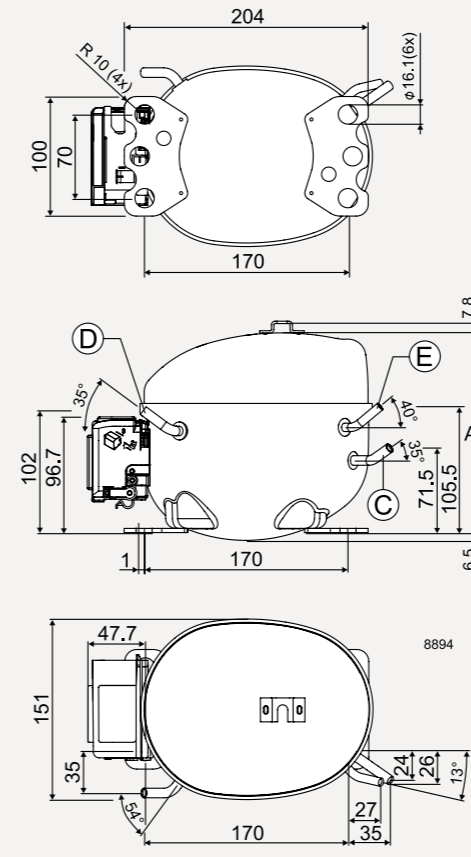

KLE/KLF (KL-Series)/FRK

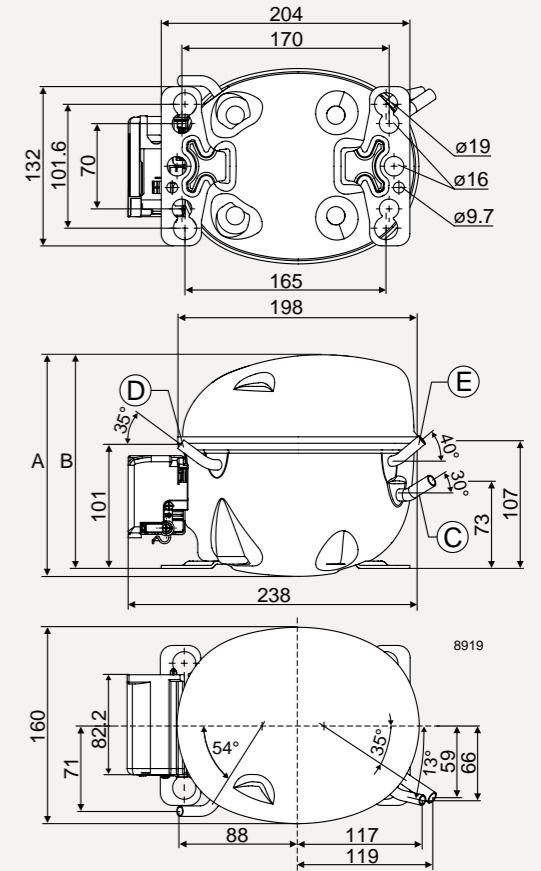

NL/NLE (NF similar)

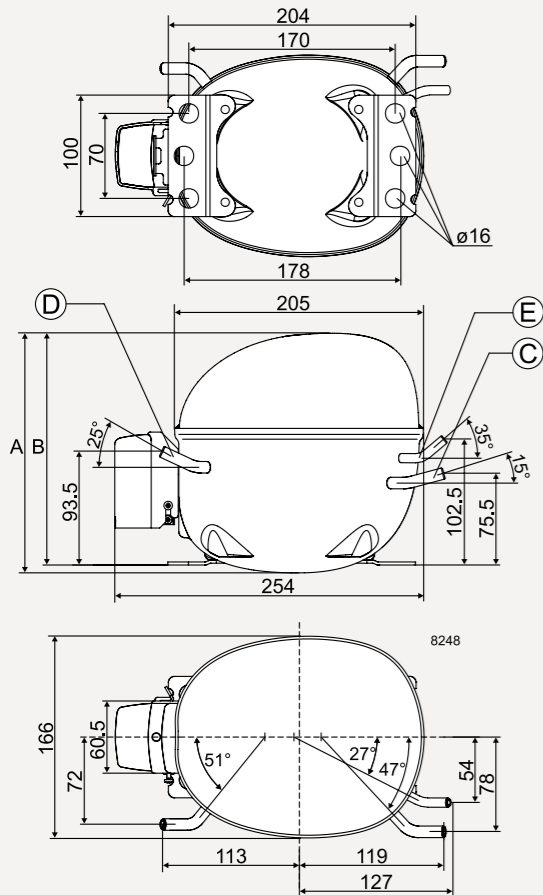

SC (SC-GHH w. additional oil cooler connector)

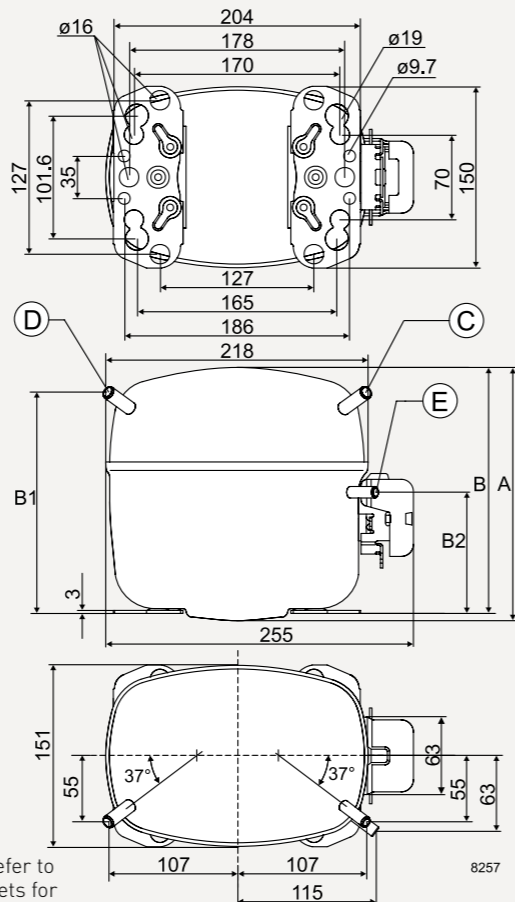

Note:
Please refer to data sheets for heights B1 and B2

GS (GS34CLX has interchanged connectors)

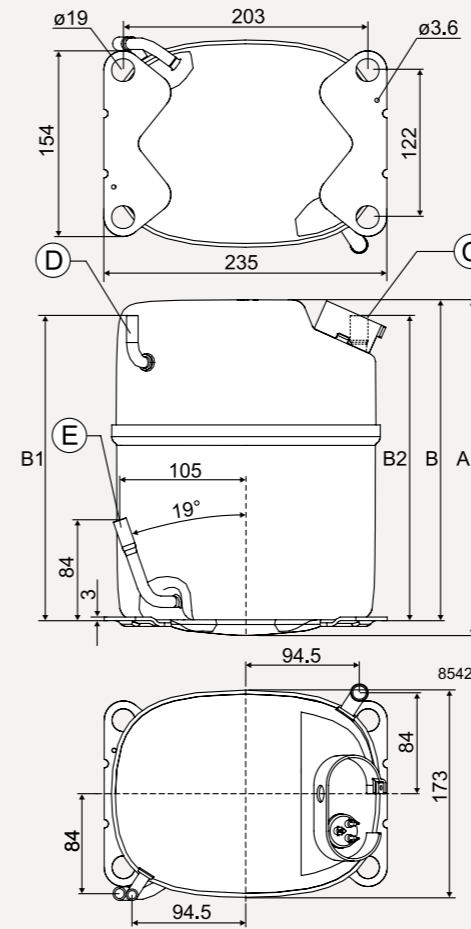

SC-Twin

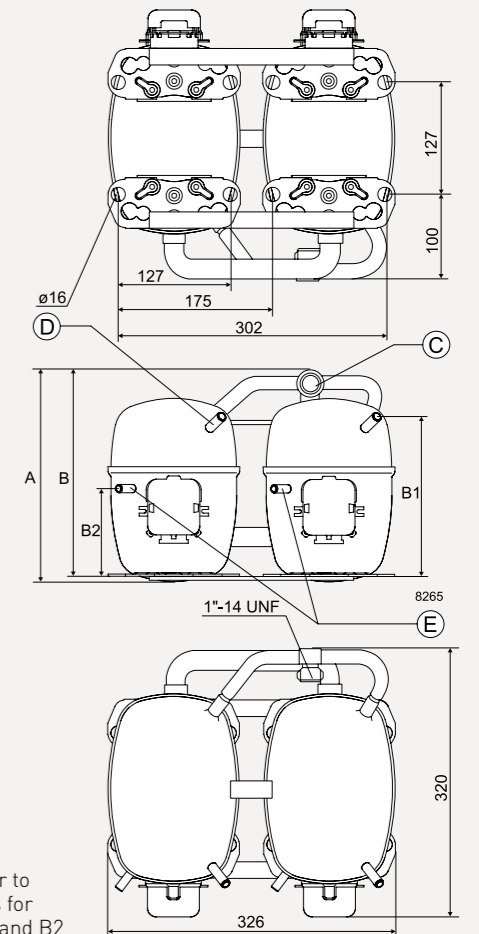

Note:
Please refer to data sheets for heights B1 and B2

Electrical Equipment · Motor Systems for Secop Compressors

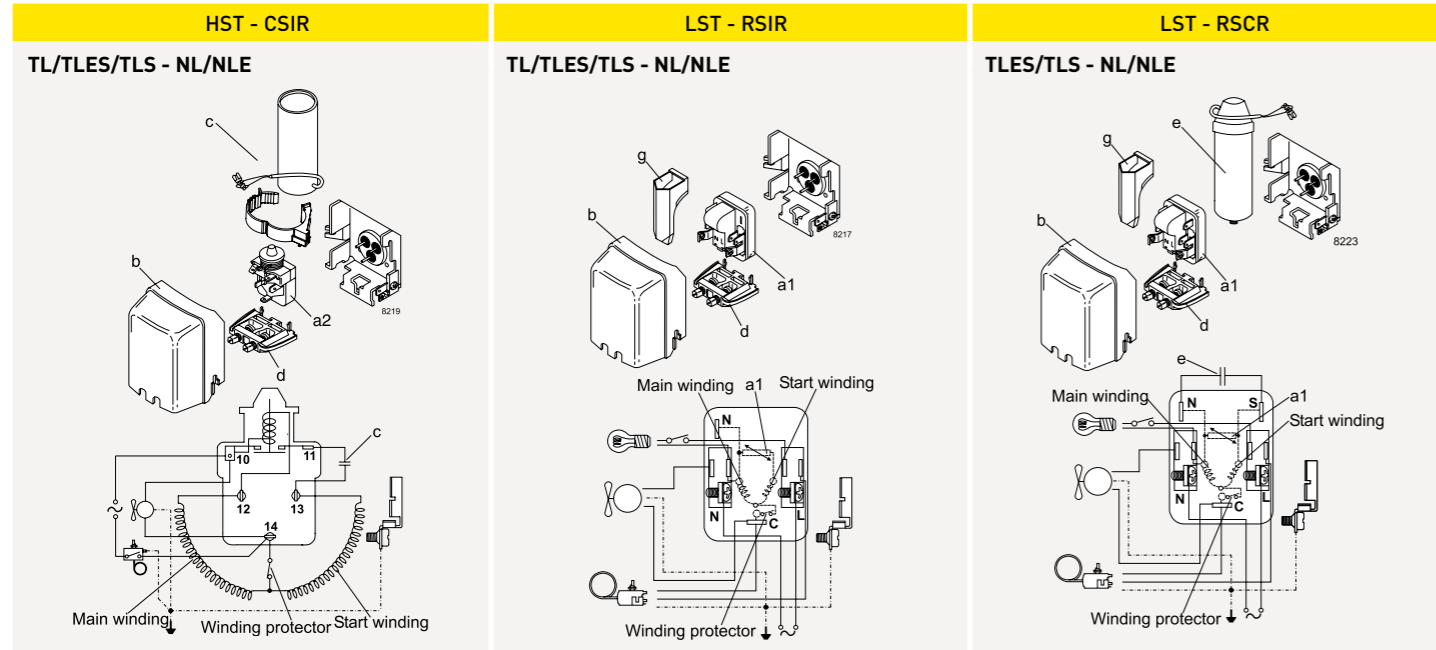

LST - RSIR	LST - RSCR
------------	------------

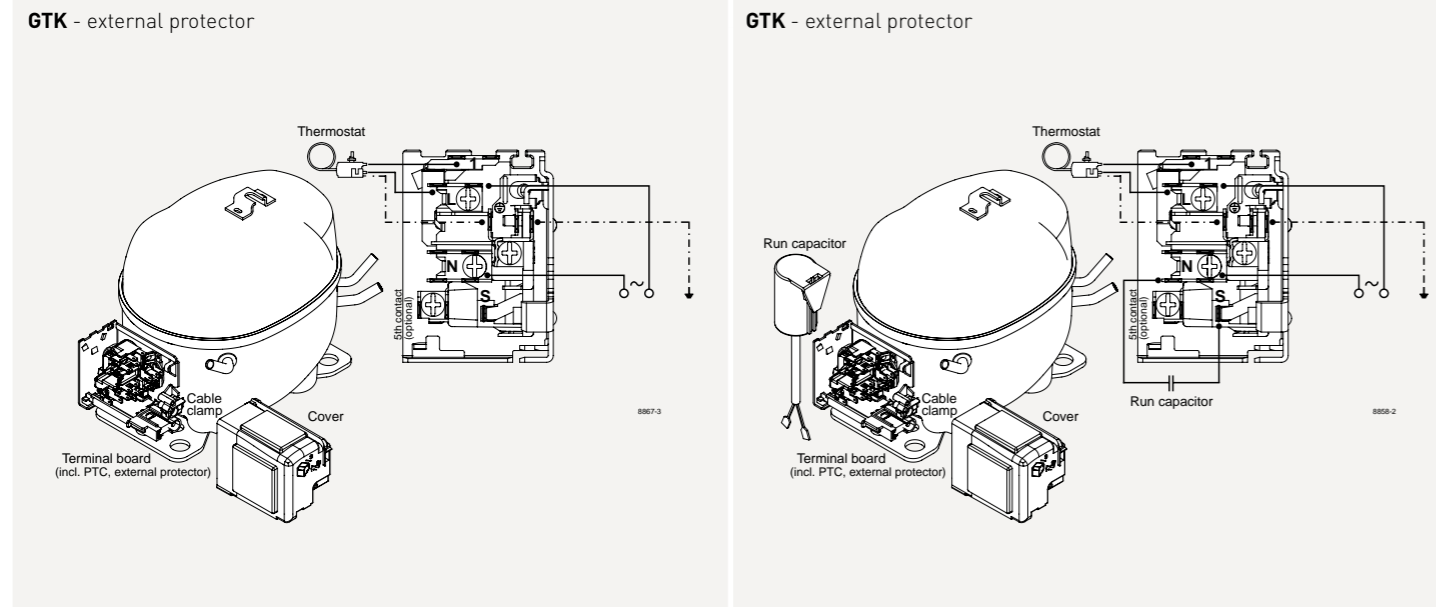

LST - RSIR	LST - RSCR	HST - CSIR
------------	------------	------------

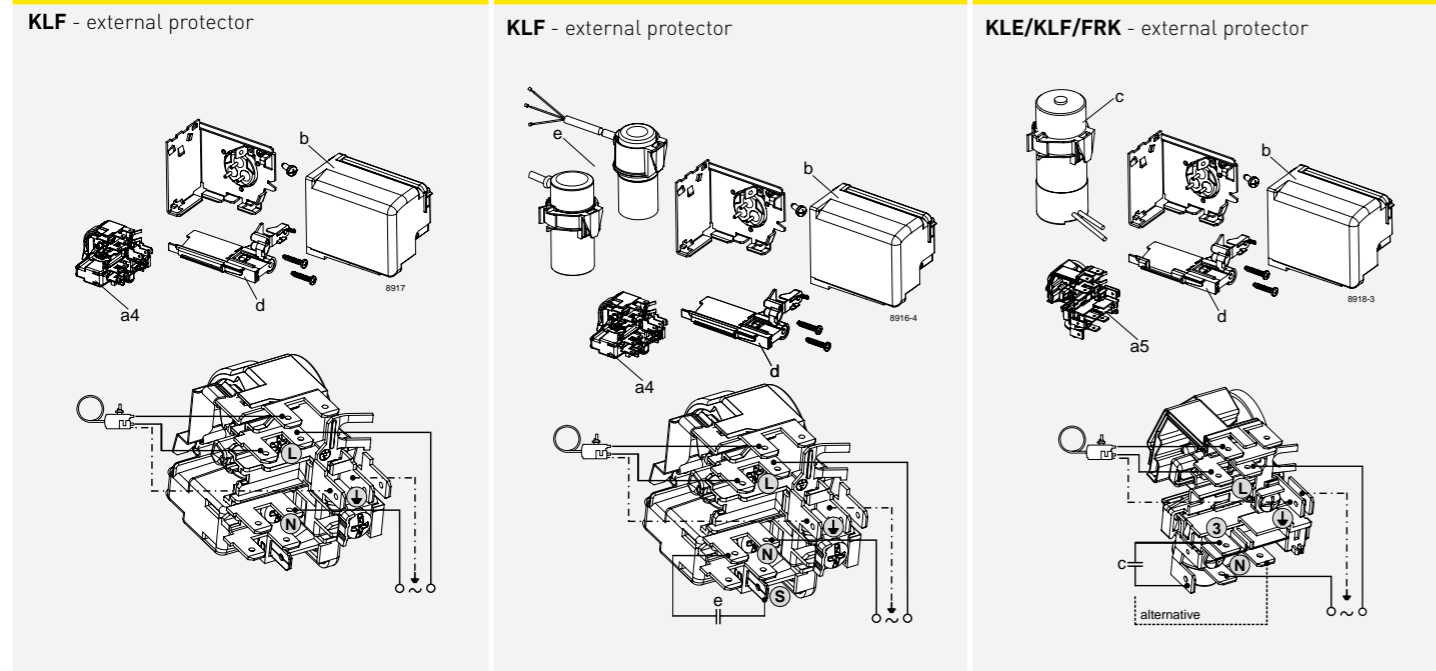

Electrical Equipment · Motor Systems for Secop Compressors

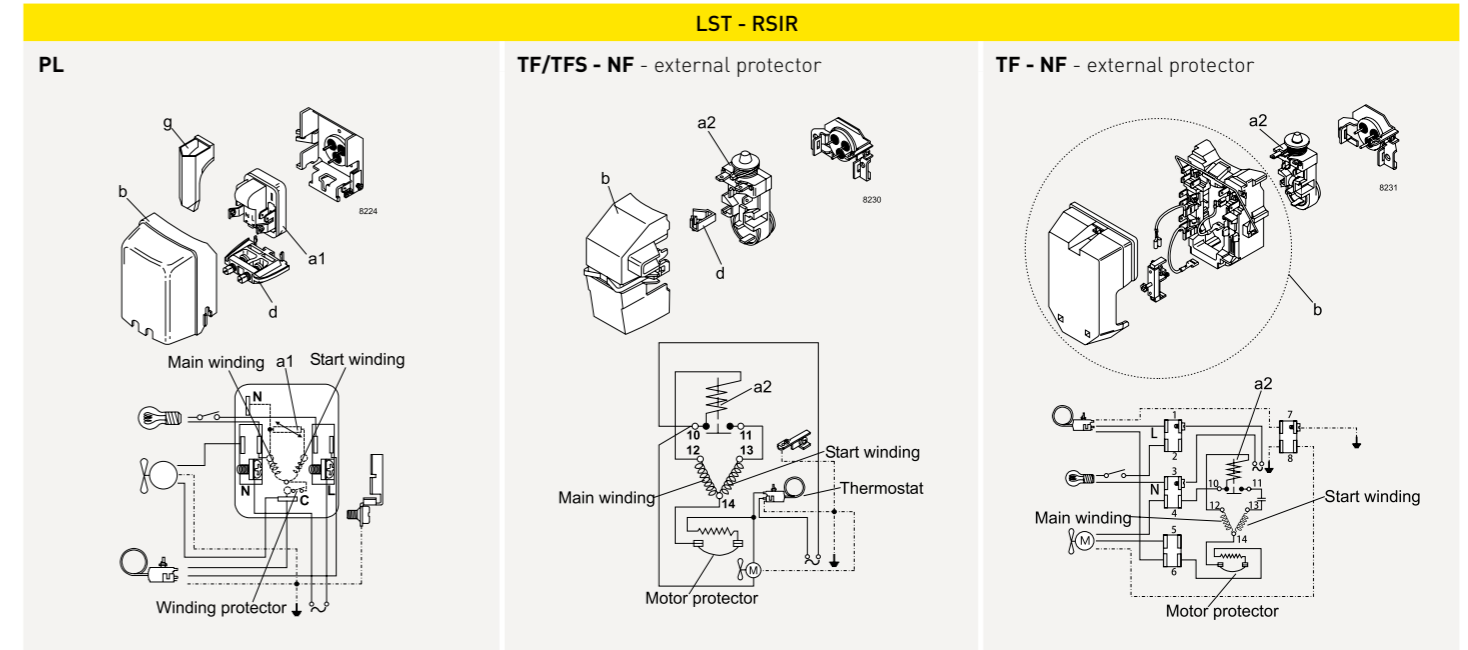

HST - CSIR	HST - CSIR	HST - CSIR
------------	------------	------------

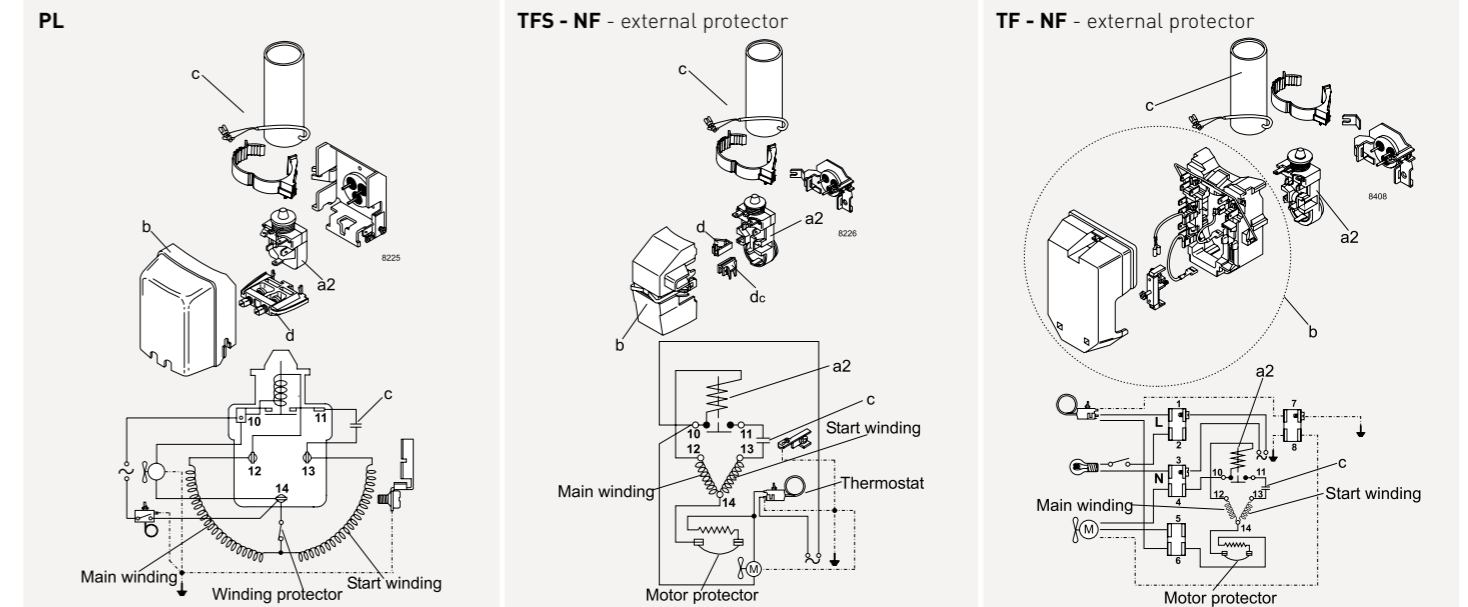

HST - CSIR	HST - CSIR
------------	------------

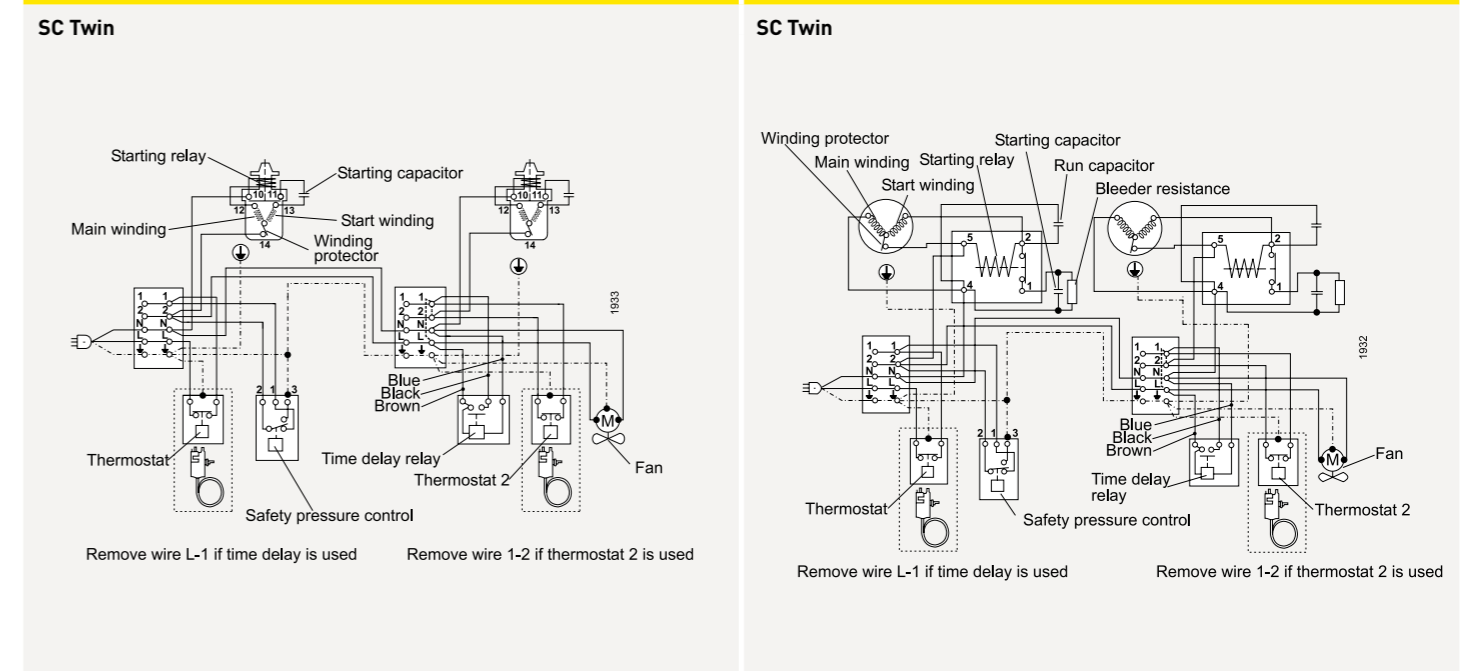

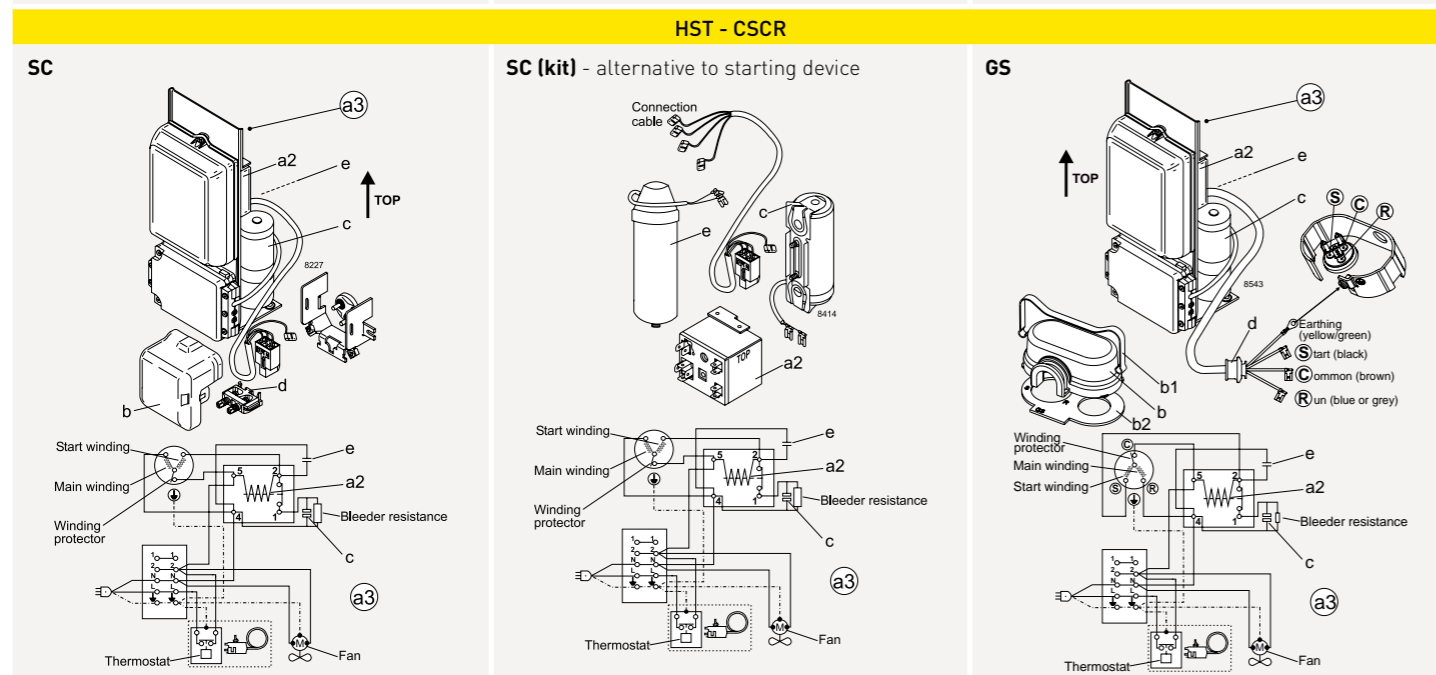
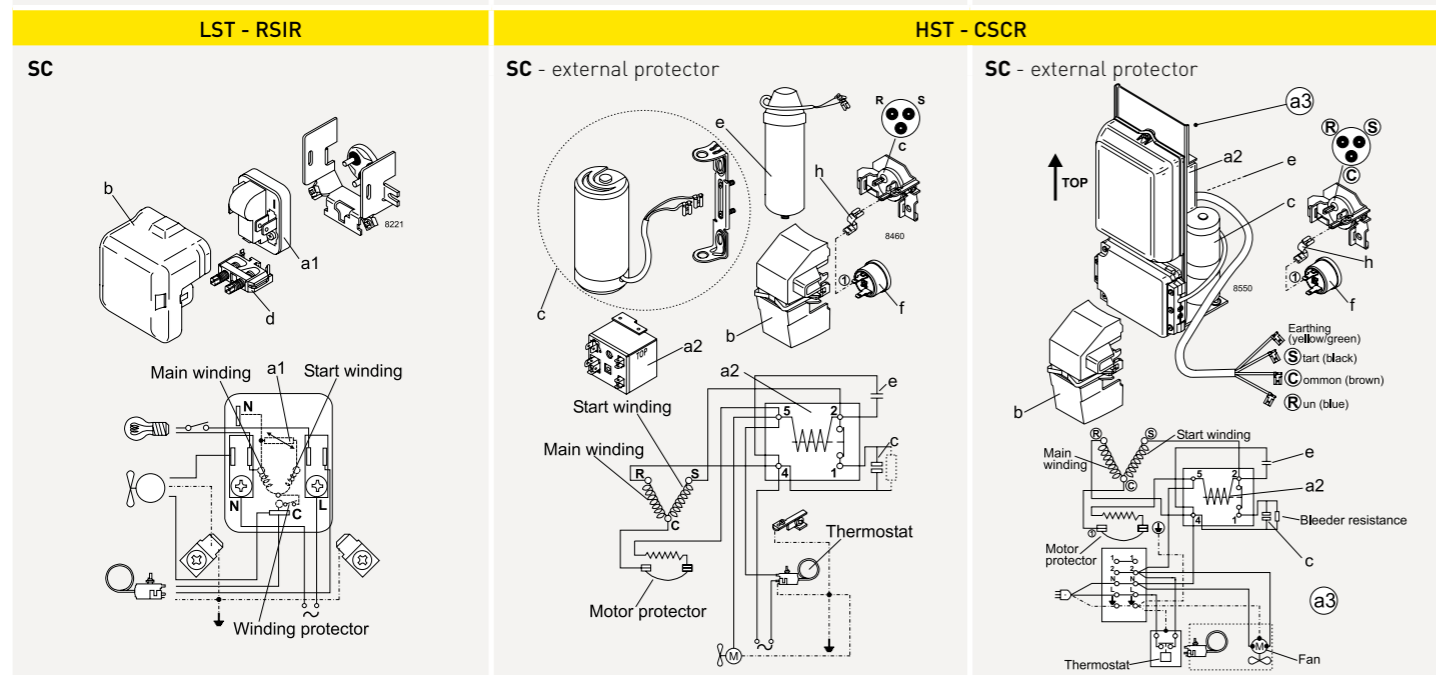
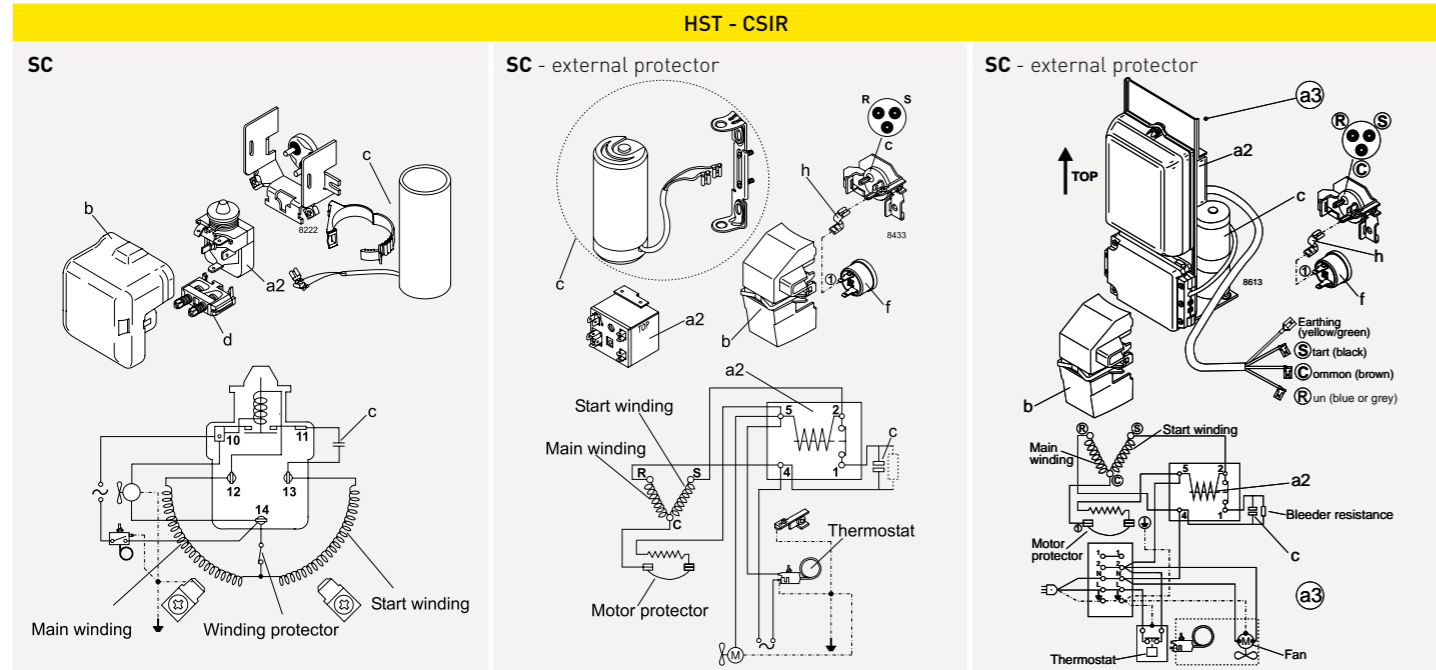

Mounting	Code number	Bolt / pin dimension	Comp. base hole	Type of packaging	Compressor series	Parts list
Bolt joint	118-1917	M6 metric	16 mm	Single pack for one compressor	P- / T- / K- / KL- / F- / N- / S-Series	I
Bolt joint	118-1918	M6 metric	16 mm	Industrial pack in any quantity	P- / T- / K- / KL- / F- / N- / S-Series	I
Bolt joint	107B9150	M8 metric	19 mm	Single pack for one compressor	G-Series	II
Bolt joint	118-1946	1/4 inch	16 mm	Single pack for one compressor	P- / T- / KL- / F- / N- / S-Series	III
Bolt joint	118-1949	1/4 inch	19 mm	Single pack for one compressor	all with 19 mm base holes (except G-Series)	IV
Snap-on	118-1947	Ø 7.3 mm	16 mm	Single pack for one compressor	P- / T- / KL- / F- / N- / S-Series	V
Snap-on	118-1919	Ø 7.3 mm	16 mm	Industrial pack in any quantity	P- / T- / KL- / F- / N- / S-Series	V

Parts list (4 pcs. per compressor needed)			Symbol drawings	
I	Sleeve Ø 8 mm x 6.4 mm x 0.8 mm	112-2052		
	Washer Ø 20 mm x Ø 6.7 mm x 1 mm	112-2053		
	Bolt M6 x 25 mm	681X1130		
II	Nut M6	118-3659		
	Rubber grommet 16 mm	118-3661		
	Sleeve Ø 11 mm x 8.6 mm x 1.2 mm	107B9152		
III	Washer Ø 20 mm x Ø 8.8 mm x 1.2 mm	107B9155		
	Bolt M8 x 40 mm	107B9153		
	Nut M8	107B9154		
IV	Rubber grommet 19 mm	107B9151		
	Sleeve Ø 8.3 mm x 6.7 mm x 0.8 mm	112-2088		
	Washer Ø 20 mm x Ø 6.7 mm x 1 mm	112-2053		
V	Bolt 1/4 x 1 inch, 20 UNC	119-3002		
	Nut 1/4 inch, 20 UNC	119-3031		
	Rubber grommet 16 mm	118-3661		
I	Sleeve Ø 9.5 mm x 7.9 mm x 0.8 mm	112-2085		
	Washer Ø 20 mm x Ø 6.7 mm x 1 mm	112-2053		
	Bolt 1/4 x 1 1/4 inch, 20 UNC	119-3002		
II	Nut 1/4 inch, 20 UNC	119-3031		
	Rubber grommet 19 mm	118-3666		
	Steel pin	118-3586		
III	Washer Ø 21 x Ø 8.1 mm x 0.9 mm	118-3588		
	Clip	118-3585		
	Rubber grommet 16 mm	118-3661		

Further information	Legend
<p>Applications</p> <p>LBP: Low Back Pressure</p> <p>HBP: High Back Pressure</p> <p>MBP: Medium Back Pressure</p> <p>Motor types</p> <p>RSIR: Resistant Start Induction Run</p> <p>RSCR: Resistant Start Capacitor Run</p> <p>CSIR: Capacitor Start Induction Run</p> <p>CSCR: Capacitor Start Capacitor Run</p> <p>Compressor cooling</p> <p>S = Static cooling normally sufficient</p> <p>O = Oil cooling</p> <p>F1 = Fan cooling 1.5 m/s (compressor compartment temp. equal to ambient temperature)</p> <p>F2 = Fan cooling 3.0 m/s necessary</p>	<p>Starting devices</p> <p>LST: Low Starting Torque</p> <p>LST is used with capillary tube control and pressure equalizing. (Pressure equalizing may exceed 10 minutes). The PTC starting device requires 5 minutes cooling before each start.</p> <p>HST: High Starting Torque</p> <p>HST consisting of relay and starting capacitor is used for expansion valve control or for capillary tube control without pressure equalizing.</p> <p>ePTC: Electronically controlled PTC</p> <ul style="list-style-type: none"> Compressor restart possible after a few seconds Operational wattage loss reduced by 2 watt PTC protection screen not needed (surface temp. < 82 °C)
	<p>a1: PTC or ePTC starting device</p> <p>a2: Starting relay</p> <p>a3: Starting device</p> <p>a4: Terminal board incl. PTC and protector</p> <p>a5: Terminal board incl. relay</p> <p>b: Cover</p> <p>b1: Clamp (part of compressor)</p> <p>b2: Gasket (part of compressor)</p> <p>c: Starting capacitor</p> <p>d: Cord relief</p> <p>e: Run capacitor</p> <p>f: Protector</p> <p>g: Protection screen for PTC</p> <p>h: Holder</p>

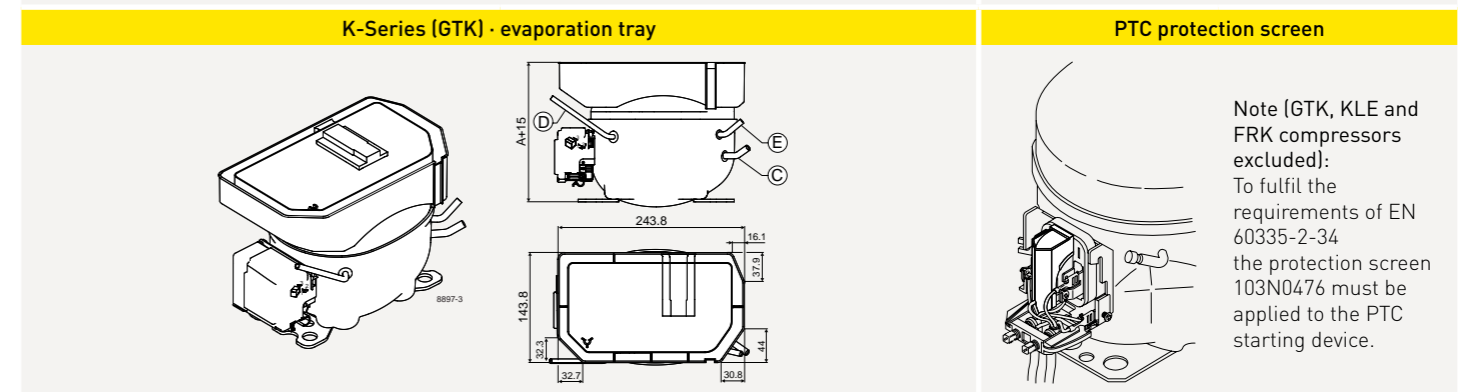

HERMETIC COMPRESSORS HC, HFC REFRIGERANTS | 60 Hz

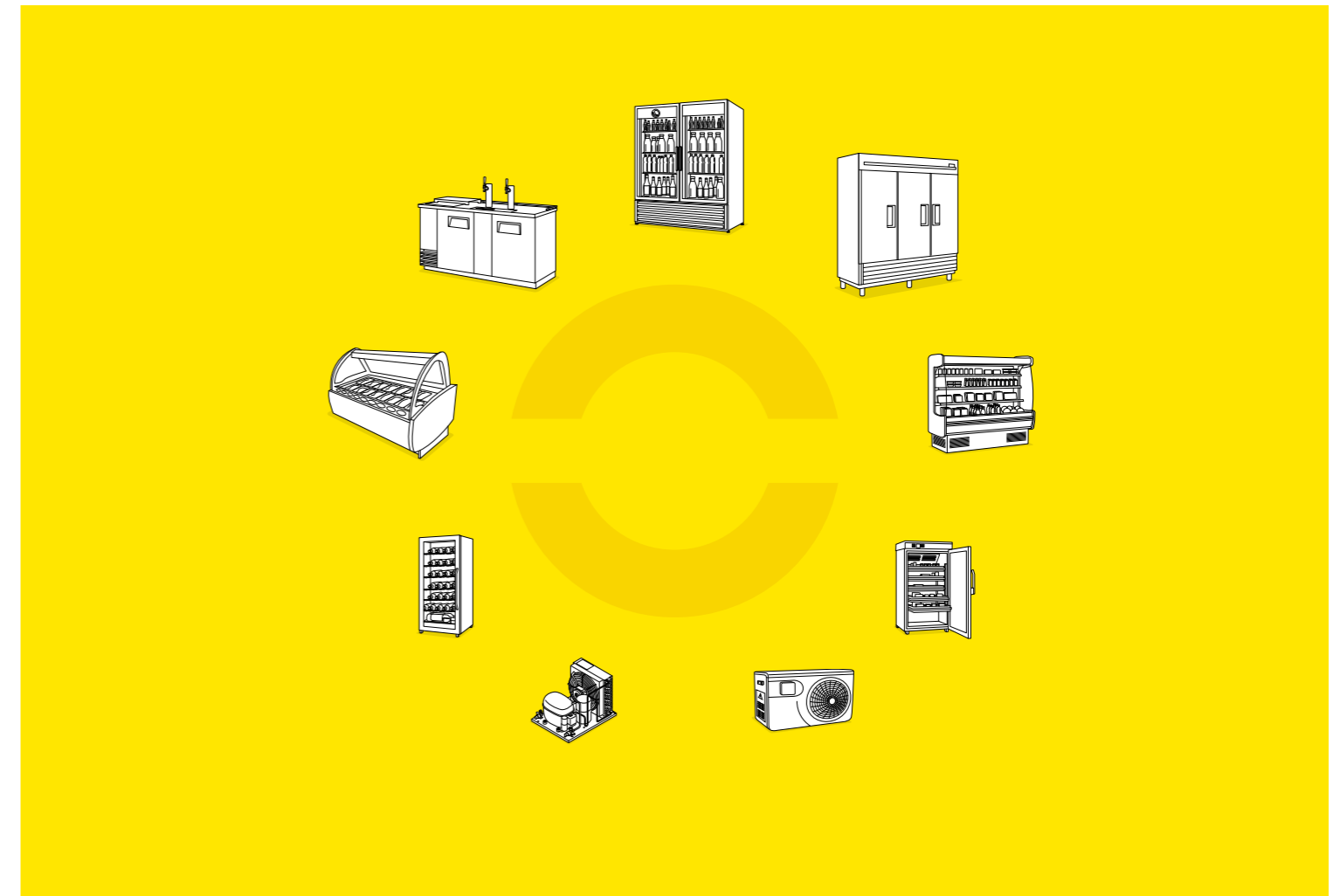

Imperial Units

R600a | R290
R134a · R513A
R404A · R452A

115–127V · 60 Hz
110–127V · 50/60 Hz
208–230V · 60 Hz
220–240V · 50/60 Hz
200–240V · 50/60 Hz

Compressor	Code number	Application	ASHRAE Capacity [BTU/h] T _c =130°F, T _{liq} =90°F, T _{suc} =90°F Evaporating temperature [°F]						ASHRAE						Displacement [cu.in]	Voltage and frequencies [*dual frequency type with 50/60 Hz]	Compressor cooling [refer to data sheet]		
			LBP rating point -10°F / 130°F		MBP rating point 20°F / 130°F		HBP rating point 45°F / 130°F		Cooling capacity		EER		Cooling capacity					EER	
			-31	-13	5	14	32	50	[BTU/h]	[BTU/Wh]	[BTU/h]	[BTU/Wh]	[BTU/h]	[BTU/Wh]				[BTU/h]	[BTU/Wh]
			[BTU/h]		[BTU/Wh]		[BTU/h]		[BTU/Wh]		[BTU/h]		[BTU/Wh]					[BTU/h]	
PL30F	101G9100	L/M/HBP	-	89	187	252	422	657	103	2.03	270	4.07	522	6.41	0.09	90-127 V, 60 Hz *	S		
PL50F	101G9202	L/MBP	-	155	290	374	585	-	175	2.70	391	4.42	-	-	0.12	103-127 V, 60 Hz	S		
TL2.5G	102G3255	L/M/HBP	-	169	336	460	788	1226	190	2.65	498	4.91	976	7.46	0.16	103-127 V, 60 Hz	S		
TL2.5F	102G3206	LBP	-	182	339	446	-	-	202	3.12	470	4.53	-	-	0.16	103-127 V, 60 Hz	S		
TL3F	102G3300	LBP	-	228	411	538	-	-	253	3.29	571	4.58	-	-	0.19	103-127 V, 60 Hz	S		
TF3.5F	102G3304	LBP	128	273	502	653	-	-	305	3.26	-	-	-	-	0.22	95-135 V, 60 Hz	S		
TL4G	102G3460	L/M/HBP	-	226	435	576	945	1444	255	2.66	613	4.16	1153	5.85	0.24	90-135 V, 60 Hz *	S		
TFS4F	102G3431	LBP	149	317	600	785	-	-	356	3.66	-	-	-	-	0.24	95-135 V, 60 Hz	S		
TLS4.5F	102G3425	LBP	238	432	760	976	-	-	477	3.70	1018	5.11	-	-	0.28	103-127 V, 60 Hz	S		
TFS4.5FT	102G3432	L/MBP	238	432	760	976	1514	-	477	3.75	1018	5.17	-	-	0.28	95-135 V, 60 Hz	S		
KLE4.0CFHX	106G6403	L/MBP	-	406	723	930	1454	-	451	4.11	972	6.17	-	-	0.24	95-140 V, 60 Hz	S		
KLE4.8CFHX	106G6503	L/MBP	-	487	866	1113	1739	-	540	4.30	1163	6.27	-	-	0.29	95-140 V, 60 Hz	F2		
KLE5.6CFHX	106G6603	L/MBP	-	567	1008	1295	2021	-	629	4.42	1352	6.35	-	-	0.34	95-140 V, 60 Hz	F2		
KLE6.6CFHX	106G6703	L/MBP	-	667	1184	1520	2371	-	739	4.52	1588	6.40	-	-	0.40	95-140 V, 60 Hz	F2		
KLE7.7CFHX	106G6803	L/MBP	-	788	1370	1750	2708	-	870	4.50	1822	6.14	-	-	0.47	95-140 V, 60 Hz	F2		
NF5.5FX	105G5623	L/MBP	281	628	1098	1398	2165	-	696	4.12	1454	5.71	-	-	0.37	95-135 V, 60 Hz	F2		
NF6.1FX.2	105G5631	L/MBP	293	648	1161	1490	2315	-	721	4.06	1554	6.09	-	-	0.37	95-135 V, 60 Hz	F1		
NF6FK	105G5628	L/MBP	270	603	1054	1342	2079	-	668	3.88	1396	5.38	-	-	0.37	95-135 V, 60 Hz	F2		
NF7FK	105G5728	L/MBP	383	759	1275	1608	2468	-	834	4.09	1665	5.48	-	-	0.44	95-135 V, 60 Hz	F2		
NF7FX	105G5723	L/MBP	395	783	1314	1657	2545	-	860	4.00	1717	5.54	-	-	0.44	95-135 V, 60 Hz	F2		
NF7.3FX.2	105G5722	L/MBP	387	806	1413	1801	2776	-	893	3.95	1872	5.81	-	-	0.44	95-135 V, 60 Hz	F1		
NF8.4FX.2	105G5918	L/MBP	-	934	1613	2047	3138	-	1031	4.16	2123	5.88	-	-	0.51	95-135 V, 60 Hz	F1		
NF9FX	105G5920	L/MBP	-	852	1454	1848	2864	-	937	3.83	1923	5.54	-	-	0.51	95-135 V, 60 Hz	F2		
NF10FX	105G5941	L/MBP	-	952	1625	2060	3184	-	1048	4.01	2140	5.48	-	-	0.62	95-135 V, 60 Hz	F2		
NF11FX	105G5945	MBP	477	996	1726	2199	3419	-	1100	3.72	2290	5.19	-	-	0.68	95-135 V, 60 Hz	F2		
NF11FX.2	105G5916	MBP	-	-	2054	2615	4025	-	-	-	2717	5.62	-	-	0.69	95-135 V, 60 Hz	F2		
SC12G	104G7250	L/M/HBP	203	873	1799	2395	3927	6016	1007	3.38	2548	5.33	4795	7.64	0.79	103-127 V, 60 Hz	F1		
SC15FTX	104G7505	LBP	677	1406	2412	3051	-	-	1552	3.83	3160	5.00	-	-	0.93	90-135 V, 60 Hz	F2		
SC15G	104G7550	L/M/HBP	-	1085	2183	2898	4663	6882	1237	3.76	3071	5.43	5551	7.24	0.93	103-127 V, 60 Hz	F1		
SC18G	104G7800	L/M/HBP	-	1142	2522	3323	5255	7779	1356	3.36	3496	5.06	6255	6.86	1.08	95-135 V, 60 Hz	F2		

Note: T-Series compressors will be phased out in 2025

Power [HP]	Dimensions						LST [RSIR & RSCR] refer to data sheet for more info					Run capacitor (RC)		HST (CSIR & CSCR) *alt. cable lengths avail.			LST/HST	
	Height [inch]		Connectors location/I.D. [inch]				PTC starting device		PTC starting device with RC connector		ePTC	→ optional → compulsory*		Starting relay	Starting capacitor	Starting device*	Cord relief	Cover
	A	B	Suction C (I.D.)	Process D (I.D.)	Dis-charge E (I.D.)	alt. connectors available	Spades		Spades		Spades	Spades		Spades				
							1/4 inch	3/16 inch	1/4 inch	3/16 inch	3/16 inch	1/4 inch	3/16 inch	1/4 inch	1/4 inch	1/4 inch		
1/20	5.3	5.2	0.26	0.26	0.20	-	103N0026	103N0023	-	-	-	-	-	117U6000	117U5015	-	103N1010	103N0492
1/14	5.3	5.2	0.26	0.26	0.20	-	103N0026	103N0023	-	-	-	-	-	117U6000	117U5015	-	103N1010	103N0492
1/14	6.4	6.3	0.26	0.26	0.20	X	103N0026	103N0023	-	-	-	-	-	-	-	-	103N1010	103N2011
1/12	6.4	6.3	0.26	0.26	0.20	X	103N0026	103N0023	-	-	-	-	-	-	-	-	103N1010	103N2011
1/10	6.4	6.3	0.26	0.26	0.20	-	103N0026	103N0023	-	-	-	-	-	-	-	-	103N1010	103N2011
1/10	6.8	6.7	0.26	0.26	0.20	X	-	-	-	-	-	-	-	-	-	-	117U0349	117U1021
1/8	6.8	6.7	0.26	0.26	0.20	X	103N0026	103N0023	-	-	-	-	-	117U6003	117U5023	-	103N1010	103N2011
1/10	6.8	6.7	0.26	0.26	0.20	X	-	-	-	-	-	-	-	-	-	-	117U0349	117U1021
1/8	6.4	6.3	0.26	0.26	0.20	-	103N0026	103N0023	-	-	-	-	-	117U6003	117U5023	-	103N1010	103N2011
1/8	6.8	6.7	0.26	0.26	0.19	X	-	-	-	-	-	-	-	117U4126	117U5022	-	117U0349	117U1021
1/5	7.2	6.9	0.32	0.26	0.26	-	-	-	-	-	-	-	-	117U708	117U5002	-	16058100	10636501
1/4	7.2	6.9	0.32	0.26	0.26	-	-	-	-	-	-	-	-	117U708	117U5002	-	16058100	10636501
1/4	7.2	6.9	0.32	0.26	0.26	-	-	-	-	-	-	-	-	117U708	117U5002	-	16058100	10636501
1/3	7.2	6.9	0.32	0.26	0.26	-	-	-	-	-	-	-	-	117U708	117U5002	-	16058100	10636501
1/3	7.2	6.9	0.32	0.26	0.26	-	-	-	-	-	-	-	-	117U708	117U5002	-	16058100	10636501
1/4	7.8	7.5	0.32	0.26	0.26	X	-	-	-	-	-	-	-	117U4127	117U5002	-	117U0349	117U1021
1/4	8.0	7.8	0.32	0.26	0.26	X	-	-	-	-	-	-	-	117U4132	117U5022	-	117U0349	117U1021
1/3	8.0	7.8	0.32	0.26	0.26	X	-	-	-	-	-	-	-	117U4132	117U5022	-	117U0349	117U1021
1/3	7.8	7.5	0.32	0.26	0.26	X	-	-	-	-	-	-	-	117U4061	117U5025	-	117U0349	117U1021
1/3	7.8	7.5	0.32	0.26	0.26	X	-	-	-	-	-	-	-	117U4061	117U5025	-	117U0349	117U1021
1/3+	7.8	7.5	0.32	0.26	0.26	X	-	-	-	-	-	-	-	117U4129	117U5025	-	117U0349	117U1021
1/3	7.8	7.5	0.32	0.26	0.26	X	-	-	-	-	-	-	-	117U4129	117U5025	-	117U0349	117U1021
1/3+	7.8	7.5	0.32	0.26	0.26	X	-	-	-	-	-	-	-	117U4129	117U5022	-	117U0349	117U1021
1/2	8.0	7.8	0.32	0.26	0.26	X	-	-	-	-	-	-	-	117U4123	117U5028	-	117U0349	117U1021
1/2	8.0	7.8	0.32	0.26	0.26	X	-	-	-	-	-	-	-	117U4151	117U5028	-	117U0349	117U1021
1/3+	8.2	8.0	0.32	0.26	0.26	X	-	-	-	-	-	-	-	117U6020	117U5023	-	103N1004	103N2008
1/2	8.2	8.0	0.32	0.26	0.26	X	-	-	-	-	-	-	-	117U6020	117U5023	-	103N1004	103N2008
1/2	8.2	8.0	0.32	0.26	0.26	X	-	-	-	-	-	-	-	117U6020	117U5023	-	103N1004	103N2008
3/4	8.6	8.4	0.38	0.26	0.26	-	-	-	-	-	-	-	-	117-7441	117U5042	117-7053	-	117U1021



Alternative refrigerant R513A, please refer to our data sheets



R134a · 220-240 V · 50/60 Hz | 208-230 V · 60 Hz

Compressor	Code number	Application	ASHRAE Capacity [BTU/h]						ASHRAE						Displacement [cu.in]	Voltage and frequencies [*dual frequency type with 50/60 Hz]	Compressor cooling (refer to data sheet)
			Tc=130°F, Tliq=90°F, Tsuc=90°F Evaporating temperature [°F]						LBP rating point -10°F / 130°F		MBP rating point 20°F / 130°F		HBP rating point 45°F / 130°F				
			-31	-13	5	14	32	50	Cooling capacity	EER	Cooling capacity	EER	Cooling capacity	EER			
			[BTU/h]	[BTU/h]	[BTU/h]	[BTU/h]	[BTU/h]	[BTU/h]	[BTU/h]	[BTU/Wh]	[BTU/h]	[BTU/Wh]	[BTU/h]	[BTU/Wh]			
PL35G	101G0250	L/M/HBP	-	145	270	349	546	-	163	2.98	364	4.30	-	-	0.12	198-254 V, 60 Hz *	F1
TL2.5G	102G4251	L/M/HBP	60	179	342	447	715	1080	202	2.88	471	4.55	864	6.35	0.16	198-254 V, 60 Hz *	S
TL3G	102G4350	L/M/HBP	-	202	402	530	-	-	231	3.15	562	4.59	-	-	0.19	198-254 V, 60 Hz *	S
TL4G	102G4452	L/M/HBP	-	295	539	701	-	-	329	3.60	737	5.05	-	-	0.24	198-254 V, 60 Hz *	S
TL4GH	102G4455	HBP	-	-	507	682	1123	1716	-	-	728	4.86	1368	6.80	0.24	198-254 V, 60 Hz *	F2
TL5G	102G4550	L/M/HBP	-	387	683	874	-	-	429	3.84	-	-	-	-	0.31	198-254 V, 60 Hz *	S
TL56.5FT.3	102G4724	LBP	355	664	1130	1438	-	-	729	4.65	-	-	-	-	0.40	198-254 V, 60 Hz *	S
TL57FT.4	102G4708	LBP	355	664	1130	1438	-	-	729	4.65	-	-	-	-	0.40	198-254 V, 60 Hz *	S
KLE4.0GFTX	106G5403	L/M/HBP	166	378	670	857	1334	1978	421	4.11	892	6.19	1588	8.82	0.24	187-254 V, 60 Hz *	F2
KLE4.8GFTX	106G5503	L/M/HBP	259	478	839	1079	1690	2491	528	4.45	1127	6.55	2005	9.25	0.29	187-254 V, 60 Hz *	F2
KLE5.6GFTX	106G5603	L/M/HBP	307	598	1024	1302	2018	2989	660	4.70	1352	6.65	2399	9.31	0.34	187-254 V, 60 Hz *	F2
KLE6.6GFTX	106G5703	L/M/HBP	367	710	1222	1557	2415	3564	784	4.69	1618	6.52	2865	8.97	0.40	187-254 V, 60 Hz *	F2
KLE7.7GFTX	106G5803	L/M/HBP	435	825	1405	1781	2738	4009	909	4.75	1846	6.33	3229	8.41	0.47	187-254 V, 60 Hz *	F2
KLE8.6GFTX	106G5903	L/M/HBP	500	929	1595	2029	3125	4556	1024	4.61	2106	6.07	3676	7.91	0.52	187-254 V, 60 Hz *	F2
KLF6.6MFT	106G2701	MBP	336	681	1209	1553	2422	-	757	4.70	1619	6.66	-	-	0.40	187-254 V, 60 Hz *	F2
KLF7.7MFT	106G2802	MBP	426	805	1399	1788	2767	-	890	4.69	1859	6.40	-	-	0.47	187-254 V, 60 Hz *	F2
NL6FT	105G6628	LBP	248	502	841	1058	-	-	551	4.16	-	-	-	-	0.37	198-254 V, 60 Hz *	S
NF7FX	105G6743	L/MBP	389	787	1320	1661	2545	-	864	4.02	1719	5.56	-	-	0.44	198-242 V, 60 Hz	F1
NF10FX	105G6846	L/MBP	512	937	1529	1924	2988	-	1021	3.90	1996	5.23	-	-	0.62	198-242 V, 60 Hz *	F2
NL6.1MF	105G6660	L/MBP	185	498	947	1239	1994	-	562	3.97	1308	5.54	-	-	0.37	187-254 V, 60 Hz *	S
NL7.3MF	105G6772	L/MBP	313	677	1199	1539	2418	-	751	4.06	1609	5.42	-	-	0.44	187-254 V, 60 Hz *	F1
NL8.4MF	105G7802	L/MBP	329	759	1377	1779	2819	-	847	4.20	1867	5.53	-	-	0.51	187-254 V, 60 Hz *	F1
NL10MF	105G6885	L/MBP	465	985	1716	2190	3417	-	1090	4.40	2283	5.66	-	-	0.62	187-254 V, 60 Hz *	F1
NLE12.6MF.2	105G6387	L/MBP	1009	1368	2276	2937	4677	-	1481	5.34	3088	7.14	-	-	0.77	198-254 V, 60 Hz *	F2
NLE12.6MFT	105G6388	L/MBP	1009	1368	2276	2937	4677	-	1481	5.34	3088	7.14	-	-	0.77	198-254 V, 60 Hz *	F2
FRK5G	106G5453	L/M/HBP	164	374	663	848	1320	1959	417	4.03	883	6.07	1572	8.65	0.24	187-254 V, 60 Hz *	F2
FRK6G	106G5553	L/M/HBP	256	473	831	1069	1673	2466	523	4.36	1116	6.42	1985	9.06	0.29	187-254 V, 60 Hz *	F2
FRK7.5G	106G5653	L/M/HBP	303	592	1014	1289	1998	2959	653	4.60	1339	6.52	2375	9.13	0.34	187-254 V, 60 Hz *	F2
FRK8.5G	106G5753	L/M/HBP	363	703	1210	1542	2390	3528	776	4.60	1602	6.39	2836	8.79	0.40	187-254 V, 60 Hz *	F2
FRK10G	106G5853	L/M/HBP	430	817	1391	1764	2710	3969	900	4.65	1827	6.20	3197	8.24	0.47	187-254 V, 60 Hz *	F2
FRK11G	106G5953	L/M/HBP	495	919	1579	2009	3093	4511	1014	4.51	2084	5.95	3639	7.75	0.52	187-254 V, 60 Hz *	F2
SC10G	104G8000	L/M/HBP	119	565	1331	1831	-	-	670	2.95	1972	5.43	-	-	0.63	198-254 V, 60 Hz *	F2
SC10GH	104G8041	HBP	-	-	1361	1793	2909	4446	-	-	1899	5.08	3544	6.89	0.63	198-254 V, 60 Hz *	F2
SC12FT	104G8205	LBP	531	1152	2020	2576	-	-	1276	4.04	2680	5.44	-	-	0.79	198-254 V, 60 Hz *	F1
SC15FT	104G8505	LBP	655	1395	2417	3069	-	-	1542	4.09	3185	5.54	-	-	0.93	198-254 V, 60 Hz *	F2
SC12G	104G8240	L/M/HBP	318	865	1722	2297	-	-	983	3.50	2451	5.47	-	-	0.79	198-254 V, 60 Hz *	F2
SC12G	104G8245	MBP	-	-	1573	2200	3852	6162	-	-	2401	5.65	4860	8.38	0.79	187-254 V, 60 Hz	F2
SC12GH	104G8261	HBP	-	-	1573	2168	3734	5923	-	-	2350	5.52	4680	8.13	0.79	198-254 V, 60 Hz *	F2
SC15G	104G8520	L/M/HBP	-	1114	2182	2867	-	-	1263	3.64	3020	5.58	-	-	0.93	198-254 V, 60 Hz *	F2
SC15G	104G8526	MBP	-	-	1988	2720	4449	6668	-	-	2907	5.69	5348	8.11	0.93	187-254 V, 60 Hz	F2
SC15GH	104G8561	HBP	-	-	1792	2459	4292	6927	-	-	2673	5.70	5449	8.17	0.93	198-254 V, 60 Hz *	F2
SC18FTX	104G8805	LBP	796	1650	2857	3632	-	-	1823	4.11	3774	5.69	-	-	1.08	198-254 V, 60 Hz *	F2
SC18G	104G8820	L/M/HBP	-	1422	2632	3407	-	-	1596	3.86	3572	5.41	-	-	1.08	198-254 V, 60 Hz *	F2
SC18G	104G8823	MBP	-	-	2426	3158	5122	7903	-	-	3336	6.03	6282	8.57	1.08	187-254 V, 60 Hz	F2
SC18GH	104G8861	HBP	-	-	2426	3158	5122	7903	-	-	3336	6.03	6282	8.57	1.08	198-254 V, 60 Hz *	F2
SC18MFX	104G8804	MBP	-	-	2822	3595	5598	8355	-	-	3744	5.96	6697	8.09	1.08	187-254 V, 60 Hz *	F2
SC21FTX	104G8106	LBP	1017	1985	3379	4278	-	-	2184	4.39	4437	5.77	-	-	1.28	187-254 V, 60 Hz	F2
SC21G	104G8140	L/M/HBP	-	1304	2780	3729	-	-	1516	3.67	3980	5.69	-	-	1.28	198-254 V, 60 Hz *	F2
SC21G	104G8143	L/M/HBP	-	1304	2780	3729	-	-	1516	3.67	3980	5.69	-	-	1.28	198-254 V, 60 Hz	F2

Note: T-Series compressors will be phased out in 2025

Electrical Equipment

Power [HP]	Dimensions						LST (RSIR & RSCR) refer to data sheet for more info					Run capacitor (RC)		HST (CSIR & CSCR) *alt. cable lengths avail.			LST/HST		
	Height (inch)		Connectors location/I.D. (inch)				PTC starting device		PTC starting device with RC connector		ePTC	→ optional → compulsory*		Starting relay	Starting capacitor	Starting device*	Cord relief	Cover	
	A	B	Suction C (I.D.)	Process D (I.D.)	Dis-charge E (I.D.)	alt. connectors available	1/4 inch	3/16 inch	1/4 inch	3/16 inch	3/16 inch	1/4 inch	3/16 inch	1/4 inch	1/4 inch	1/4 inch			
							Spades	Spades	Spades	Spades	Spades	Spades	Spades	Spades	Spades	Spades			
1/15	5.4	5.3	0.24	0.24	0.20	X	103N0011	103N0018	-	-	-	-	-	-	117U6021	117U5014	-	103N1010	103N0491
1/12	6.4	6.3	0.24	0.24	0.20	X	103N0011	103N0018	-	-	-	-	-	-	117U6007	117U5014	-	103N1010	103N2011
1/10	6.4	6.3	0.24	0.24	0.20	X	103N0011	103N0018	-	-	-	-	-	-	117U6009	117U5014	-	103N1010	103N2010
1/8	6.8	6.7	0.24	0.24	0.20	X	103N0011	103N0018	-	-	-	-	-	-	117U6004	117U5014	-	103N1010	103N2010
1/8	6.8	6.7	0.24	0.24	0.20	-	-	-	-	-	-	-	-	-	117U6000	117U5014	-	103N1010	103N2011
1/6	6.8	6.7	0.24	0.24	0.20	X	103N0011	103N0018	-	-	-	-	-	-	117U6000	117U5014	-	103N1010	103N2010
1/5	6.8	6.7	0.24	0.24	0.20	X	103N0011	103N0018	103N0016	103N0021	-	117-7117	117-7119	117U6016	117U5014	-	103N1010	103N2010	
1/5	6.8	6.7	0.32	0.26	0.20	-	103N0011	103N0018	103N0016	103N0021	-	117-7117	117-7119	117U6016	117U5014	-	103N1010	103N2010	
1/6	7.2	6.9	0.24	0.24	0.20	-	-	-	-	-	-	-	-	-	117U7073	117U5001	-	16058100	10636401
1/6	7.2	6.9	0.32	0.24	0.24	-	-	-	-	-	-	-	-	-	117U7073	117U5001	-	16058100	10636401
1/5	7.2	6.9	0.32	0.24	0.24	-	-	-	-	-	-	-	-	-	117U7070	117U5001	-	16058100	10636401
1/4	7.2	6.9	0.32	0.24	0.24	-	-	-	-	-	-	-	-	-	117U7071	117U5001	-	16058100	10636401
1/3	7.2	6.9	0.32	0.24	0.24	-	-	-	-	-	-	-	-	-	117U7071	117U5001	-	16058100	10636401
1/3+	7.2	6.9	0.32	0.24	0.24	-	-	-	-	-	-	-	-	-	117U7079	117U5001	-	16058100	10636401
1/4	7.2	6.9	0.32	0.24	0.24	-	-	-	103N0250	103N0252	-	117-7191	117-7190	117U7071	117U5001	-	16058100	10636401	
1/3	7.2	6.5	0.32	0.24	0.24	-	-	-	103N0250	103N0252	-	117-7191	117-7190	117U7071	117U5001	-	16058100	10636401	
1/6	7.8	7.5	0.24	0.24	0.20	-	103N0011	103N0018	-	-	-	-	-	-	117U6000	117U5015	-	103N1010	103N2010
1/4	8.0	7.8	0.32	0.26	0.26	X	-	-	-	-	-	-	-	-	117U4140	117U5018	-	117U0349	117U1023
1/3	8.0	7.8	0.32	0.26	0.26	X	-	-	-	-	-	-	-	-	117U4139	117U5018	-	117U0349	117U1021
1/5																			

R404A/R507 · 115-127 V · 60 Hz

Compressor	Code number	Application	ASHRAE Capacity [BTU/h] Tc=130°F, Tliq=90°F, Tsuc=90°F Evaporating temperature [°F]						ASHRAE						Displacement [cu.in]	Voltage and frequencies [*dual frequency type with 50/60 Hz]	Compressor cooling cooling (refer to data sheet)				
			LBP rating point -10°F / 130°F		MBP rating point 20°F / 130°F		HBP rating point 45°F / 130°F		Cooling capacity		EER		Cooling capacity					EER			
			-31	-13	5	14	32	50	[BTU/h]	[BTU/Wh]	[BTU/h]	[BTU/Wh]	[BTU/h]	[BTU/Wh]				[BTU/h]	[BTU/Wh]	[BTU/h]	[BTU/Wh]
									[BTU/h]	[BTU/Wh]	[BTU/h]	[BTU/Wh]	[BTU/h]	[BTU/Wh]				[BTU/h]	[BTU/Wh]	[BTU/h]	[BTU/Wh]
TF4CLX	● 102U2102	L/MBP	340	642	1059	1320	1965	-	703	3.83	1302	4.77	-	-	0.24	103-135 V, 60 Hz	F2				
TFS4.5CLX	102U2115	LBP	477	852	1369	1692	-	927	4.07	-	-	-	-	0.28	103-135 V, 60 Hz	F2					
NF5.5CLX	105F1621	L/MBP	653	1147	1837	2271	3354	-	1247	4.20	2233	5.22	-	-	0.37	95-135 V, 60 Hz	F2				
NF7CLX	● 105F1721	L/MBP	776	1412	2300	2859	4254	-	1541	4.19	2819	5.33	-	-	0.44	95-135 V, 60 Hz	F2				
SC10CL	104L1503	L/MBP	443	1258	2388	3105	4914	-	1422	3.37	3135	4.86	-	-	0.63	103-127 V, 60 Hz	F2				
SC12CL	104L1603	LBP	771	2131	3744	4691	-	2378	3.78	-	-	-	-	0.79	103-127 V, 60 Hz	F2					
SC12CLX.2	● 104L1696	LBP	1036	2241	3771	4696	-	2470	3.89	4625	4.89	-	-	0.79	103-127 V, 60 Hz	F2					
SC12MLX	104L1606	MBP	-	-	3500	4409	6735	-	-	-	4386	5.20	-	-	0.79	95-135 V, 60 Hz	F2				
SC15CLX.2	● 104L1853	LBP	1409	2739	4564	5704	-	3005	4.12	5636	5.34	-	-	0.93	103-127 V, 60 Hz	F2					
SC15MLX	104L1805	MBP	-	-	4101	5165	7886	-	-	-	5136	4.80	-	-	0.93	95-135 V, 60 Hz	F2				
SC15MLX.2	104L1807	MBP	-	-	4212	5246	7892	-	-	-	5187	5.14	-	-	0.93	103-127 V, 60 Hz	F2				
SC18CLX.2	● 104L2198	LBP	1712	3393	5121	6156	-	3664	4.48	5974	5.31	-	-	1.08	103-127 V, 60 Hz	F2					
SC18MLX	● 104L2105	MBP	-	-	5191	6456	9691	-	-	-	6378	5.03	-	-	1.08	103-127 V, 60 Hz	F2				

Note: T-Series compressors will be phased out in 2025

R404A/R507 · 220-240 V · 50/60 Hz | 208-230 V · 60 Hz

Compressor	Code number	Application	ASHRAE Capacity [BTU/h] Tc=130°F, Tliq=90°F, Tsuc=90°F Evaporating temperature [°F]						ASHRAE						Displacement [cu.in]	Voltage and frequencies [*dual frequency type with 50/60 Hz]	Compressor cooling cooling (refer to data sheet)				
			LBP rating point -10°F / 130°F		MBP rating point 20°F / 130°F		HBP rating point 45°F / 130°F		Cooling capacity		EER		Cooling capacity					EER			
			-31	-13	5	14	32	50	[BTU/h]	[BTU/Wh]	[BTU/h]	[BTU/Wh]	[BTU/h]	[BTU/Wh]				[BTU/h]	[BTU/Wh]	[BTU/h]	[BTU/Wh]
									[BTU/h]	[BTU/Wh]	[BTU/h]	[BTU/Wh]	[BTU/h]	[BTU/Wh]				[BTU/h]	[BTU/Wh]	[BTU/h]	[BTU/Wh]
NF7MLX	● 105F3720	MBP	-	-	2260	2843	4291	-	-	-	2819	5.33	-	-	0.44	187-254 V, 60 Hz *	F2				
NL6.1MLX	● 105F3611	MBP	-	-	1853	2331	3518	-	-	-	2311	5.52	-	-	0.37	187-254 V, 60 Hz *	F2				
SC10CLX	104L2533	L/MBP	529	1576	2786	3489	-	1763	3.95	-	-	-	-	0.63	198-254 V, 60 Hz *	F2					
SC10MLX	● 104L2506	MBP	-	1620	2874	3650	5578	-	1805	3.91	3636	5.22	-	-	0.63	187-254 V, 60 Hz *	F2				
SC12CLX	104L2695	LBP	771	2131	3744	4691	-	2378	4.20	-	-	-	-	0.79	198-254 V, 60 Hz	F2					
SC12CLX.2	104L2699	LBP	1081	2187	3704	4652	-	2408	4.33	-	-	-	-	0.79	187-254 V, 60 Hz	F2					
SC12CLX.2	● 104L2697	LBP	1081	2187	3704	4652	-	2408	4.07	-	-	-	-	0.79	198-254 V, 60 Hz *	F2					
SC12MLX	● 104L2606	MBP	-	1998	3445	4339	6563	-	2212	4.02	4305	5.18	-	-	0.79	187-254 V, 60 Hz *	F2				
SC15CLX	104L2854	LBP	800	2360	4141	5179	-	2636	4.20	-	-	-	-	0.93	198-254 V, 60 Hz	F2					
SC15CLX.2	● 104L2897	LBP	1409	2739	4564	5704	-	3005	4.53	-	-	-	-	0.93	187-254 V, 60 Hz	F2					
SC15MLX.2	104L2803	MBP	-	-	4210	5243	7918	-	-	-	5188	5.32	-	-	0.93	187-254 V, 60 Hz	F2				
SC18CLX.2	104L2195	LBP	1774	3516	5306	6379	-	3797	4.76	-	-	-	-	1.08	187-254 V, 60 Hz	F2					
SC18MLX	104L2138	MBP	-	-	5191	6456	9691	-	-	-	6378	5.03	-	-	1.08	187-254 V, 60 Hz	F2				
SC12/12CLX	104L4034	LBP	1533	4240	7450	9334	-	4733	4.18	-	-	-	-	1.57	198-254 V, 60 Hz	F2					
GS21CLX	● 107B0506	LBP	1993	3902	6548	8216	-	4286	4.60	-	-	-	-	1.29	187-254 V, 60 Hz	F2					
GS21MLX	● 107B0509	MBP	-	4156	6973	8695	13036	-	4580	4.99	8587	6.34	-	-	1.29	187-254 V, 60 Hz	F2				
GS26CLX	107B0505	LBP	2453	4456	7216	8995	-	4854	4.14	-	-	-	-	1.60	187-254 V, 60 Hz	F2					

● Alternative refrigerant R452A, please refer to our data sheets

Electrical Equipment

Power [HP]	Dimensions						LST (RSIR & RSCR) refer to data sheet for more info					Run capacitor (RC)		HST (CSIR & CSCR) *alt. cable lengths avail.			LST/HST		
	Height [inch]		Connectors location/I.D. [inch]				PTC starting device		PTC starting device with RC connector		ePTC	→ optional → compulsory*		Starting relay	Starting capacitor	Starting device*	Cord relief	Cover	
	A	B	Suction C (I.D.)	Process D (I.D.)	Dis-charge E (I.D.)	alt. connectors available	Spades		Spades		Spades	Spades		Spades					
							1/4 inch	3/16 inch	1/4 inch	3/16 inch	3/16 inch	1/4 inch	3/16 inch	1/4 inch	1/4 inch	1/4 inch			
1/5	6.8	6.7	0.26	0.26	0.20	X	-	-	-	-	-	-	-	117U4148	117U5025	-	117U0349	117U1021	
1/4	6.8	6.7	0.26	0.26	0.26	X	-	-	-	-	-	-	-	117U4148	117U5025	-	-	-	
1/3	8.0	7.8	0.32	0.26	0.26	X	-	-	-	-	-	-	-	117U4061	117U5025	-	117U0349	117U1021	
1/2	7.8	7.5	0.32	0.26	0.26	X	-	-	-	-	-	-	-	117U4129	117U5022	-	117U0349	117U1021	
1/2	8.2	8.0	0.32	0.26	0.26	X	-	-	-	-	-	-	-	117U6020	117U5023	-	103N1004	103N2008	
3/4	8.2	8.0	0.32	0.26	0.26	X	-	-	-	-	-	-	-	117U6020	117U5023	-	103N1004	103N2008	
3/4	8.2	8.0	0.32	0.26	0.26	X	-	-	-	-	-	-	-	117U6020	117U5023	-	103N1004	103N2008	
3/4	8.6	8.4	0.32	0.26	0.26	-	-	-	-	-	-	-	117-7133	-	117-7441	117U5042	117-7053	-	117U1021
3/4	8.6	8.4	0.38	0.26	0.26	-	-	-	-	-	-	-	117-7114	-	117-7441	117U5043	117-7045	-	117U1021
3/4	8.6	8.4	0.38	0.26	0.26	-	-	-	-	-	-	-	117-7114	-	117-7441	117U5043	117-7045	-	117U1021
3/4	8.6	8.4	0.38	0.26	0.26	-	-	-	-	-	-	-	117-7114	-	117-7441	117U5043	117-7045	-	117U1021
1	8.6	8.4	0.38	0.26	0.26	X	-	-	-	-	-	-	117-7114	-	117-7441	117U5043	117-7045	-	117U1021
1	8.6	8.4	0.38	0.26	0.26	-	-	-	-	-	-	-	117-7114	-	117-7441	117U5043	117-7045	-	117U1021

Electrical Equipment

Power [HP]	Dimensions						LST (RSIR & RSCR) refer to data sheet for more info					Run capacitor (RC)		HST (CSIR & CSCR) *alt. cable lengths avail.			LST/HST	
	Height [inch]		Connectors location/I.D. [inch]				PTC starting device		PTC starting device with RC connector		ePTC	→ optional → compulsory*		Starting relay	Starting capacitor	Starting device*	Cord relief	Cover
	A	B	Suction C (I.D.)	Process D (I.D.)	Dis-charge E (I.D.)	alt. connectors available	Spades		Spades		Spades	Spades		Spades				
							1/4 inch	3/16 inch	1/4 inch	3/16 inch	3/16 inch	1/4 inch	3/16 inch	1/4 inch	1/4 inch	1/4 inch		
1/2	8.0	7.8	0.38	0.26	0.26	X	-	-	-	-	-	-	-	117U4139	117U5018	-	117U0349	117U1021
1/3	8.0	7.8	0.32	0.26	0.26	X	-	-	-	-	-	-	-	117U6022	117U5015	-	103N1010	103N2011
1/2	8.2	8.0	0.32	0.24	0.24	X	-	-	-	-	-	-	-	117U6005	117U5017	-	103N1004	103N2008
3/4	8.2	8.0	0.32	0.26	0.26	-	-	-	-	-	-	-	-	117U6011	117U5017	-	103N1004	103N2008
3/4	8.6	8.4	0.32	0.24	0.24	X	-	-	-	-	-	-	-	117U6019	117U5017	-	103N1004	103N2008
3/4	8.6	8.4	0.38	0.26	0.26	X	-	-	-	-	-	-	-	-	-	117-7027	103N1004	103N2008
3/4	8.6	8.4	0.32	0.24	0.24	X	-	-	-	-	-	-	-	117U6019	117U5017	-	103N1004	103N2008
3/4	8.6	8.4	0.32	0.26	0.26	-	-	-	-	-	-	-	-	117U6011	117U5017	-	103N1004	103N2008
3/4	8.6	8.4	0.40	0.24	0.24	-	-	-	-	-	-	-	-	-	117U5373	117-7039	103N1004	103N2008
3/4	8.6	8.4	0.38	0.26	0.26	X	-	-	-	-	-	-	-	-	117U5373	117-7039	103N1004	103N2008
3/4	8.6	8.4	0.38	0.26	0.26	-	-	-	-	-	-	-	-	-	-	117-7058	103N1004	103N2008
1	8.6	8.4	0.38	0.26	0.26	X	-	-	-	-	-	-	-	-	117U5373	117-7066	103N1004	103N2008
1	8.6	8.4	0.38	0.26	0.26	-	-	-	-	-	-	-	-	-	-	117-7066	103N1004	103N2008
1 1/4	10.2	10.0	0.47	0.24	0.24	-	-	-	-	-	-	-	-	117U6019	117U5017	-	103N1004	103N2009
1 1/4	10.2	9.7	0.51	0.26	0.32	-	-	-	-	-	-	-	-	-	-	117-7073	-	107B9101
1 1/4	11.0	10.5	0.51	0.26	0.38	-	-	-	-	-	-	-	-	-	-	117-7073	-	107B9106
1 1/4	11.0	10.5	0.51	0.26	0.32	-	-	-	-	-	-	-	-	-	-	117-7073	-	107B9101



R600a · 115-127 V · 60 Hz

Compressor	Code number	Application	ASHRAE Capacity [BTU/h] Tc=130°F, Tliq=90°F, Tsuc=90°F Evaporating temperature [°F]						ASHRAE						Displacement [cu.in.]	Voltage and frequencies [*dual frequency type with 50/60 Hz]	Compressor cooling (refer to data sheet)		
			LBP rating point -10°F / 130°F		MBP rating point 20°F / 130°F		HBP rating point 45°F / 130°F		Cooling capacity		EER		Cooling capacity					EER	
			-31	-13	5	14	32	50	[BTU/h]	[BTU/Wh]	[BTU/h]	[BTU/Wh]	[BTU/h]	[BTU/Wh]				[BTU/h]	[BTU/Wh]
NLE11KTK	105H5942	L/MBP	360	602	1059	1342	1959	-	665	4.18	1390	5.70	-	-	0.68	95-135 V, 60 Hz	F1		
NLE13KTK	105H5949	L/MBP	415	707	1182	1487	2227	-	773	4.13	1545	5.52	-	-	0.81	95-135 V, 60 Hz	F1		

Electrical Equipment

Power [HP]	Dimensions						LST (RSIR & RSCR) refer to data sheet for more info					Run capacitor (RC)		HST (CSIR & CSCSR) *alt. cable lengths avail.			LST/HST	
	Height [inch]		Connectors location/I.D. [inch]				PTC starting device		PTC starting device with RC connector		ePTC	→ optional → compulsory*		Starting relay	Starting capacitor	Starting device*	Cord relief	Cover
	A	B	Suction C (I.D.)		Process D (I.D.)		Dis-charge E (I.D.)		alt. connectors available	Spades		Spades		Spades				
1/6	7.8	7.5	0.32	0.26	0.26	-	103N0026	103N0023	103N0027	103N0024	-	117-7118	117-7120	-	-	-	103N1010	103N2011
1/5	7.8	7.5	0.32	0.26	0.26	-	103N0026	103N0023	103N0027	103N0024	-	117-7118	117-7120	-	-	-	103N1010	103N2011

R290 · 115-127 V · 60 Hz

Compressor	Code number	Application	ASHRAE Capacity [BTU/h] Tc=130°F, Tliq=90°F, Tsuc=90°F Evaporating temperature [°F]						ASHRAE						Displacement [cu.in.]	Voltage and frequencies [*dual frequency type with 50/60 Hz]	Compressor cooling (refer to data sheet)		
			LBP rating point -10°F / 130°F		MBP rating point 20°F / 130°F		HBP rating point 45°F / 130°F		Cooling capacity		EER		Cooling capacity					EER	
			-31	-13	5	14	32	50	[BTU/h]	[BTU/Wh]	[BTU/h]	[BTU/Wh]	[BTU/h]	[BTU/Wh]				[BTU/h]	[BTU/Wh]
TL4CNX.2	102H3490	L/MBP	365	664	1058	1305	1929	-	722	4.31	1336	6.12	-	-	0.24	95-135 V, 60 Hz	F2		
KLF4.0CNH	106H3401	L/MBP	376	715	1142	1402	2043	-	779	5.08	1429	7.13	-	-	0.24	95-135 V, 60 Hz	F2		
KLF4.0CNHS	106H3403	L/MBP	363	690	1101	1352	1971	-	751	4.96	1379	6.96	-	-	0.24	95-135 V, 60 Hz	F2		
KLF4.8CNH	106H3500	L/MBP	534	878	1380	1698	2484	-	950	5.31	1734	7.07	-	-	0.29	95-135 V, 60 Hz	F2		
KLF4.8CNHS	106H3503	L/MBP	516	847	1332	1639	2397	-	916	5.18	1674	6.89	-	-	0.29	95-135 V, 60 Hz	F2		
KLF5.6CNH	106H3601	L/MBP	659	1071	1669	2044	2956	-	1157	5.49	2080	7.19	-	-	0.34	95-135 V, 60 Hz	F2		
KLF5.6CNHS	106H3603	L/MBP	635	1033	1610	1972	2852	-	1116	5.35	2006	7.01	-	-	0.34	95-135 V, 60 Hz	F2		
KLF6.6CNH	106H3700	L/MBP	765	1254	1957	2402	3505	-	1355	5.51	2450	7.08	-	-	0.40	95-135 V, 60 Hz	F2		
KLF6.6CNHS	106H3703	L/MBP	738	1210	1889	2318	3382	-	1308	5.37	2364	6.91	-	-	0.40	95-135 V, 60 Hz	F2		
KLF7.7CNH	106H3802	L/MBP	945	1507	2315	2827	4099	-	1626	5.53	2873	7.02	-	-	0.47	95-135 V, 60 Hz	F2		
KLF7.7CNHS	106H3803	L/MBP	852	1401	2161	2638	3823	-	1514	5.10	2680	6.64	-	-	0.47	95-135 V, 60 Hz	F2		
NL7.3CNX.2	105H6790	L/MBP	831	1329	2085	2568	3759	-	1436	4.89	2624	6.68	-	-	0.44	95-135 V, 60 Hz	F2		
NL8.4CNX.2	105H6090	L/MBP	909	1534	2384	2919	4259	-	1658	5.01	2975	6.55	-	-	0.51	95-135 V, 60 Hz	F2		
NLE8.0CN	105H6093	L/MBP	831	1431	2214	2705	3952	-	1546	5.36	2756	7.08	-	-	0.49	95-135 V, 60 Hz	F2		
NLE8.8CN	105H6094	L/MBP	1007	1621	2518	3076	4424	-	1751	5.37	3125	7.11	-	-	0.53	95-135 V, 60 Hz	F2		
NLE10CN	105H6194	L/MBP	1184	1921	2962	3604	5145	-	2073	5.20	3651	6.98	-	-	0.62	103-127 V, 60 Hz	F2		
NLE12.6CNS	105H6392	L/MBP	1250	2348	3719	4524	6410	8712	2556	5.47	4575	6.76	7175	8.67	0.77	103-135 V, 60 Hz	F2		
NLE11CNL	105H5981	LBP	1306	2118	3297	4006	-	-	2291	5.54	-	-	-	-	0.68	95-135 V, 60 Hz	F2		
NLE11MN	105H5980	MBP	-	2104	3331	4055	5790	8007	2292	5.24	4106	6.97	6558	9.38	0.68	95-127 V, 60 Hz	F2		
NLY10CN	105H6164	L/MBP	1227	1875	2923	3586	5167	-	2023	5.46	3649	7.33	-	-	0.62	95-135 V, 60 Hz	F2		
SC10CNX.2	104H7070	L/MBP	531	1361	2480	3172	4868	-	1525	3.98	3302	6.38	-	-	0.63	95-135 V, 60 Hz	F2		
SC12CNX.2	104H7270	L/MBP	961	1902	3171	3955	5876	-	2088	4.40	4065	6.39	-	-	0.79	95-135 V, 60 Hz	F2		
SC15MNX	104H7570	MBP	-	2070	3945	4772	6744	-	2429	4.25	4795	6.04	-	-	0.93	100-127 V, 60 Hz	F2		
SC18MNX	104H7870	MBP	-	2838	4415	5343	7780	-	3090	4.65	5419	6.22	-	-	1.08	103-127 V, 60 Hz	F2		
SCE15CNLX	104H7578	LBP	966	2467	4169	5158	-	-	2731	5.38	5269	7.36	-	-	0.93	103-127 V, 60 Hz	F2		
SCE18CNLX	104H7878	LBP	1257	2937	4824	6010	-	-	3223	5.56	6209	7.36	-	-	1.08	103-127 V, 60 Hz	F2		
SCE21CNLX	104H7178	LBP	1615	3397	5530	6824	-	-	3720	5.47	6981	7.12	-	-	1.28	103-127 V, 60 Hz	F2		
SCE15MNX	104H7579	MBP	-	-	4073	5099	7534	-	-	-	5241	6.99	-	-	0.93	103-127 V, 60 Hz	F2		
SCE18MNX	104H7879	MBP	-	-	4854	6013	8728	-	-	-	6134	7.26	-	-	1.08	103-127 V, 60 Hz	F2		

Electrical Equipment

Power [HP]	Dimensions						LST (RSIR & RSCR) refer to data sheet for more info					Run capacitor (RC)		HST (CSIR & CSCSR) *alt. cable lengths avail.			LST/HST			
	Height [inch]		Connectors location/I.D. [inch]				PTC starting device		PTC starting device with RC connector		ePTC	→ optional → compulsory*		Starting relay	Starting capacitor	Starting device*	Cord relief	Cover		
	A	B	Suction C (I.D.)		Process D (I.D.)		Dis-charge E (I.D.)		alt. connectors available	Spades		Spades		Spades						
1/6	6.8	6.7	0.26	0.26	0.20	-	-	-	-	-	-	-	-	-	-	117U7005	117U5023	-	103N1010	103N2011
1/5	7.2	6.9	0.32	0.26	0.26	-	-	-	103N0210	-	-	-	117-7153*	-	-	117U7074	117U5002	--	16058100	10636401
1/5	7.2	6.9	0.32	0.26	0.26	-	-	-	-	-	-	-	-	-	-	117U7074	117U5002	--	16058100	10636401
1/4	7.2	6.9	0.32	0.26	0.26	-	-	-	103N0212	-	-	-	117-7153*	-	-	117U7072	117U5002	--	16058100	10636401
1/4	7.2	6.9	0.32	0.26	0.26	-	-	-	-	-	-	-	-	-	-	117U7072	117U5002	--	16058100	10636401
1/4+	7.2	6.9	0.32	0.26	0.26	-	-	-	103N0212	-	-	-	117-7153*	-	-	117U7075	117U5002	--	16058100	10636401
1/4+	7.2	6.9	0.32	0.26	0.26	-	-	-	-	-	-	-	-	-	-	117U7075	117U5002	--	16058100	10636401
1/3	7.2	7.5	0.32	0.26	0.26	-	-	-	103N0212	-	-	-	117-7153*	-	-	117U7076	117U5002	--	16058100	10636401
1/3	7.2	6.9	0.32	0.26	0.26	-	-	-	-	-	-	-	-	-	-	117U7076	117U5002	--	16058100	10636401
1/3+	7.2	6.9	0.32	0.26	0.26	-	-	-	103N0214	-	-	-	117-7153*	-	-	117U7078	117U5002	--	16058100	10636401
1/3+	7.2	6.9	0.32	0.26	0.26	-	-	-	-	-	-	-	-	-	-	117U7078	117U5002	--	16058100	10636401
1/2	8.0	7.8	0.32	0.26	0.26	X	-	-	-	-	-	-	-	-	-	117U7013	117U5035	-	103N1010	103N2011
1/2	8.0	7.8	0.32	0.26	0.26	X	-	-	-	-	-	-	-	-	-	117U7013	117U5035	-	103N1010	103N2011
2/5	8.0	7.8	0.32	0.26	0.26	X	-	-	-	-	103N0058	117-7147	117-7146	-	-	117U7013	117U5023	-	103N1010	103N2011
1/2	8.0	7.8	0.32	0.26	0.26	X	-	-	-	-	103N0058	117-7114	-	-	-	117U7014	117U5025	-	103N1010	103N2011
3/5	8.0	7.8	0.32	0.26	0.26	X	-	-	-	-	103N0058	117-7118	117-7120	-	-	117U7018	117U5025	-	103N1010	103N2011
3/4	8.0	7.8	0.32	0.26	0.26	-	-	-	-	-	-	-	-	-	-	117U7023	117U5039	-	103N1010	103N2010
2/3	8.0	7.8	0.32	0.26	0.26	X	-	-	-	-	103N0058	117-7114	-	-	-	117U7020	117U5039	-	103N1010	-
2/3	8.0	7.8	0.32	0.26	0.26	X	-	-	-	-	103N0058	117-7114	-	-	-	117U7020	117U5023	-	103N1010	-
1/2	8.0	7.8	0.32	0.26	0.26	X	-	-	-	-	-	117-7118	117-7120	-	-	117U7020	117U5035	-	103N1010	103N2011
1/2	8.2	8.0	0.38	0.26	0.26	-	-	-	-</											

R600a · 220-240 V · 50/60 Hz

Compressor	Code number	Application	ASHRAE Capacity [BTU/h] Tc=130°F, Tliq=90°F, Tsuc=90°F Evaporating temperature [°F]						ASHRAE						Displacement [cu.in.]	Voltage and frequencies [*dual frequency type with 50/60 Hz]	Compressor cooling cooling (refer to data sheet)		
			LBP rating point -10°F / 130°F		MBP rating point 20°F / 130°F		HBP rating point 45°F / 130°F		Cooling capacity		EER		Cooling capacity					EER	
			-31	-13	5	14	32	50	[BTU/h]	[BTU/Wh]	[BTU/h]	[BTU/Wh]	[BTU/h]	[BTU/Wh]				[BTU/h]	[BTU/Wh]
NLE9KTK	105H6071	LBP	262	473	801	1022	-	-	519	4.41	-	-	-	-	0.51	198-253 V, 60 Hz *	S		

Electrical Equipment

Power [HP]	Dimensions						LST (RSIR & RSCR) refer to data sheet for more info			Run capacitor (RC)		HST (CSIR & CSCSR) *alt. cable lengths avail.			LST/HST			
	Height [inch]		Connectors location/I.D. [inch]				PTC starting device		PTC starting device with RC connector	ePTC	→ optional → compulsory*		Starting relay	Starting capacitor	Starting device*	Cord relief	Cover	
	A	B	C (I.D.)	D (I.D.)	E (I.D.)	alt. connectors available	Spades		Spades		Spades	Spades		Spades		Spades	Cover	
							1/4 inch	3/16 inch	1/4 inch	3/16 inch	3/16 inch	1/4 inch	3/16 inch	1/4 inch	1/4 inch	1/4 inch		
1/8	7.8	7.5	0.24	0.24	0.20	X	103N0011	103N0018	103N0016	103N0021	-	117-7117	117-7119	-	-	-	103N1010	103N2010

K-Series AT · R600a · 200-240 V · 50/60 Hz

Compressor	Code number	Application	ASHRAE Capacity [BTU/h] Tc=130°F, Tliq=90°F, Tsuc=90°F Evaporating temperature [°F]						ASHRAE						Displacement [cu.in.]	Voltage and frequencies [*dual frequency type with 50/60 Hz]	Compressor cooling cooling (refer to data sheet)		
			LBP rating point -10°F / 130°F		MBP rating point 20°F / 130°F		HBP rating point 45°F / 130°F		Cooling capacity		EER		Cooling capacity					EER	
			-31	-13	5	14	32	50	[BTU/h]	[BTU/Wh]	[BTU/h]	[BTU/Wh]	[BTU/h]	[BTU/Wh]				[BTU/h]	[BTU/Wh]
HXK80AT	CDO00135	LBP	291	526	851	1054	-	-	573	6.04	-	-	-	-	0.49	198-253 V, 60 Hz *	S		
HXK87AT	CDO00136	LBP	365	577	934	1158	-	-	627	6.04	-	-	-	-	0.54	198-253 V, 60 Hz *	S		
HXK95AT	CDO00137	LBP	399	630	1020	1265	-	-	685	6.04	-	-	-	-	0.59	198-253 V, 60 Hz *	S		
HXK12AT	CDO00219	LBP	468	741	1196	1492	-	-	805	5.97	-	-	-	-	0.68	198-253 V, 60 Hz *	S		

Electrical Equipment · Spare Parts · Accessories

Power [HP]	Dimensions						Run capacitor		Terminal board		Terminal board		Cable clamp	Cover	Evaporation tray	All-in-one equipment
	Height [mm]		Connectors location [mm]				→ optional → compulsory*		→ PTC → external protector		→ ePTC → external protector		screws not included	V0	plastic	→ cover → cable clamp + screws → earthing screw
	A	B	C (I.D.)	D (I.D.)	E (I.D.)	alt. connectors available	Spades		Spades		Spades			material optional		
							3/16 1/4 inch	3/16 inch	1/4 inch	1/4 inch	3/16 inch					
1/6	6.6	-	0.24	0.24	0.20	X	4 µF	ZCF5	DCF5	-	-	113410_	196364_	162991_	161680_	
1/5	6.6	-	0.24	0.24	0.20	X	4 µF	ZCFC	DCFC	-	-	113410_	196364_	162991_	161680_	
1/4	6.6	-	0.24	0.24	0.20	X	4 µF	ZCFP	DCFP	-	-	113410_	196364_	162991_	161680_	
1/3	6.6	-	0.24	0.24	0.20	X	4 µF	ZCF9	DCF9	-	-	113410_	196364_	162991_	161680_	

R290 · 220-240 V · 50/60 Hz | 208-230 V · 60 Hz

Compressor	Code number	Application	ASHRAE Capacity [BTU/h] Tc=130°F, Tliq=90°F, Tsuc=90°F Evaporating temperature [°F]						ASHRAE						Displacement [cu.in.]	Voltage and frequencies [*dual frequency type with 50/60 Hz]	Compressor cooling cooling (refer to data sheet)		
			LBP rating point -10°F / 130°F		MBP rating point 20°F / 130°F		HBP rating point 45°F / 130°F		Cooling capacity		EER		Cooling capacity					EER	
			-31	-13	5	14	32	50	[BTU/h]	[BTU/Wh]	[BTU/h]	[BTU/Wh]	[BTU/h]	[BTU/Wh]				[BTU/h]	[BTU/Wh]
KLF4.8CNT	106H2502	L/MBP	547	899	1413	1739	2542	-	972	5.38	1775	7.13	-	-	0.29	187-254 V, 60 Hz *	F2		
KLF5.6CNT	106H2602	L/MBP	655	1048	1644	2021	2945	-	1133	5.39	2063	7.05	-	-	0.34	187-254 V, 60 Hz *	F2		
NLE8.0CNT	105H6073	L/MBP	730	1380	2207	2710	3949	-	1504	5.18	2763	6.96	-	-	0.49	187-242 V, 60 Hz *	F2		
NLE8.8CNT	105H6088	L/MBP	941	1609	2518	3076	4425	-	1743	5.32	3124	6.99	-	-	0.53	187-253 V, 60 Hz	F2		
NLE10CNT	105H6179	L/MBP	1096	1909	2983	3632	5185	-	2069	5.57	3680	7.17	-	-	0.62	187-242 V, 60 Hz *	F2		
NLE11CNLT	105H6109	LBP	1421	2106	3342	4074	-	2282	5.64	-	-	-	-	0.68	187-253 V, 60 Hz	F2			
NLE11MNT	105H6199	MBP	-	-	3293	3981	5647	-	-	-	4020	6.89	-	-	0.68	187-253 V, 60 Hz	F2		
SC18CNLX.2	104H8877	LBP	1559	2922	4327	5184	-	3142	4.96	5238	6.55	-	-	1.08	198-254 V, 60 Hz	F2			
SC21CNLX.2	104H8177	LBP	1945	3614	5297	6305	-	3880	4.95	6342	6.07	-	-	1.28	198-254 V, 60 Hz	F2			
SCE15CNLX	104H8577	LBP	848	2343	4132	5177	-	2617	5.58	5317	7.74	-	-	0.93	187-253 V, 60 Hz	F2			
SCE15CNLX	104H8588	LBP	852	2330	4113	5153	-	2603	5.03	5292	6.89	-	-	0.93	187-253 V, 60 Hz	F2			
SCE18CNLX	104H8878	LBP	1016	2775	4894	6130	-	3099	5.71	6294	7.87	-	-	1.08	187-253 V, 60 Hz	F2			
SCE18CNLX	104H8888	LBP	1502	2933	4730	5815	-	3203	5.13	5928	6.59	-	-	1.08	187-253 V, 60 Hz	F2			
SCE21CNLX	104H8173	LBP	1794	3431	5618	6957	-	3754	5.62	7118	7.30	-	-	1.28	187-253 V, 60 Hz	F2			
SCE21CNLX	104H8174	LBP	1742	3351	5513	6835	-	3670	5.18	6997	6.68	-	-	1.28	198-253 V, 60 Hz	F2			
SCE15MNX	104H8579	MBP	-	-	4166	5182	7600	-	-	-	5306	7.70	-	-	0.93	187-253 V, 60 Hz	F2		
SCE15MNX	104H8589	MBP	-	-	4123	5122	7498	-	-	-	5240	6.94	-	-	0.93	187-253 V, 60 Hz	F2		
SCE18MNX	104H8879	MBP	-	-	4883	6036	8770	-	-	-	6158	7.53	-	-	1.08	187-253 V, 60 Hz	F2		
SCE18MNX	104H8889	MBP	-	-	4869	6014	8730	-	-	-	6133	6.71	-	-	1.08	187-253 V, 60 Hz	F2		

Electrical Equipment

Power [HP]	Dimensions						LST (RSIR & RSCR) refer to data sheet for more info			Run capacitor (RC)		HST (CSIR & CSCSR) *alt. cable lengths avail.			LST/HST			
	Height [inch]		Connectors location/I.D. [inch]				PTC starting device		PTC starting device with RC connector	ePTC	→ optional → compulsory*		Starting relay	Starting capacitor	Starting device*	Cord relief	Cover	
	A	B	C (I.D.)	D (I.D.)	E (I.D.)	alt. connectors available	Spades		Spades		Spades	Spades		Spades		Spades	Cover	
							1/4 inch	3/16 inch	1/4 inch	3/16 inch	3/16 inch	1/4 inch	3/16 inch	1/4 inch	1/4 inch	1/4 inch		
1/4	7.1	6.9	0.32	0.24	0.24	X	-	-	103N0251	-	-	117-7155	-	117U7070	117U5003	-	16058100	10636401
1/3	7.1	6.9	0.32	0.24	0.24	X	-	-	103N0256	-	-	117-7155	-	117U7077	117U5003	-	16058100	10636401
1/3+	8.0	7.8	0.32	0.26	0.26	-	-	-	-	-	103N0050	-	117-7119	117U7003	117U5014	-	103N1010	103N2011
1/3+	8.0	7.8	0.32	0.26	0.26	-	-	-	-	-	103N0050	-	117-7119	117U7022	117U5381	-	103N1010	103N2011
1/2	8.0	7.8	0.32	0.26	0.26	-	-	-	-	-	103N0050	-	117-7119	117U7050	117U5014	-	103N1010	103N2011
1/2+	8.0	7.8	0.32	0.26	0.26	-	-	-	-	-	103N0050	-	117-7165	117U7005	117U5014	-	103N1010	103N2011
2/3	8.0	7.8	0.32	0.26	0.26	-	-	-	-	-	103N0050	-	117-7119	117U7050	117U5014	-	103N1010	103N2011
3/4+	8.6	8.4	0.38	0.26	0.26	-	-	-	-	-	-	-	-	117U5373	117-7039	103N1004	103N2008	
1	8.6	8.4	0.38	0.26	0.26	-	-	-	-	-	-	-	-	117U5373	117-7066	103N1004	103N2008	
2/3	8.6	8.4	0.38	0.26	0.26	-	-	-	-	-	-	117U7121 *	-	117-7602	117U5373	117-7809	-	117U1021
2/3	8.6	8.4	0.38	0.26	0.26	-	-	-	-	-	-	-	-	117U7413	117U5076	-	-	117U1021
3/4	8.6	8.4	0.38	0.26	0.26	X	-	-	-	-	-	117U7121 *	-	117-7602	117U5373	117-7809	-	117U1021
3/4+	8.6	8.4	0.38	0.26	0.26	X	-	-	-	-	-	-	-	117U7413	117U5076	-	-	117U1021
1	8.6	8.4	0.38	0.26	0.26	-	-	-	-	-	-	117U7121 *	-	117-7603	117U5373	117-7811	-	117U1021
2/3	8.6	8.4	0.38	0.26	0.26	-	-	-	-	-	-	-	-	117U7407	117U5076	-	-	117U1021
2/3	8.6	8.4	0.38	0.26	0.26	-	-	-	-	-	-	117U7121 *	-	117-7601	117U5373	117-7808	-	117U1021
2/3	8.6	8.4	0.38	0.26	0.26	-	-	-	-	-	-	-	-	117U7401	117U5076	-	-	117U1021
3/4+	8.6	8.4	0.38	0.26	0.26	X	-	-	-	-	-	117U7121 *	-	117-7445	117U5373	117-7807	-	117U1021
3/4+	8.6	8.4	0.38	0.26	0.26	X	-	-	-	-	-	-	-	117U7412	117U5076	-	-	117U1021



PL

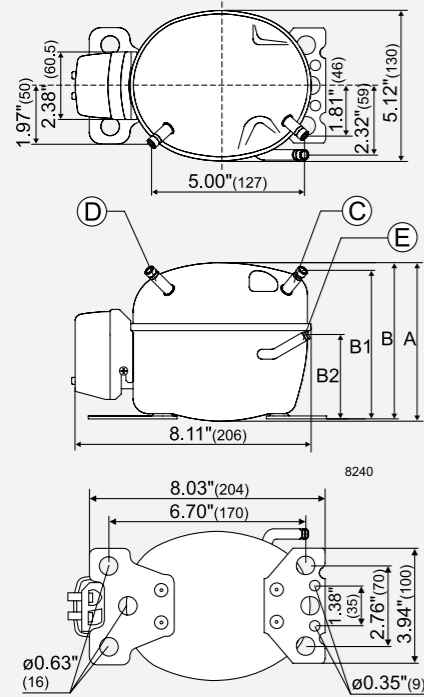

Note:
Please refer to data sheets for heights B1 and B2

TF/TFS

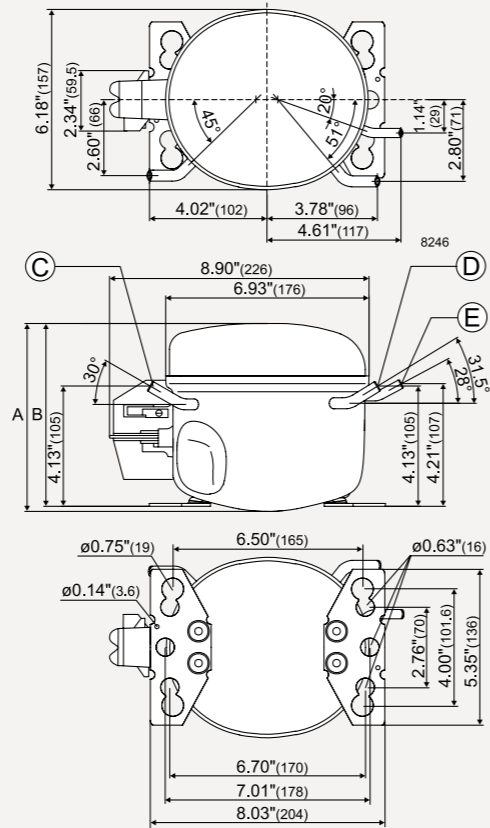

TL

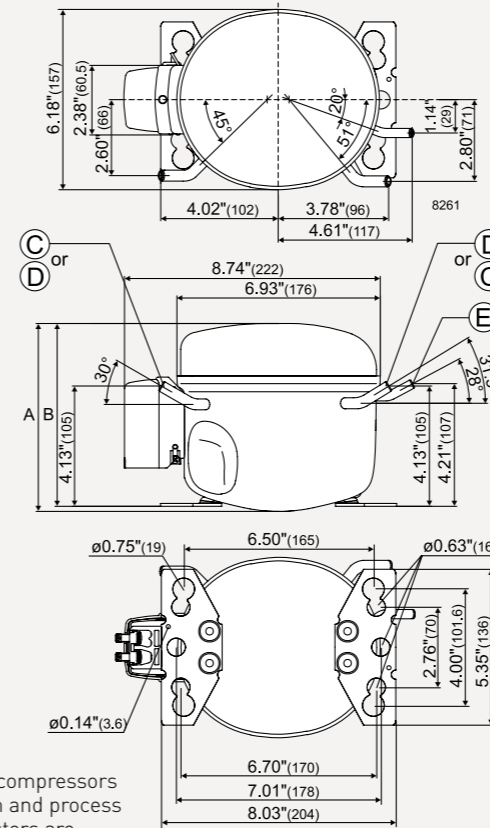

Note:
On TL compressors suction and process connectors are interchangeable.

NF

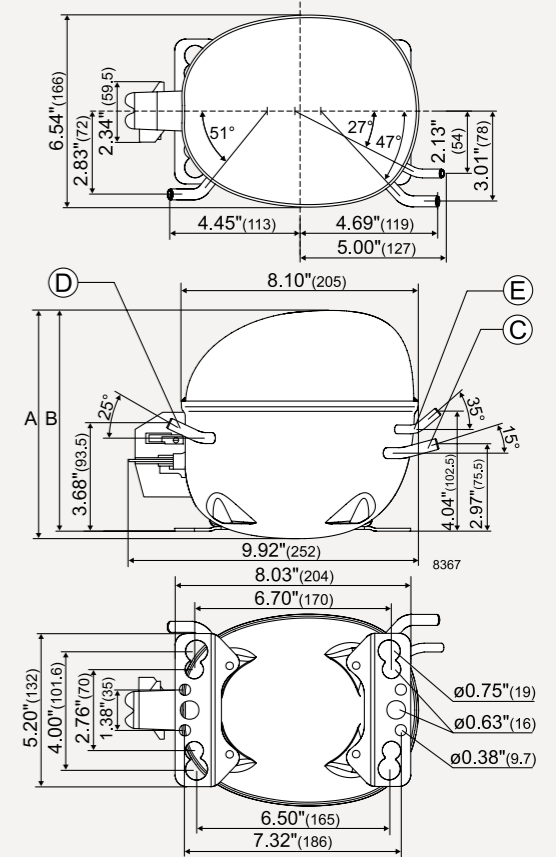

HXK (K-Series)

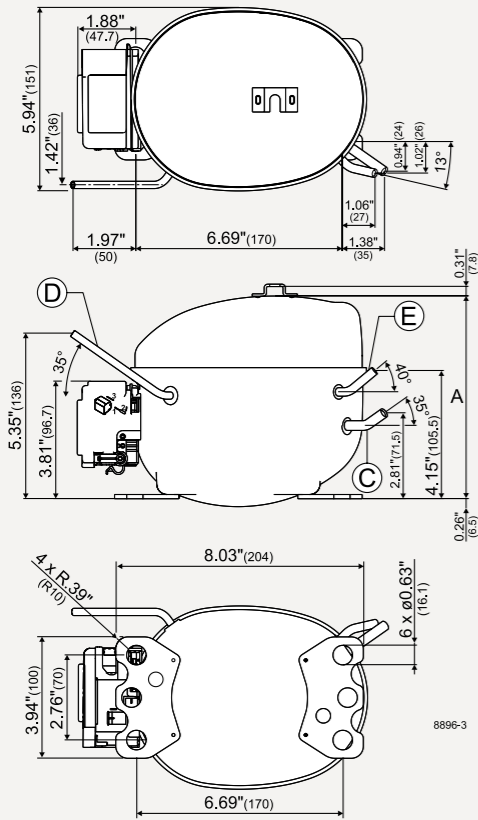

KLE/KLF (KL-Series)/FRK

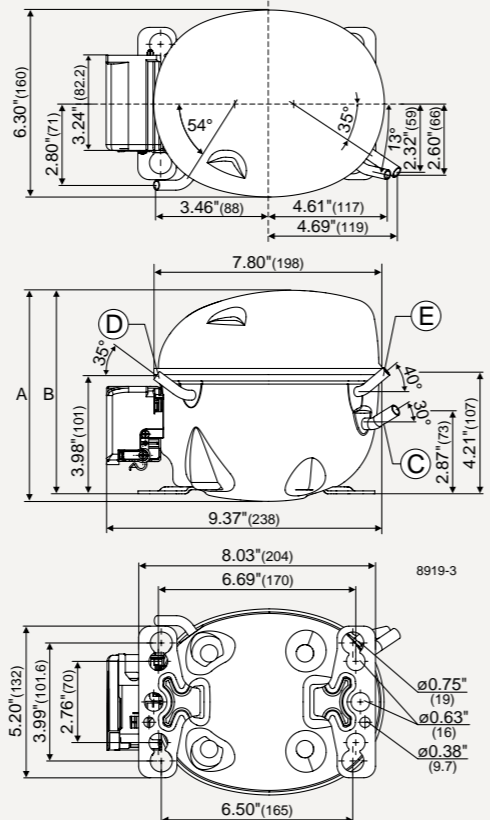

NL (NLE similar)

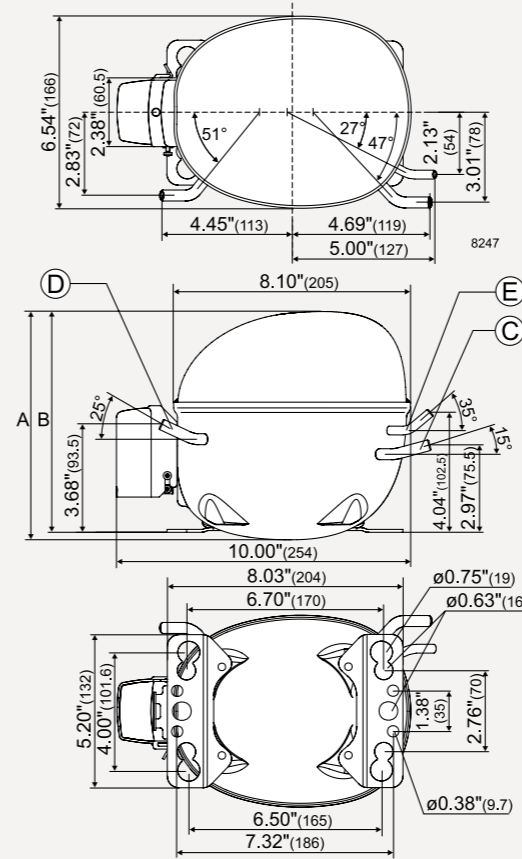

NLE (R290)

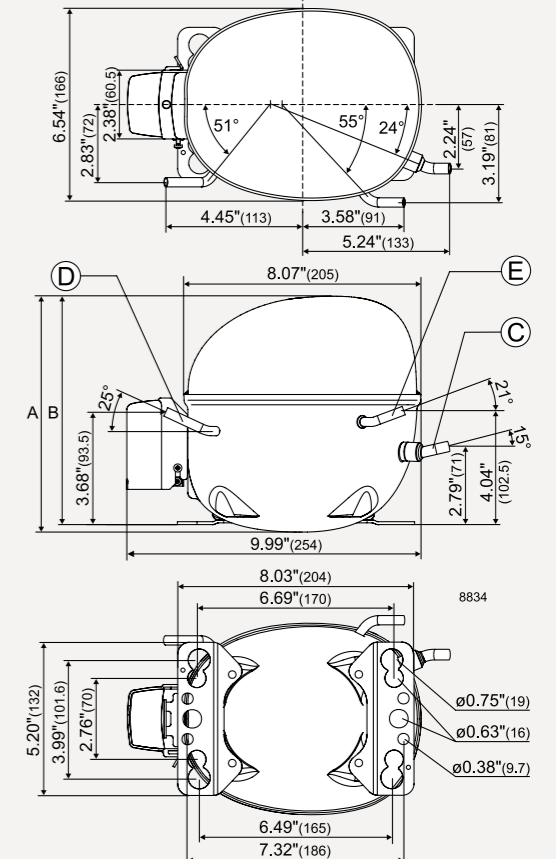

SC (external protector)

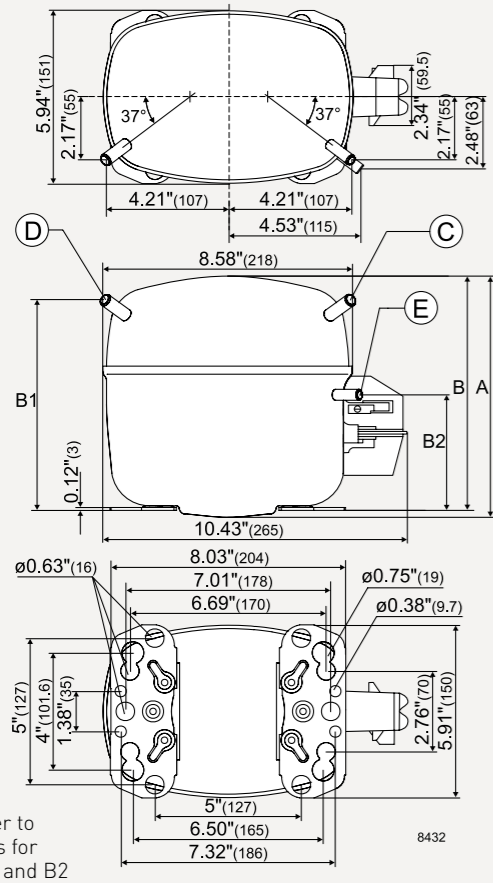

SCE (external protector)

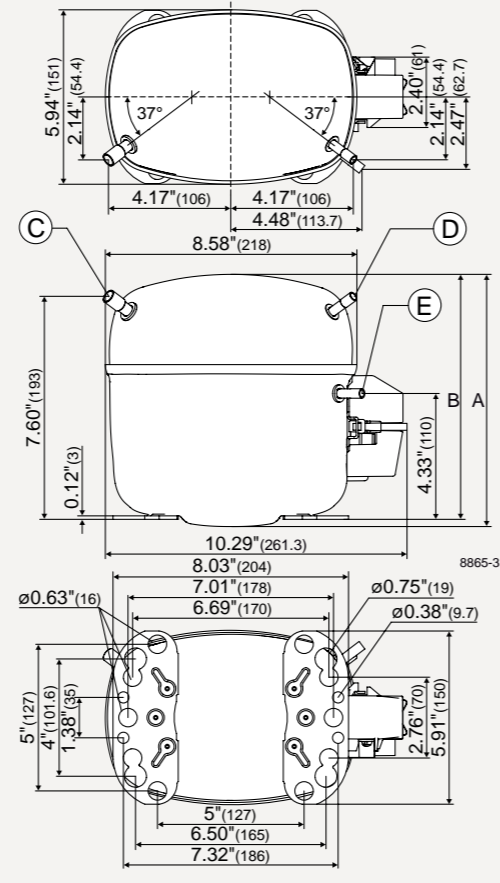

SC Twin

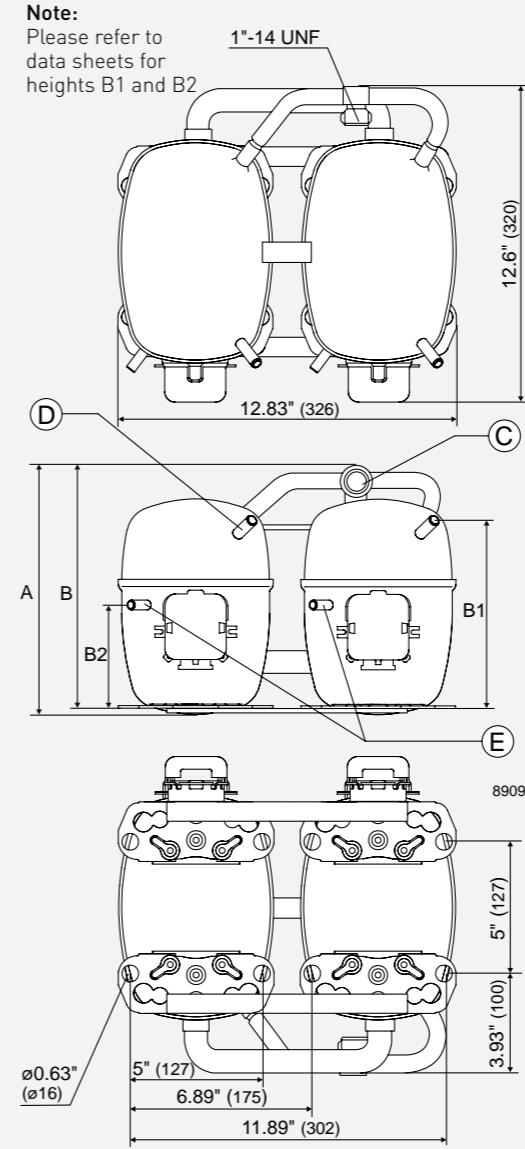

HST - CSIR

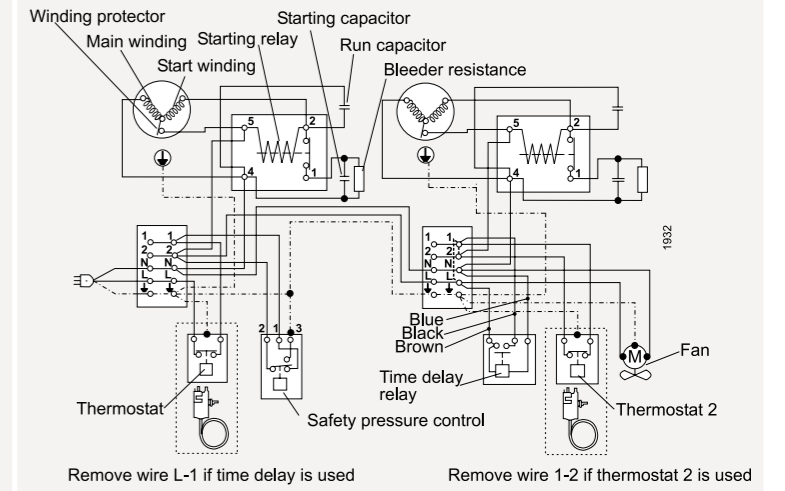

HST - CSCR

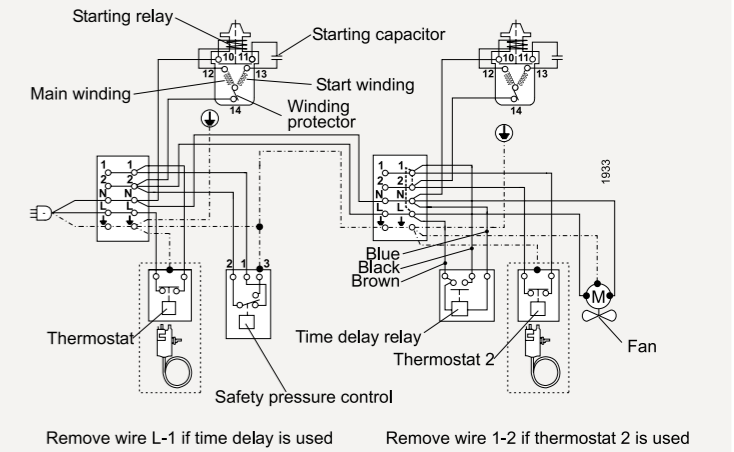

SC

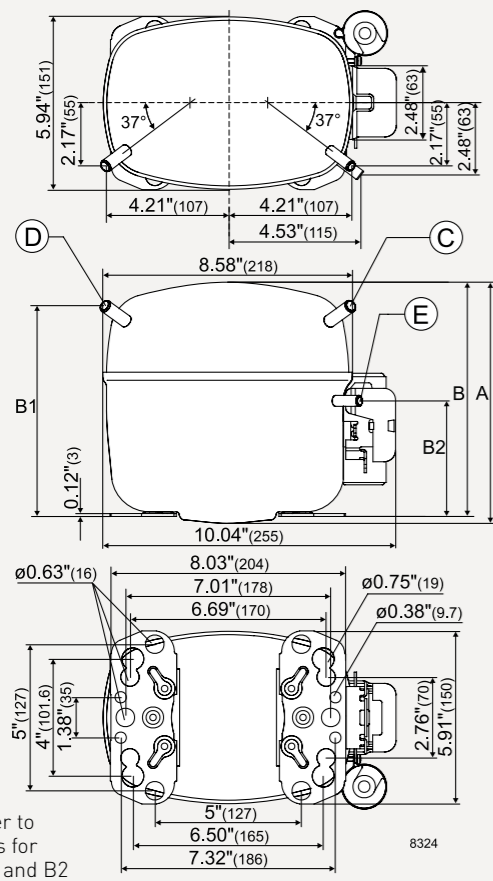

GS

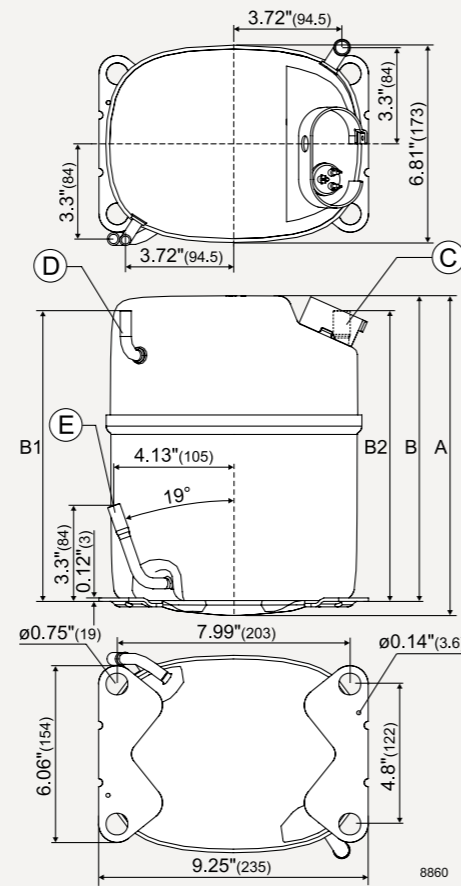

HXK-AT (external protector)

LST - RSIR

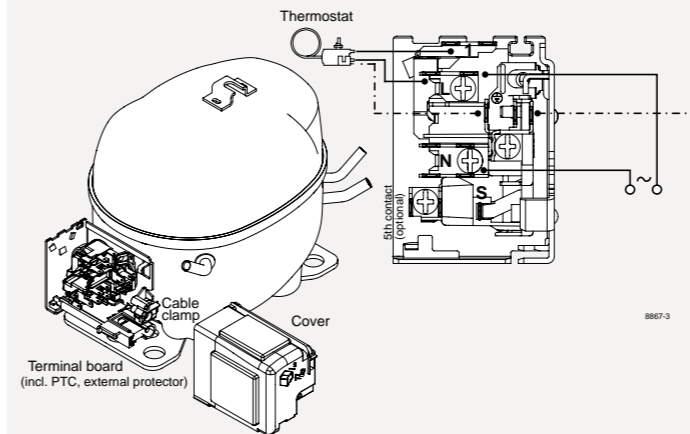

LST - RSCR

