



FERMOD®

This notice includes the mounting installation, and the maintenance instructions.
We advise you to read this carefully and to place it at the user's disposal.

FASTENER 430 - 431



0497
EN 179:2008

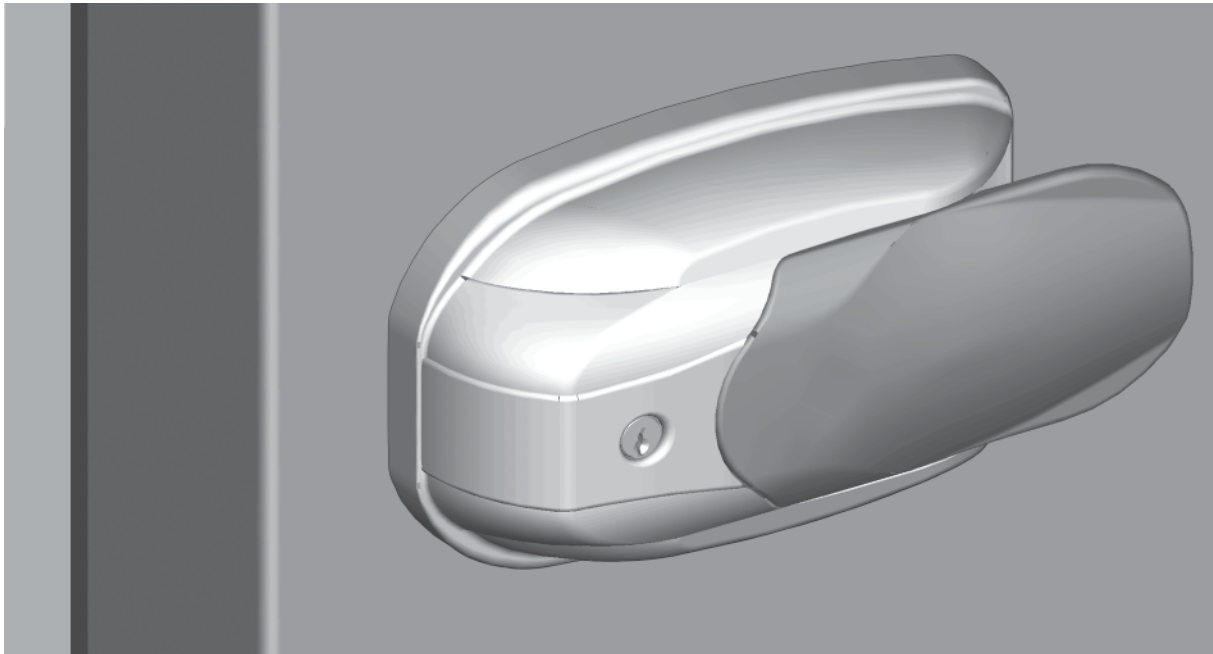

Summary

1 - Space requirement	p 2
2 - Product features	p 3
3 - Transport	p 3
4 - Storage	p 3
5 - Mounting	
5.1 - door drilling	
5.2 - rod and tubes cutting	p 3/6
5.3 - Assembly	
5.4 - Drilling and assembly	
5.5 - Cover mounting/dismounting	
6 - Scrapping	p 7
7 - Attestation of conformity CE	p 7

The english version of our general conditions of sales and mounting instructions are not binding, and are only given for information purposes. Only the french version can be used in case of legal action.

FERMOD S.A. - 75, rue de Richelieu - 75002 PARIS (FRANCE)
Tél. :(33) 01 42 96 94 06 - Fax :(33) 01 42 86 84 51

1 - SPACE REQUIREMENT

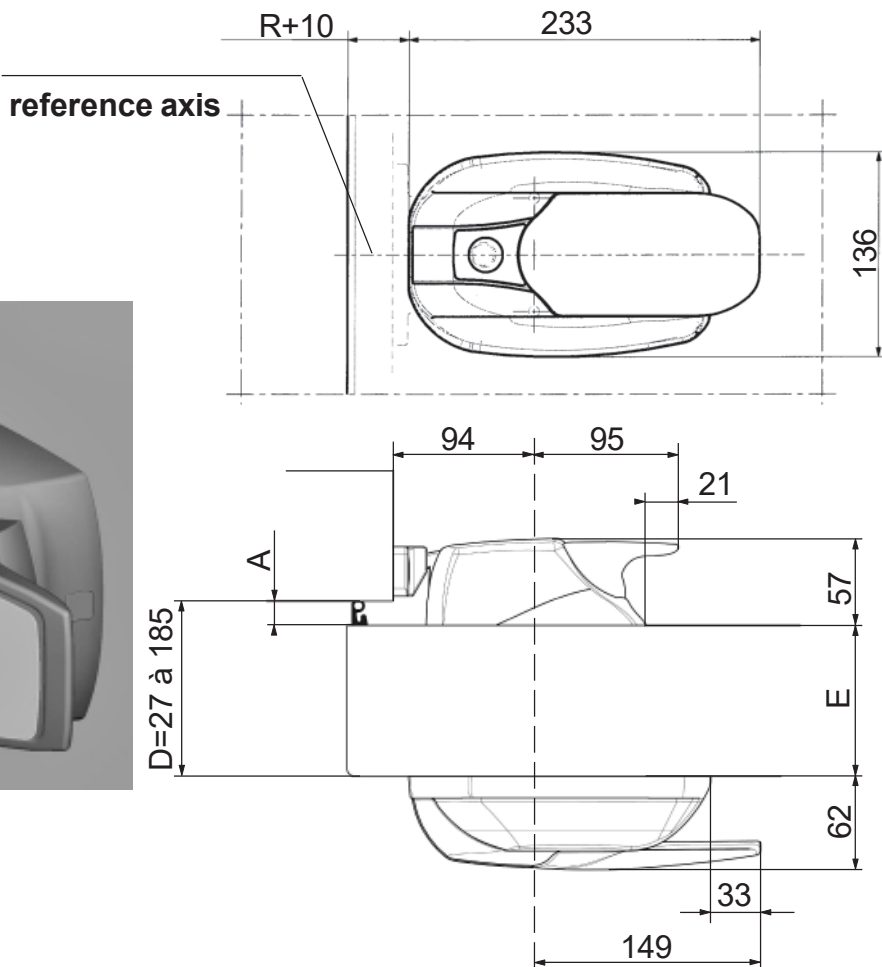
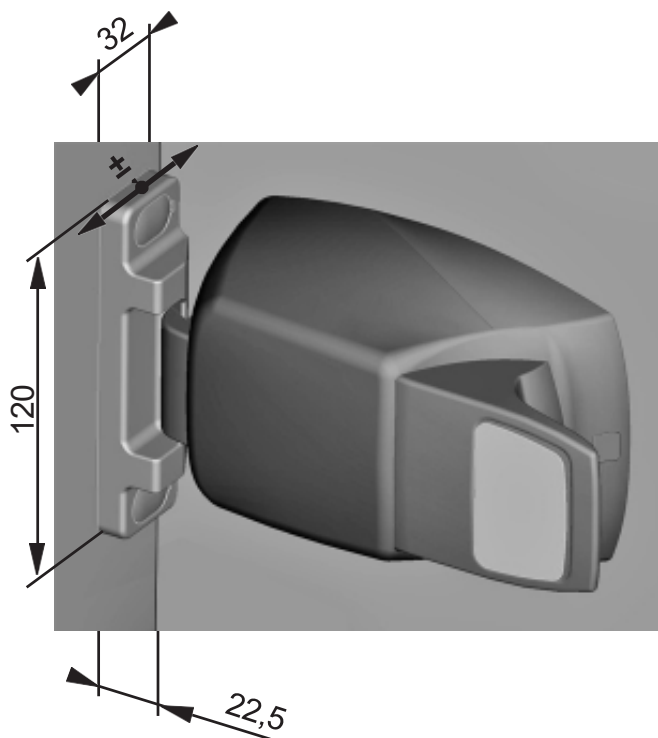

Ref.	430	431
weight	1000g	1130g
screws qty	6	6
screws diameter	5mm	5mm

E= door thickness (40 mm to 165 mm)
D= Door offset + compressed gasket
A= Compressed gasket ≤ 20 mm

2 - FEATURES

This fastener is designated to hinged inset or overlapping doors.
It is made of an external part (with or without lock) and internal part.

- 430 : standard version
- 431 : locking version
- Door thickness : 40mm to 165mm
- gasket thickness : 10mm to 20mm
- Adjustable strike : in depth and vertically
- invisible and inaccessible pins and fixations
- Interchangeable for right or left hand doors
- Lever, external housing and strike made of composite
- Mechanism : steel zinc bichromated

3 - TRANSPORT

This equipment must be protected from bad weather during transport .
The original packing is designed for all types of transportation means.
The liability of FERMOD ceases :

- as soon as the customer or installer opens the package or a part of the packaging
- as soon as the package has suffered a considerable impact in such a way that is damaged.

4 - STORAGE

This equipment must be protected from the bad weather during storage.

5 - MOUNTING

Please respect the regulations in force in the country of installation.
Please follow all the mounting instructions.

5-1 Door drilling

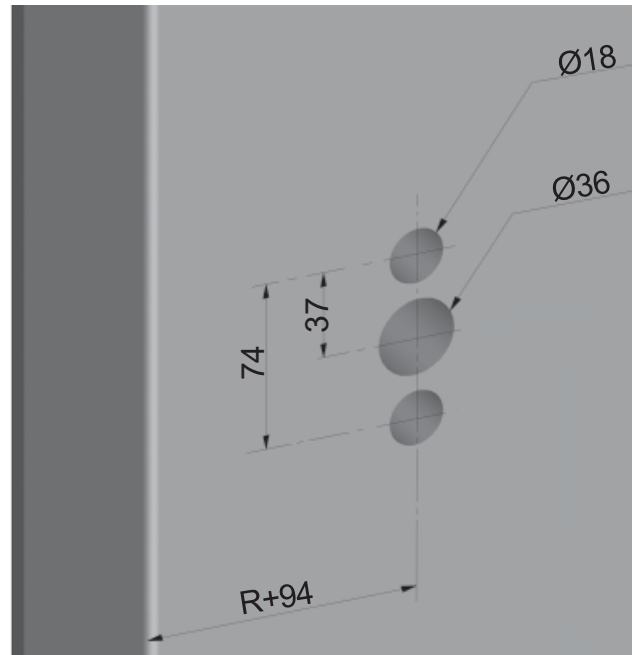
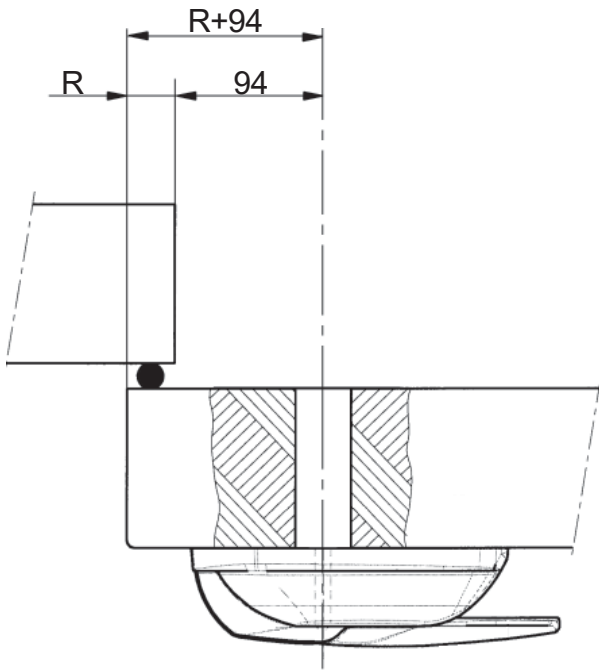

5-2 Rod and insulated sleeves cutting



Standard parts length for doors of 60, 66, 115 and 165 mm thickness (no cut required)

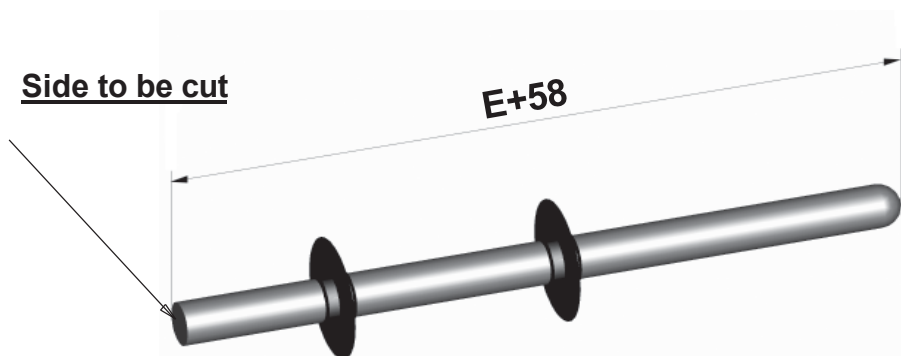
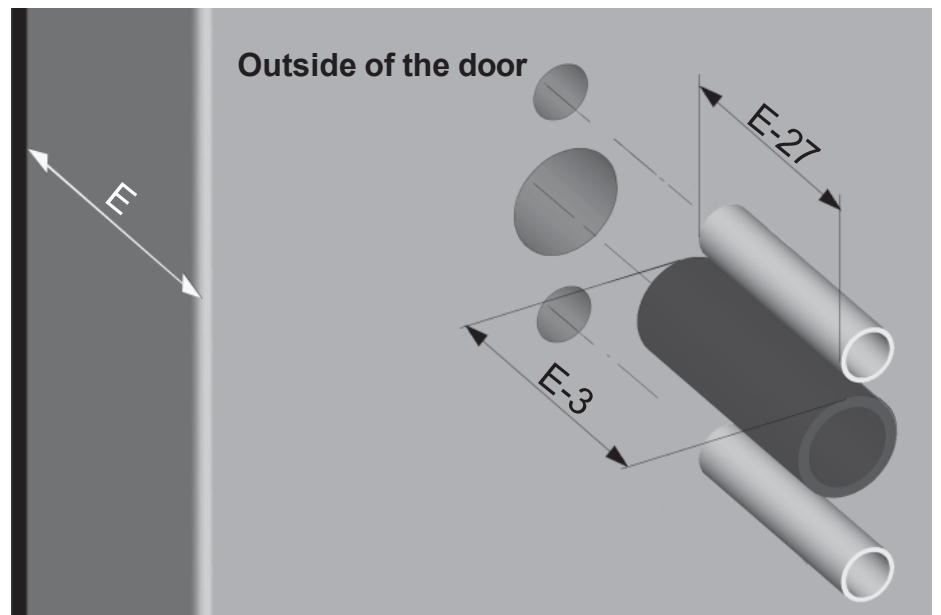

5-3 Assemblage - Assembly

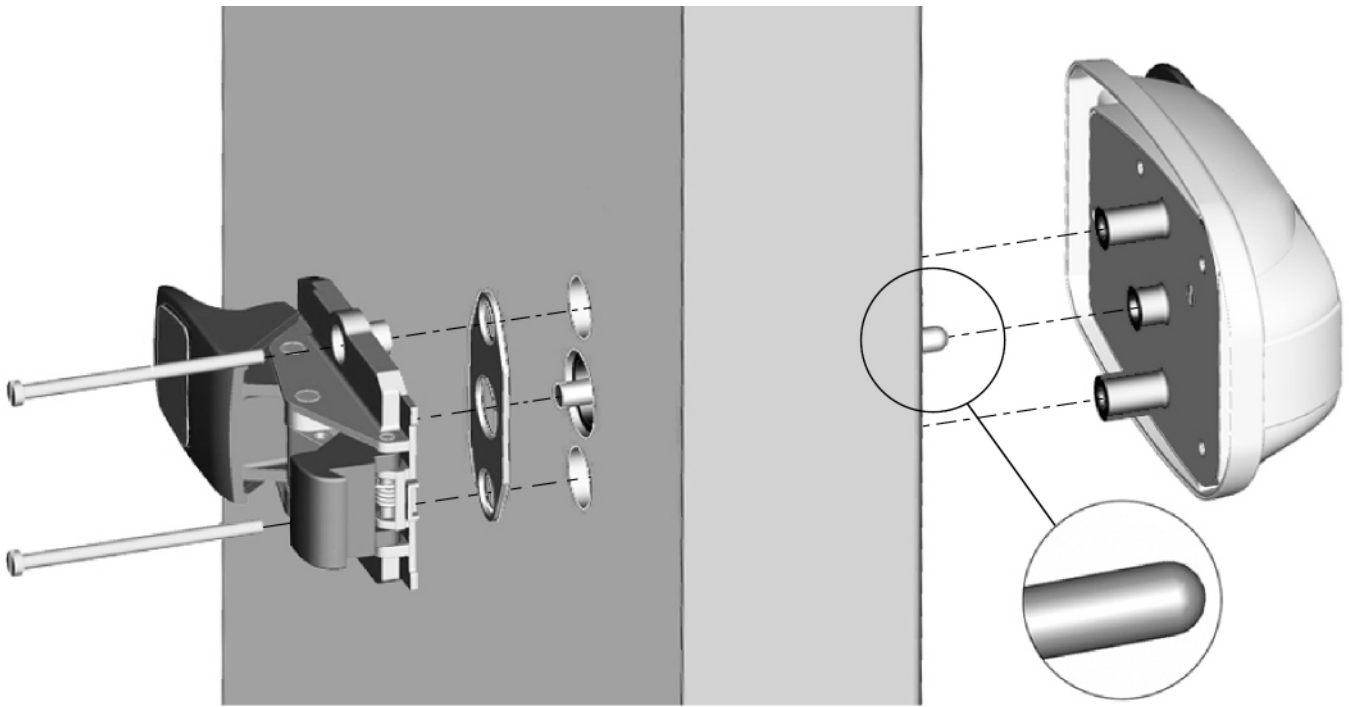

5-4 Drilling and assembly strike

**Pre-tighten screws
then tighten only half-turn
or
use max torque. 5 Nm with an
automatic screw-driver**

Reference axis

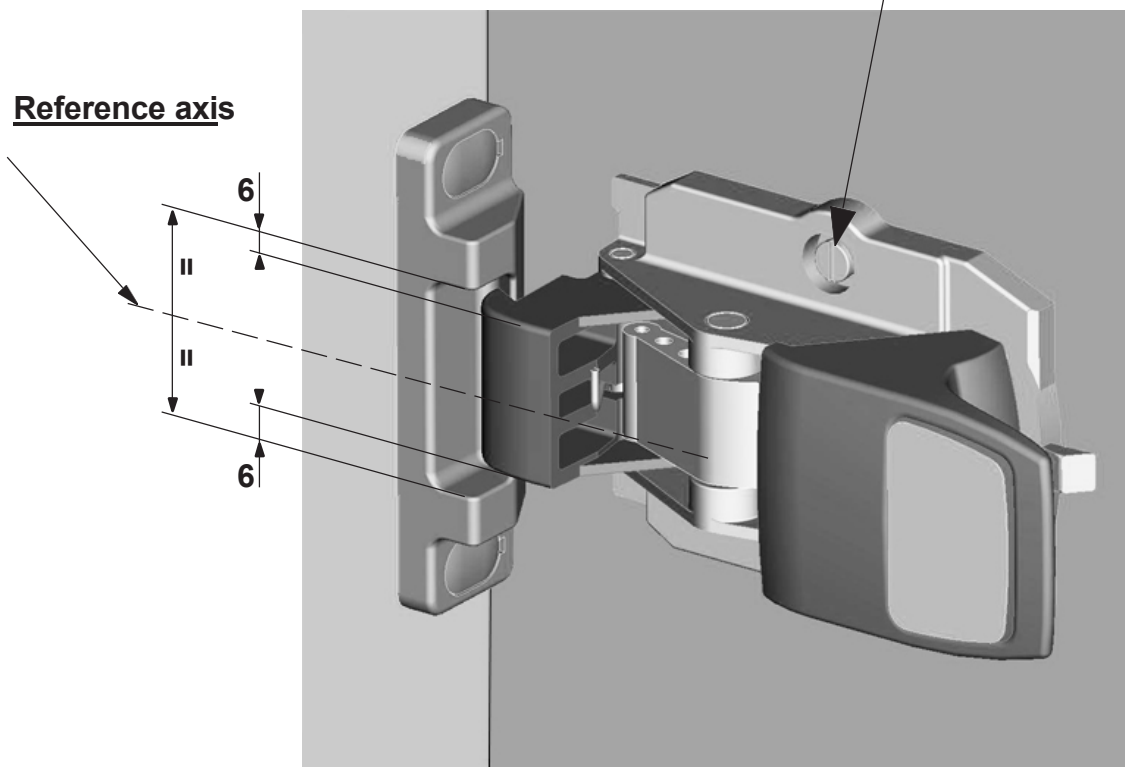

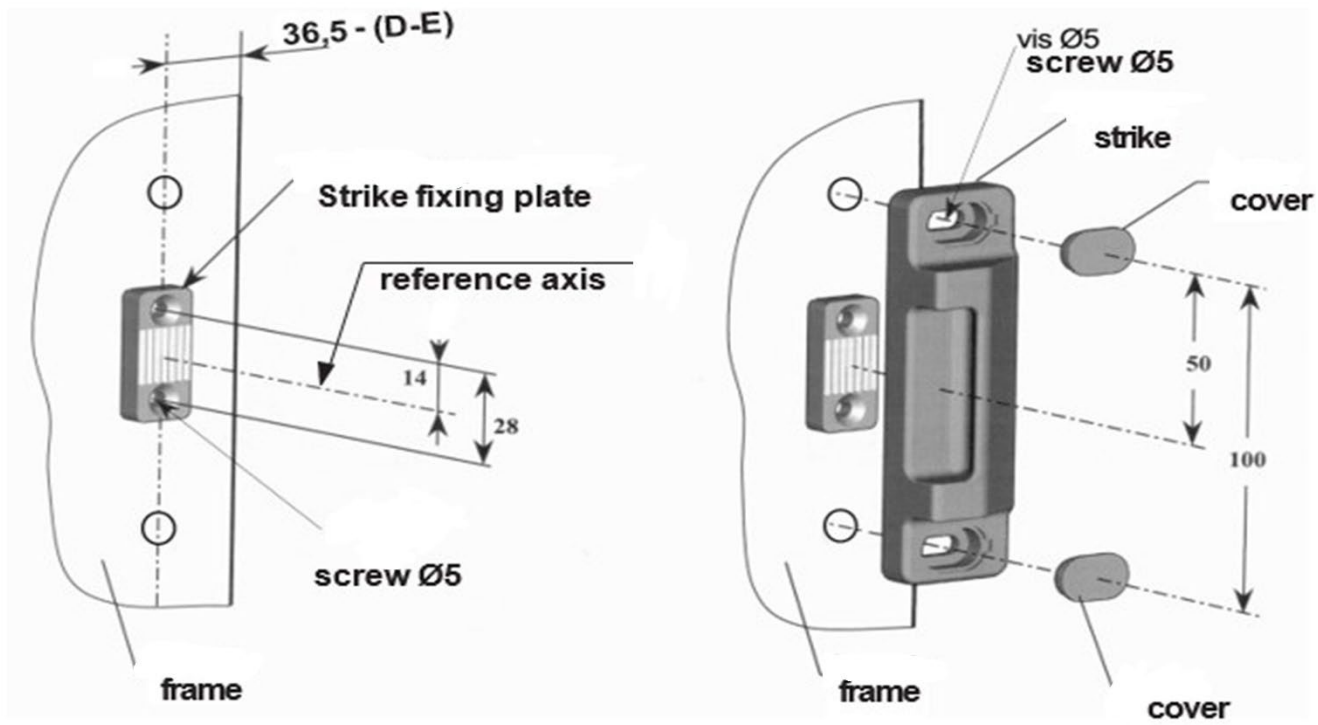

D= Door offset + compressed gasket
 E= door thickness (40 mm to 165 mm)

5-5 Cover mounting/dismounting

Mounting

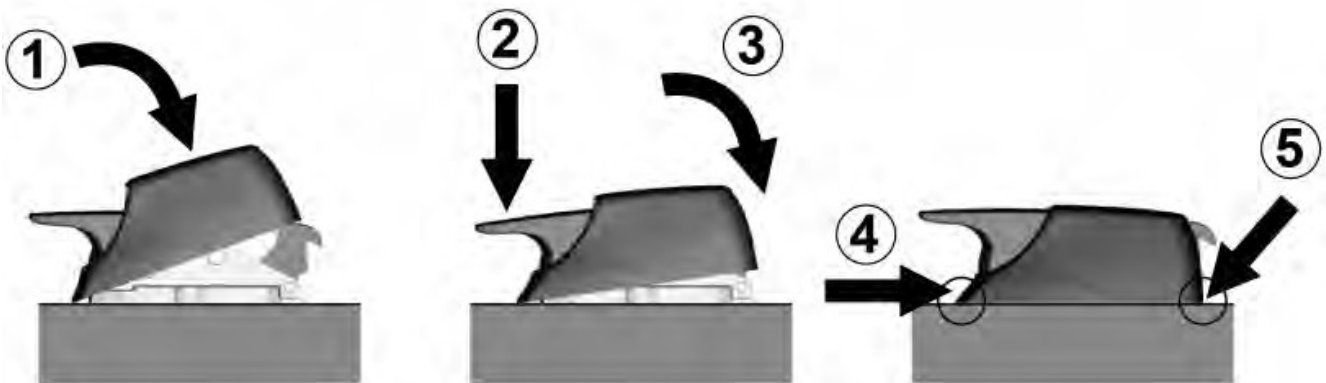

Dismounting

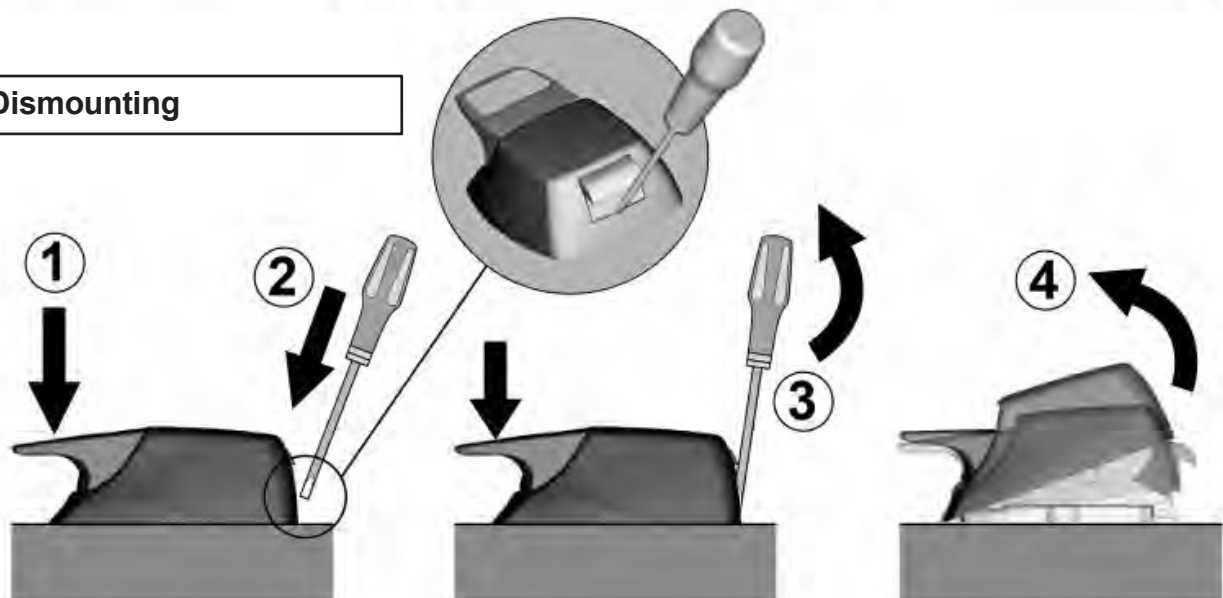

6 - SCRAPPING

Take all the European and national regulation texts into consideration, which deal with scrap and packaging waste. Examples: **Directive relating to scrapping, 75/442/CEE.**

Scrapping of the following items required dismounting and waste to a special center .

These materials here above give off harmful vapors during combustion.

Reference

EXTERNAL COVER

ROD

7 - ATTESTATION OF CONFORMITY CE

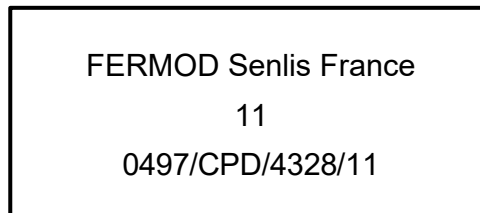
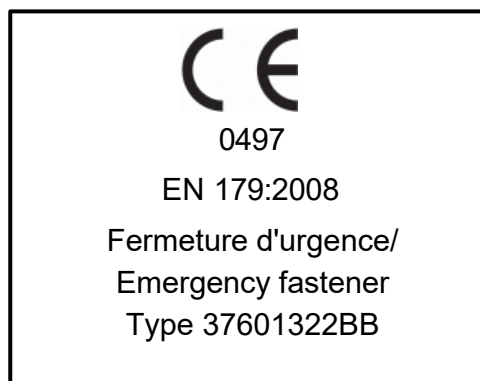

Xavier HAAS
Directeur Général Délégué



FERMOD®



75, rue de Richelieu - 75002 PARIS - FRANCE
Tél. :(33) 01 42 96 94 06 - Fax :(33) 01 42 86 84 51
<http://www.fermod.com> - e-mail : contact@fermod.com

Siège Social : Senlis (Oise) - Société Anonyme au capital de 1 004 400 Euros
RCS Compiègne B 301 468 211 - Siret 301 468 211 00018 - APE 2572 Z

CSI
11/01/11 Bullato MI 1
V.d.l., L.:iml.idr(jrd 20
1...1Ji.)02383301
-a; +37/02 503940
Vw.,r-Spd.COlf



Registration number

0497/CPD/4328/11

EC CERTIFICATE of CONFORMITY

In compliance with Council Directive 89/106/EEC of 21 December 1988 on the approximation of laws, regulations and administrative provisions of the Member States relating to construction products (the Construction Products Directive or CPD), as amended by the Directive 93/68/EEC of the Council of European Communities of 22 July 1993, it has been stated that the construction product

EMERGENCY DEVICE FOR REFRIGERATED DOORS OPERATED BY A PUSH PAD NAMED "430-431"

placed on the market by

FERMOD S.A. - 3, Av. Eugene Gazeau - 60300 SENLIS - FRANCE

and produced in the factory

FERMOD S.A. - 3, Av. Eugene Gazeau - 60300 SENLIS - FRANCE

is submitted by the manufacturer to a factory production control and to the further testing of samples taken at the factory in accordance with a prescribed test plan and that the notified body **CSI SPA** has performed the initial type-testing for the relevant characteristics of the product, the notified body CSI S.p.A. the initial inspection of the factory and of the factory production control and performs the continuous surveillance, assessment and approval of the factory production control.

This certificate attests that all provisions concerning the attestation of conformity and the performances described in Annex ZA of the standard **EN 179:2008** were applied and that the product fulfils all the prescribed requirements.

The product classification is the following:

3	7	6	0	3	2	2		B	B
---	---	---	---	---	---	---	--	---	---

This certificate was first issued on **17/10/2011** and remains valid as long as the conditions laid down in the technical specification in reference or the manufacturing conditions in the factory or the factory production control itself are not modified significantly.

Bollate, 05/12/2011

Rev. 1