

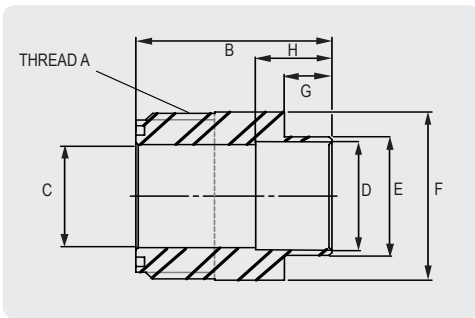

Rotalock Teflon Gasket

Part No.	Description	Pk Q'ty
800-26XX-12	Suit 3/4" R/L Nut	10
800-26XX-16	Suit 1" R/L Nut	5
800-26XX-20	Suit 1-1/4" R/L Nut	5
800-26XX-28	Suit 1-3/4" R/L Nut	5
800-26XX-36	Suit 2-1/4" R/L Nut	5



Rotalock Welding Spuds - Available as ASME - Female ID Weld to Male Rotalock Thread

Part No.	Description	Thread (Inch) A	Dimensions (mm)							Nominal Weight (kg)
			Overall Length B	I.D. C	I.D. D	O.D. E	Welded End O.D. F	Length G	Depth H	
965-26XX-12S	Suit 3/4 Rotalock	3/4-16 UNF	34	7.9	7.9	11.1	19.1	6	-	0.04
965-26XX-16S	Suit 1 Rotalock	1-14 UN	36	12.7	12.7	15.9	25.4	6	-	0.09
965-26XX-20S	Suit 1 1/4 Rotalock	1-1/4-12 UNF	38	19.0	19.0	22.2	31.8	8	-	0.09
965-26XX-28S	Suit 1 3/4 Rotalock	1-3/4-12 UN	38	31.75	34.9	38.1	44.5	8	15	0.18
965-26XX-36S	Suit 2 1/4 Rotalock	2-1/4-12 UN	39	41.3	41.3	47.6	57.2	8	-	0.27

Recommended Torque settings for Rotalock Nuts

Rotalock Nut Size	Torque (Nm)
Rotalock 3/4-16 UNF	40-50
Rotalock 1-14 UNS	70-80
Rotalock 1-1/4-12 UNF	120-135
Rotalock 1-3/4-12 UNF	135-160
Rotalock 2-1/4-12 UNF	165-190