

Introduction

Heldon packless line valves (Diaphragm Valves) are used to isolate an individual line, component or part of refrigeration or air-conditioning system. They are engineered to offer both long life and precise sealing making them the ideal choice as a long term positive isolation valve.

Heldon packless line valves feature a forged brass body with maximised port sizes for a greater flow and lower pressure drop. Three stainless steel diaphragms separate the stem from the seat ensuring the valve's longevity and preventing leakage during the life of the valve.

The valve seat is made from a polyamide nylon ensuring a complete shut off with minimal pressure applied.

Suitable for all fluorinated refrigerants they are available in two distinct designs. Standard for medium duty, and Heavy Duty for applications that require high usage and greater flow rate as well as being fully serviceable. Service kits are available as a standard part for the Heavy Duty valves.

Heldon also manufacture a three way version of the heavy duty valve, the branch is able to be isolated while the flow always continues across the straight connections.

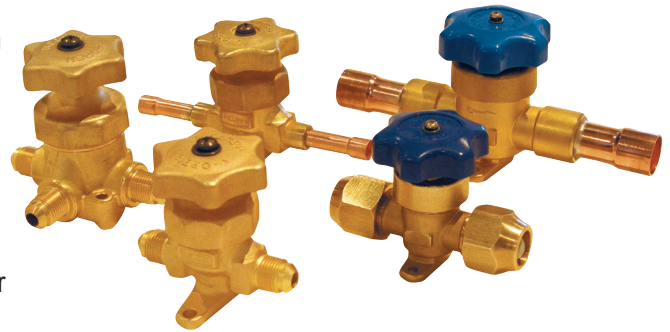

Features

Designed for maximum flow and minimal pressure drop.

Solid copper extended connectors.

Three stainless steel diaphragms.

Integral mounting bracket.

Available in two versions, Standard (Brass and Plastic handles) and Heavy duty (Brass handle only).

Safe working pressure of 4,200 kpa (R-410a compatible)

Polyamide nylon valve spindle seat.

Compatible with all fluorinated refrigerants and Oils.
Complete shut off with minimal torque.

Standards

Manufactured in accordance with AS / NZ 1677.2

Safe Working Pressure: 4,200 kPa

Heavy Duty Packless Line Valves

Con	Male SAE	A	B	C	Kv m3/Hr
1/4	2100-0404	75	51	77	0.26
3/8	2100-0606	76	51	79	0.90
1/2	2100-0808	90	54	98	1.98
5/8	2100-1010	90	54	97	2.80
3/4	2100-1212	119	64	121	4.75

Con	Solder/Ext	A	B	C	Kv m3/Hr
1/4	2111-0404	75	134	50	0.26
3/8	2111-0606	75	141	50	0.90
1/2	2111-0808	89	148	53	1.98
5/8	2111-1010	89	165	53	2.80
3/4	2111-1212	92	170	55	4.75
7/8	2111-1414	107	285	62	5.00

Heavy Duty Three-Way Packless Line valve

Con	Male SAE	A	C	Kv m3/Hr
1/4	2120-040404	89	40	0.26
3/8	2120-060606	89	40	0.90
1/2	2120-080808	89	40	1.98
5/8	2120-101010	86	40	2.80

Medium Duty Packless Line Valves "E Series" (Brass Handle)

Con	Male SAE	A	B	C	Kv m3/Hr
1/4	2100E-0404	75	51	77	0.25
3/8	2100E-0606	76	51	79	0.80
1/2	2100E-0808	90	54	98	1.50
5/8	2100E-1010	90	54	97	2.20
3/4	2100E-1212	119	64	121	2.90

Con	Solder/Ext	A	B	C	Kv m3/Hr
1/4	2111E-0404	65	120	35	0.25
3/8	2111E-0606	73	130	38	0.80
1/2	2111E-0808	73	140	38	1.50
5/8	2111E-1010	73	162	38	2.20
3/4	2111E-1212	86	170	50	2.90

Medium Duty Packless Line Valves "B Series" (Plastic Handle)

Con	Male SAE	A	B	C	Kv m3/Hr
1/4	2100B-0404	60	58	35	0.25
3/8	2100B-0606	68	73	38	0.80
1/2	2100B-0808	68	78	38	1.50
5/8	2100B-1010	68	80	38	2.20
3/4	2100B-1212	80	97	50	2.90

Con	Solder/Ext	A	B	C	Kv m3/Hr
1/4	2111B-0404	60	120	35	0.25
3/8	2111B-0606	68	130	38	0.80
1/2	2111B-0808	68	140	38	1.50
5/8	2111B-1010	68	162	38	2.20
3/4	2111B-1212	80	170	50	2.90

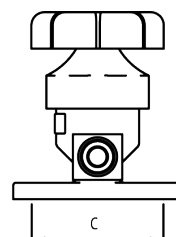
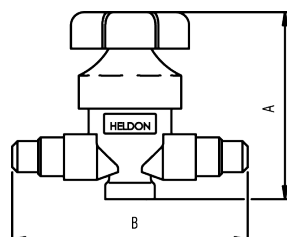
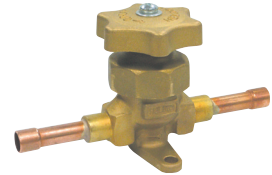

Packless Line Valves