

# Capped Line Valves

Henry Technologies Capped Line Valves are designed and manufactured for a multitude of uses in refrigeration and air-conditioning systems. These forged brass valves provide easy accessibility, serviceability and isolation. Most of this range has been manufactured by Henry Tech for over 50 years and have a reputation second to none in pressure critical environments.

The valves use a forged brass body with polished stainless steel spindle. The gland sealing utilises the double O-Ring seal on selected models or Teflon gland rings as standard. The double O-Ring style is fully serviceable.

Suitable for all fluorinated refrigerants they are available in a number of configurations to suit most applications including right angle, (offset) straight through, with or without mounting foot and back seating.

**Features**

- Designed for maximum flow and minimal pressure drop.
- Strong forged brass or solid brass body.
- Precision ground and polished stainless steel stem.
- Integral foot mount mounting bracket.
- Available in a multitude of configurations.
- Safe Working Pressure of 4,200 kPa (R410A compatible).
- Stainless steel stem on swivel models.

**Benefits**

- Negligible loss in system efficiency.
- Stable platform when mounted in a system.
- Accurate sealing and extended life.
- Easy installation.
- Suit most applications.
- Compatible with all fluorinated refrigerants and oils.
- Stronger and less susceptible to fatigue failure.

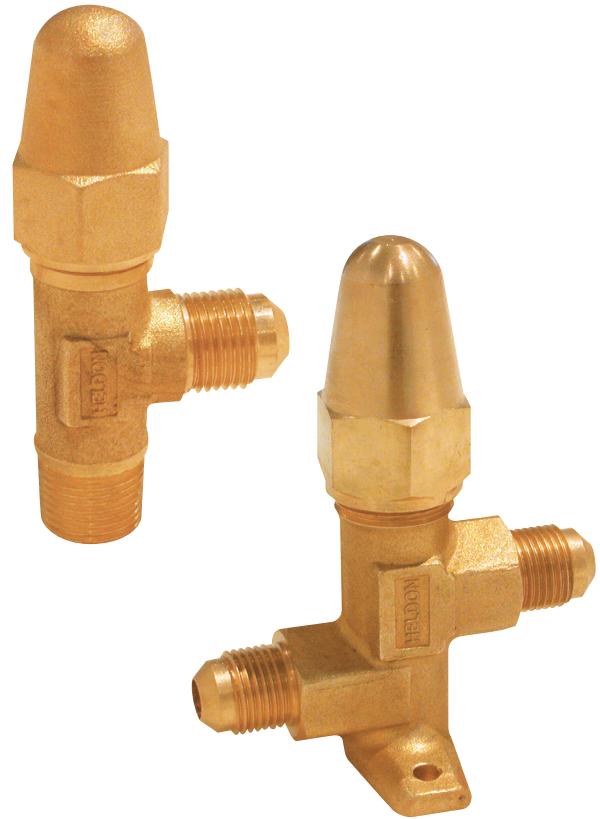

**Manufacturing Standards**

Manufactured in accordance with AS/NZS 1677.2  
Safe Working Pressure: 4,200 kPa

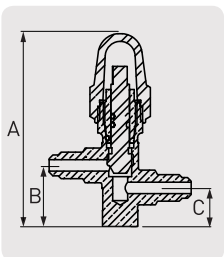

**In-line foot mount - Male SAE Flare**

Part No.	Conn Size (inch)	Dimensions (mm)			Weight (kg)
		A	B	C	
2220-0404	1/4 MSAE	80	25	16	0.20
2220-0606	3/8 MSAE	100	35	17	0.37
2220-0808	1/2 MSAE	102	35	19	0.38

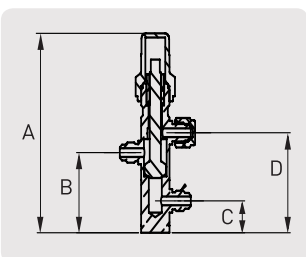

**In-line foot mount with access (Front & Back seats) - Male SAE Flare**

Part No.	Conn Size (inch)	Dimensions (mm)				Weight (kg)
		A	B	C	D	
2225-0606	3/8 MSAE	110	44	18	55	0.29

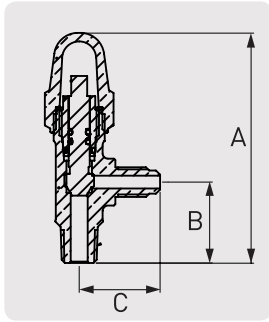

<b>(Angle) Male SAE Side to Male BSP Bottom</b>						
Part No.	Description	Dimensions (mm)			Weight (kg)	
		A	B	C		
2201-0404	1/4 MSAE x 1/4 MBSP	86	30	30	0.17	
2201-0406	1/4 MSAE x 3/8 MBSP	86	30	30	0.17	
2201-0408	1/4 MSAE x 1/2 MBSP	104	35	34	0.30	
2201-0604	3/8 MSAE x 1/4 MBSP	86	30	30	0.18	
2201-0606	3/8 MSAE x 3/8 MBSP	86	30	30	0.18	
2201-0608	3/8 MSAE x 1/2 MBSP	104	35	37	0.31	
2201-0806	1/2 MSAE x 3/8 MBSP	104	35	35	0.30	
2201-0808	1/2 MSAE x 1/2 MBSP	104	35	35	0.31	
2201-1008	5/8 MSAE x 1/2 MBSP	104	35	35	0.31	
2201-1012	5/8 MSAE x 3/4 MBSP	122	43	39	0.41	

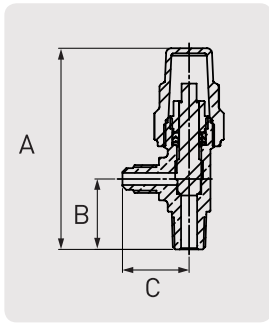

<b>Male SAE Side to Male Taper NPT Bottom</b>						
Part No.	Description	Dimensions (mm)			Weight (kg)	
		A	B	C		
2202-0606	3/8 MSAE x 3/8 MNPT	80	28	29	0.18	

Male SAE Flare to Female Solder

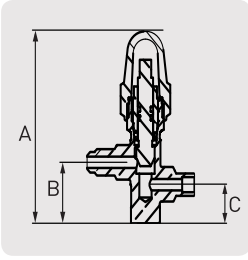

Part No.	Description	Dimensions (mm)			Weight (kg)
		A	B	C	
2227-0404A1	1/4 ID (lwr port) x 1/4 MSAE	80	25	16	0.19
2227-0606A1	3/8 ID (lwr port) x 3/8 MSAE	100	34	16	0.37

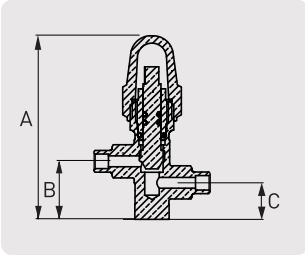

Part No.	Description	Dimensions (mm)			Weight (kg)
		A	B	C	
2230-0404	1/4 ID	80	25	18	0.19
2230-0606	3/8 ID	101	34	18	0.34
2230-0808	1/4 ID	100	34	18	0.33
2230-1010	5/8 ID	116	42	22	0.44
2230-1212	3/4 ID	116	42	22	0.46

Female Solder - Foot Mount

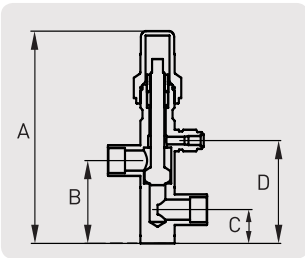

Part No.	Description	Dimensions (mm)				Weight (kg)
		A	B	C	D	
2235-0606	3/8 ID	110	44	18	55	0.29
2235-0808C	1/2 ID	114	44	18	54	0.30
2235-1010C	5/8 ID	114	44	18	54	0.31

Female Solder - Threaded Base

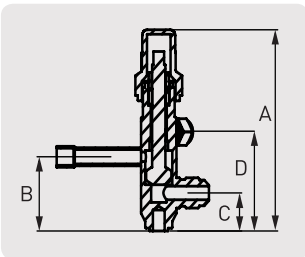

Part No.	Description	Dimensions (mm)				Weight (kg)
		A	B	C	D	
2254-0404	1/4 ID x 1/4 MSAE - Hex Base Mount c/w Access	110	41	22	52	0.20
2254-0606	3/8 ID x 3/8 MSAE - Hex Base Mount c/w Access	114	41	22	52	0.22