

Moisture Indicators

Liquid Moisture Indicators are used in refrigeration and air conditioning systems as a means of visually checking refrigerant quality and quantity.

This moisture indicator is particularly important with HFC refrigerants using POE oil due to the hygroscopic nature of the POE oil. The combination of HFC refrigerants and the potential moisture present in the POE oil can result in the formation of undesirable acids and alcohol which can be detrimental to the refrigeration and air-conditioning system. They are also ideally suited for installation in the oil return line between the oil separator and the compressor.

The Henry moisture indicator features a hermetically sealed glass, a large diameter viewing window and highly visible moisture indicator.

The Henry moisture indicator is machined from forged brass and the glass is hermetically sealed into the housing incorporating a double seal design to provide a superior seal on the glass and a longer service life.

Suitable for liquid, suction and oil lines with all fluorinated refrigerants and oils up to 4,200 kPa Safe Working Pressure.



Manufacturing Standards

Manufactured in accordance with AS/NZS 1677.2

Features

- Designed for maximum flow and minimal pressure drop.
- Solid forged brass construction.
- Solid copper extended connections. (Solder version)
- Suitable for all refrigerants up to 4,200 kPa (not NH₃).
- Large sight glass and indicator.
- Working range -40°C to 85°C .

Benefits

- Negligible lost in system efficiency.
- Strong stable platform.
- Easy installation and soldering.
- Compatible with most fluorinated refrigerants and oils.
- Better viewing angle and clarity.
- Suitable for a wide range of applications.
- Quick identification of flow and liquid quantity.

Dimensions and Capacities

Male SAE to Male SAE

| Part No. | Connection | Dimensions (mm) | | Weight (kg) |
|-----------|---------------------|-----------------|----|-------------|
| | | Lay-In Length | | |
| | | A | B | |
| 650-0404H | 1/4 MSAE x 1/4 MSAE | 72 | 27 | 0.55 |
| 650-0606H | 3/8 MSAE x 3/8 MSAE | 76 | 27 | 0.18 |
| 650-0808H | 1/2 MSAE x 1/2 MSAE | 83 | 34 | 0.23 |
| 650-1010H | 5/8 MSAE x 5/8 MSAE | 88 | 34 | 0.24 |

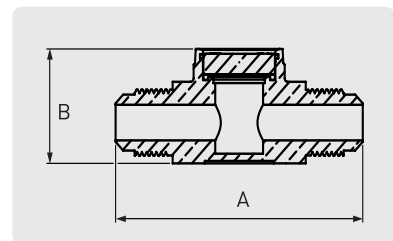

650H Series

Female Solder with Extended Copper Tails

| Part No. | Connection | Dimensions (mm) | | Weight (kg) |
|-----------|--------------------------------|-----------------|----|-------------|
| | | Lay-In Length A | | |
| | | A | B | |
| 665-0404H | 1/4 ID x 1/4 ID extended tails | 85 | 27 | 0.17 |
| 665-0606H | 3/8 ID x 3/8 ID extended tails | 99 | 27 | 0.18 |
| 665-0808H | 1/2 ID x 1/2 ID extended tails | 122 | 27 | 0.18 |
| 665-1010H | 5/8 ID x 5/8 ID extended tails | 116 | 33 | 0.24 |
| 665-1212H | 3/4 ID x 3/4 ID extended tails | 141 | 33 | 0.26 |

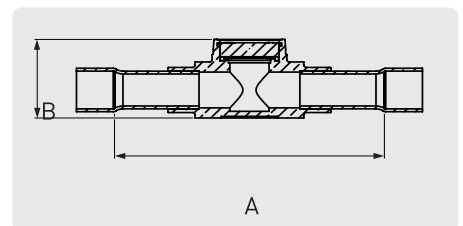

665H Series

Male SAE to Female SAE

| Part No. | Connection | Dimensions (mm) | | Weight (kg) |
|-----------|---------------------|-----------------|----|-------------|
| | | Lay-In Length A | B | |
| 655-0404H | 1/4 MSAE x 1/4 FSAE | 61 | 27 | 0.55 |
| 655-0606H | 3/8 MSAE x 3/8 FSAE | 76 | 33 | 0.18 |
| 655-0808H | 1/2 MSAE x 1/2 FSAE | 72 | 33 | 0.23 |

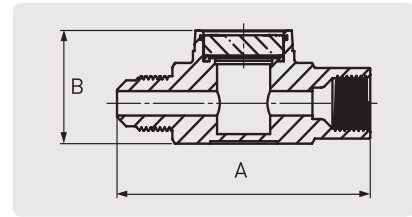

655 Series



Male SAE to Female SAE

| Part No. | Connection | Dimensions (mm) | | Weight (kg) |
|-----------|-------------------------|-----------------|----|-------------|
| | | Lay-In Length A | B | |
| 658-0404H | 1/4 MSAE x 1/4 F/Swivel | 77 | 27 | 0.17 |
| 658-0606H | 3/8 MSAE x 3/8 F/Swivel | 82 | 27 | 0.20 |
| 658-0808H | 1/2 MSAE x 1/2 F/Swivel | 88 | 33 | 0.25 |
| 658-1010H | 5/8 MSAE x 5/8 F/Swivel | 94 | 33 | 0.26 |

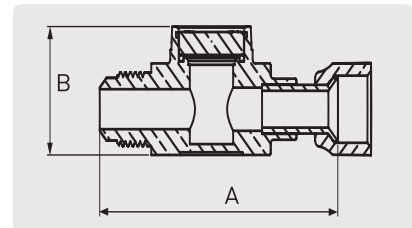

658 Series



Male SAE to Female SAE

| Part No. | Connection | Dimensions (mm) | | Weight (kg) |
|-----------|------------------------------|-----------------|----|-------------|
| | | Lay-In Length A | B | |
| 659-0404H | 1/4 ID SOLDER x 1/4 F/Swivel | 82 | 27 | 0.17 |
| 659-0606H | 3/8 ID SOLDER x 3/8 F/Swivel | 94 | 27 | 0.20 |
| 659-0808H | 1/2 ID SOLDER x 1/2 F/Swivel | 107 | 27 | 0.20 |
| 659-1010H | 5/8 ID SOLDER x 5/8 F/Swivel | 108 | 33 | 0.25 |

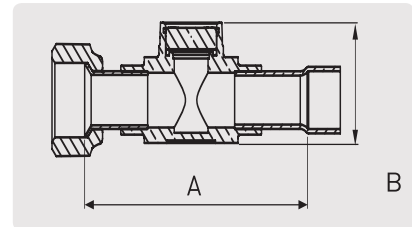

659 Series



Female Solder Single Port

| Part No. | Connection | Dimensions (mm) | | Weight (kg) |
|----------|-----------------|-----------------|----|-------------|
| | | Lay-In Length A | B | |
| 670-1414 | 7/8 ID Solder | 122 | 24 | 0.22 |
| 670-1818 | 1 1/8 ID Solder | 114 | 24 | 0.29 |
| 670-2222 | 1 3/8 ID Solder | 151 | 24 | 0.49 |
| 670-2626 | 1 5/8 ID Solder | 145 | 24 | 0.51 |
| 670-3434 | 2 1/8 ID Solder | 132 | 24 | 0.74 |

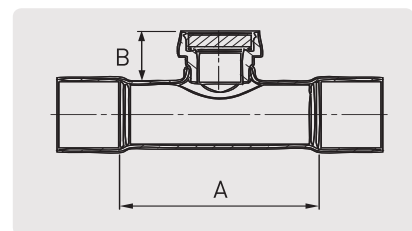

670 Series



Female Solder Dual Port

| Part No. | Connection | Dimensions | | Weight (kg) |
|----------|-----------------|-----------------|-----|-------------|
| | | Lay-In Length A | B | |
| 675-1414 | 7/8 ID Solder | 122 | 72 | 0.41 |
| 675-1818 | 1 1/8 ID Solder | 114 | 78 | 0.44 |
| 675-2222 | 1 3/8 ID Solder | 151 | 84 | 0.50 |
| 675-2626 | 1 5/8 ID Solder | 145 | 91 | 0.88 |
| 675-3434 | 2 1/8 ID Solder | 132 | 104 | 0.65 |

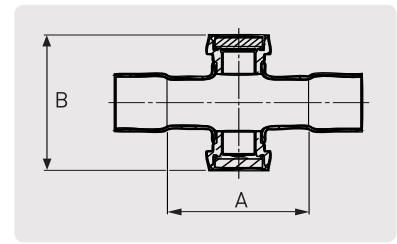

675 Series

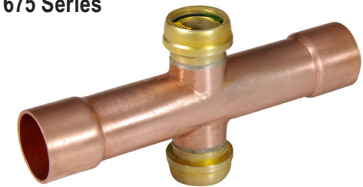

Moisture Content vs Colour Change

| Indication (ppm of water) Liquid Temperature (°C) | Dry (Green) | | | Caution (Light Green) | | | Wet (Yellow) | | |
|--|-------------|-----|--------|-----------------------|--------|--------|--------------|------|------|
| | 25 | 40 | 50 | 25 | 40 | 50 | 25 | 40 | 50 |
| R12 | <5 | <5 | <5 | 5-25 | 5-40 | 5-70 | >25 | >40 | >70 |
| R134a (<20) | <35 | <60 | 20-130 | 35-160 | 60-200 | >130 | >160 | >200 | - |
| R22 | <25 | <35 | <50 | 25-145 | 35-200 | 50-290 | >145 | >200 | >290 |
| R407C(<25) | <40 | <60 | 25-150 | 40-230 | 60-360 | >150 | >230 | >360 | - |
| R410A(<30) | <60 | <75 | 30-170 | 60-280 | 75-420 | >170 | >280 | >420 | - |
| R404A/507 (<15) | <25 | <45 | 15-120 | 25-150 | 45-180 | >120 | >150 | >180 | - |
| R502 | <5 | <5 | <10 | 5-50 | 5-90 | 10-150 | >50 | >90 | >150 |